



*We endeavour to supply  
best valued machines.*

**MASTERPAC GMBH. (Headquarter)**

Gewerbering 3. 48734 Reken. Germany

TEL. 49(0) 2864 94164

FAX. 49(0) 2864 94165

E-mail: [sales@masterpac.eu](mailto:sales@masterpac.eu)

**MASTERPAC INTERNATIONAL**

Z.A.C du trou grillion

P.O. Box 38. 91280 St. PIERRE DU PERRY. FRANCE

TEL. +33-6-12-70-02-63

E-mail: [intlsales@masterpac.eu](mailto:intlsales@masterpac.eu)

**MASTERPAC ASIA**

Weisi Road. Baohe Industrial Estate. Hefei 230051. CHINA

Tel. 86-551-4846601 4846580

Fax. 86-551-4846616 4846626

E-mail: [sales@masterpac.eu](mailto:sales@masterpac.eu)

[www.masterpac.eu](http://www.masterpac.eu)





It is our responsibility as leaders in our field to ensure that people have the necessary resources at their disposal, to become well informed to make good decisions. It is the responsibility of leaders to be mentors by offering continuous feedback, recognition and realignment.



*Partnership*

**HONDA**<sup>™</sup>

**Robin**  
SUBARU

**LOMBARDINI**

**HATZ**  
DIESEL



## MASTERPAC, a Global Company.



MASTERPAC, with more than 10 years' experience has been manufacturing light construction equipment which has been backed and supported by experienced international staff who have worked in partnership with a network of dealers worldwide. This has resulted the drive that has delivered positive and sustainable change in every continent.

Today MASTERPAC is considered to be one of the most reliable and trustable companies in this industry. We are quickly establishing an appreciation amongst our customer base for excellence, quality and serviceability for MASTERPAC machines.

MASTERPAC's diverse product range and competitive pricing in compaction and concrete technology fields ensures high sales volume sales in the global markets.

## Guiding Principle

Trustworthy

**MASTERPAC®**  
Professional Compaction

Customer-Orientated

Quality

Flexible

Creative

### Trustworthy

Integrity is our main Principle.

### Customer-orientated

We recognize culture diversity existing in different nations. Our focus is to provide the right machinery applications and the right service to satisfy demand to our wide spread customer base. At MASTERPAC, our common saying is "we endeavour to create the best value for customers".

### Quality

Is an important criteria in our operation as we carefully monitor and evaluate all product design, component purchasing, product manufacturing, customer training, warranty administration, and customer service is all to our high standards.

### Flexible

Our flexible management team at MASTERPAC responds quickly to our ever changing market and is tuned to satisfy customer demand.

### Creative

We are constantly researching and evaluating new products that will strive to satisfy new markets and deliver the edge over our competition.





# Research & Development



Masterpac's commitment to our customer base is to create value for money and each new product project undertaken is primarily driven to provide significant progress in terms of improved productivity, reduced maintenance, long life, enhanced user safety operation.

MASTERPAC products are designed and built to extend product life expectations.

## How MASTERPAC develop a new product?

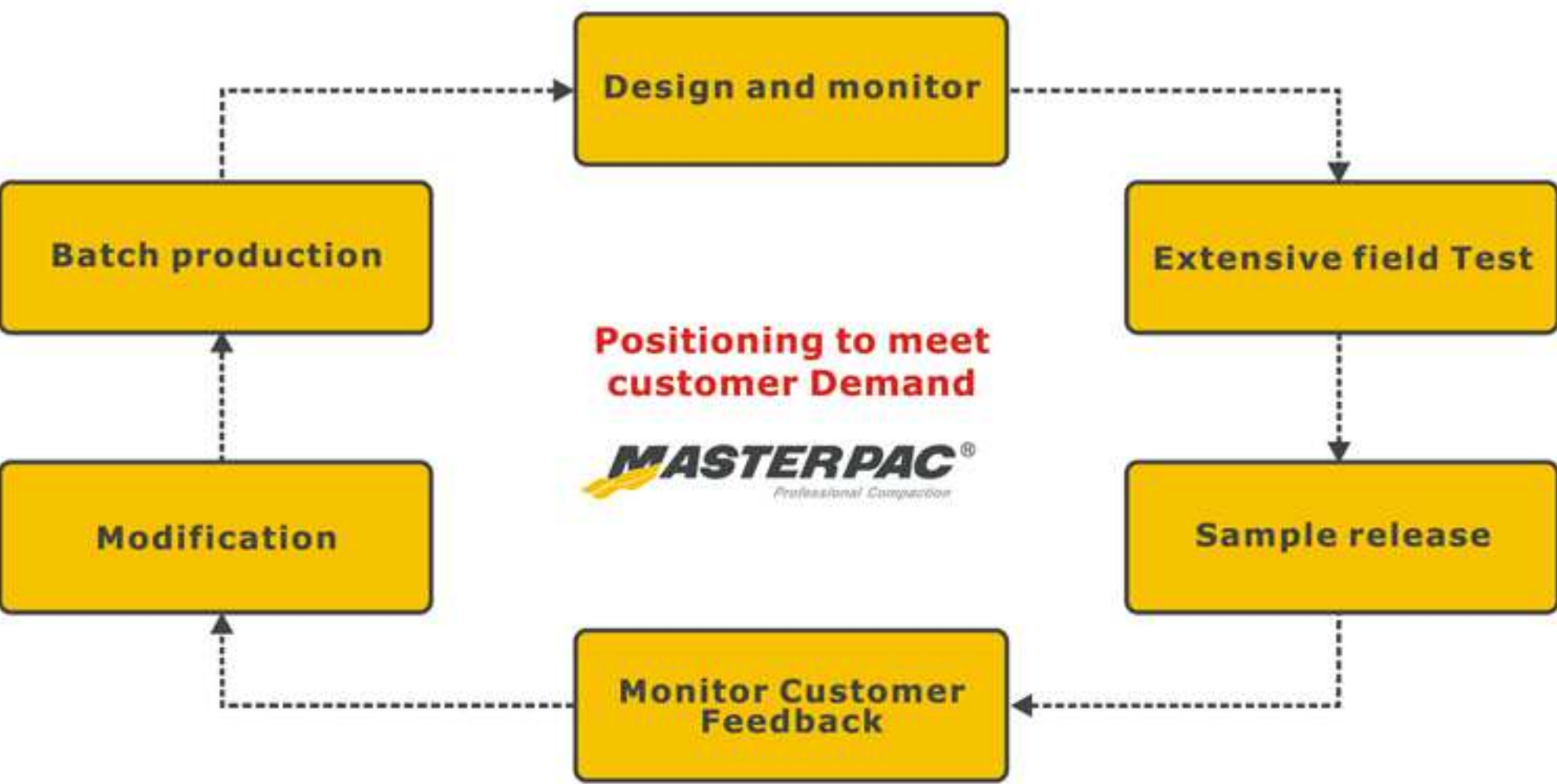

# Quality Control

Throughout the product development cycle MASTERPAC qualified engineers carefully monitor product performance and monitor customer concerns individually and record all findings for future reference for design improvements.

**Secured ISO9001 certification thus ensuring quality control during every production process.**



**MASTERPAC guarantees the quality of its own factory manufactured components for its final products assembly.**

**MASTERPAC each product is bench tested prior to release.**

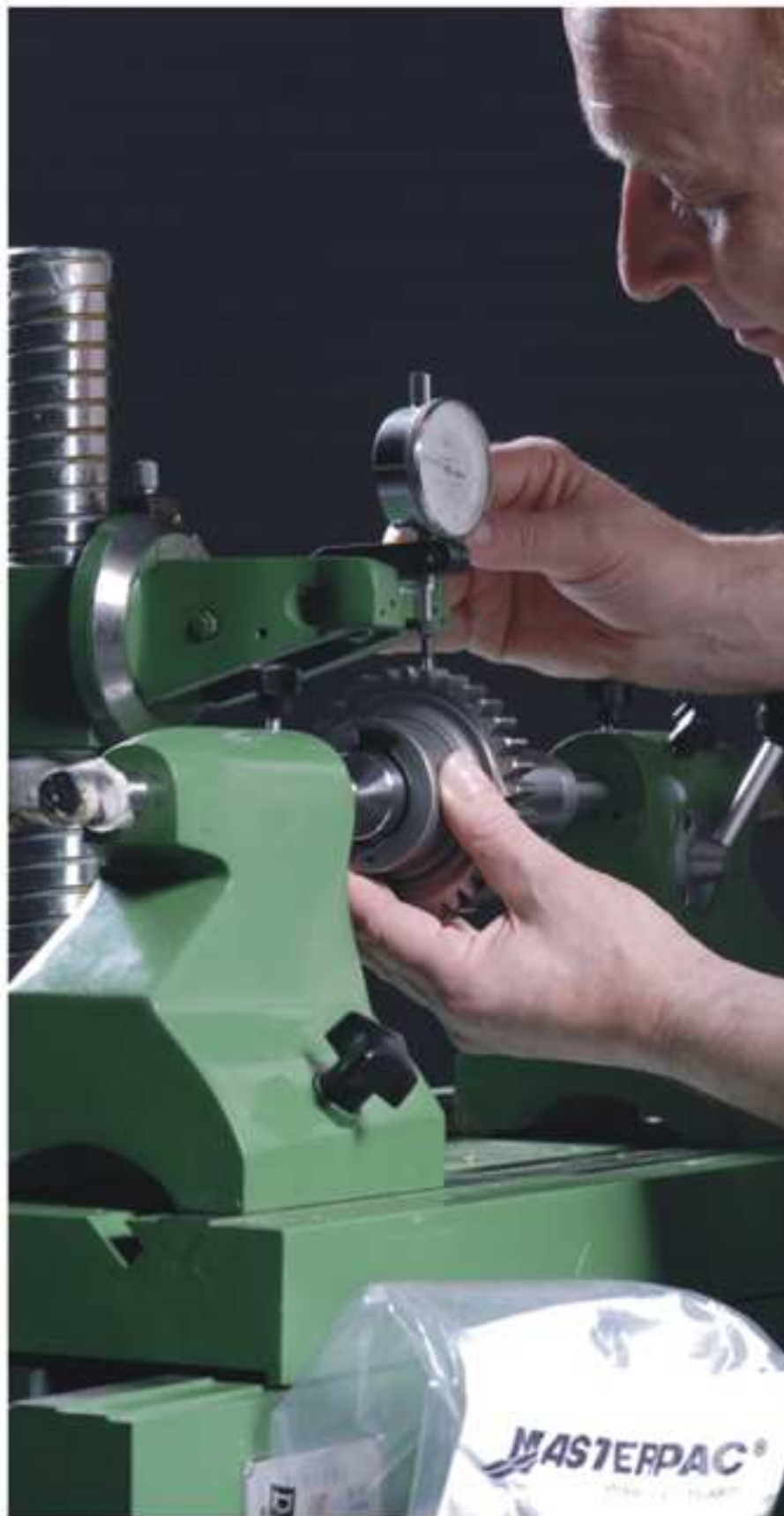



# Sales

We strive to please our customer's request based on a solid understanding and position for our customers needs by carrying out daily operations in an efficient manner. Our sale of the machine is not the closing of the deal but the opening of a partnership.

We value our customers feedback and strive to meet their demand, with flexibility and efficient response.



It is through the strength of our global distribution partners that we are able to create such a worldwide success.



# Service



At MASTERPAC, we strive for operational excellence which is the underlining foundation for quality and efficiency, with a focus on standardized procedures, excellent customer service.

Our services extend beyond supplying products-we have developed an extensive network of added value and services from inventory management, training and procurement options. This results to our products offering.

- On-time and error-free delivery
- Accurate and efficient order processing
- Quick Response
- Reduced order cycle time
- Standardized process control
- Prompt parts supply

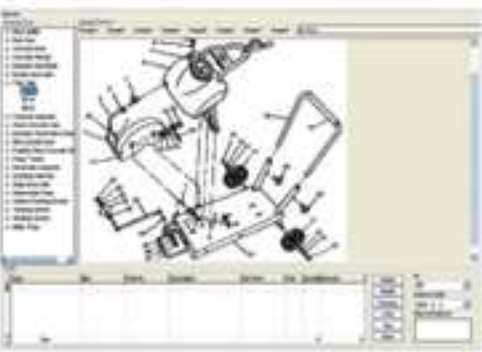

**Well-Tailored MASPART™ parts software system offers easy access and quick ordering of machine parts.**





## COMPACTION

### Tamping Rammer

PMR60H/PMR60R/PMR68H/PMR75R

**P13**

### Forward Plate Compactor

PC3008 Series/PC3610 Series/PC4012 Series  
PC4515 Series/PC5018 Series/PC5021 Series

**P19**

### Hydraulic Reversible Plate Compactor

PCR3820 Series/PCR4025 Series/PCR5030 Series  
PCR6040 Series/PCR6550 Series/PCR7060 Series

**P27**

### Single drum Vibratory Roller

SVR58 Series

**P37**

### Double Drum Vibratory Roller

DVR65 Series

**P41**

## CONCRETE FINISHING

### Vibrating Screed

PMD Series

**P51**

### Surface Finishing Screed

PCD Series

**P53**

### Pendulum Concrete Vibrator

**P55**

### Eccentric Concrete Vibrator

**P57**

### Edging Power Trowel

PMT24 Series/PMT30 Series

**P61**

### Walk-Behind Power Trowel

PMT36 Series/PMT42 Series/PMT46 Series

**P63**

### Ride-on Power Trowel

PRT73

**P67**

### Green Concrete Saw

PFG10 Series

**P75**

### Floor Saw

**P77**







Umbosintwini, South Africa, 10:15 am

**MASTERPAC**<sup>®</sup>  
Professional Compaction

## TAMPING RAMMER



PMR60H

60kg



PMR60R



PMR68H

68kg



PMR75R

75kg



# TAMPING RAMMER

## PMR60H/PMR60R/PMR68H/PMR75R

Masterpac four stroke rammers are perfectly balanced to deliver hard hitting compaction as well operator comfort delivering low noise and vibration to the operator.



## Features

- Reliable four stroke engine delivers low emission and noise.
- Ingenious throttle lever for smooth operation.
- Heavy shock mount system reduces hand-arm vibration and improve operator comfort.
- Durable Plastic oil tank offers longer life and rust-free.
- Laminated wood and steel shoe absorbs and withstands vibration shock.
- Protective top frame cover eliminates possible damage to the engine.
- Innovative engine side cover protects and guards recoil starter from particles.
- Convenient rollers for easy loading (PMR60H, PMR68H only).
- Perfectly balanced while delivering ideal compaction with controlled jumping motions without affecting the impact force.
- German manufactured polyurethane ribbed bellow for long life.
- Optional trolley kit for easy transportation.



Ingenious throttle lever for smooth operation.



Durable Plastic oil tank offers longer life and rust-free.



Innovative engine side cover protects and guards recoil starter from particles.



Heavy shock mount system reduces hand-arm vibration and improve operator comfort.



# TAMPING RAMMER

PMR60H/PMR60R/PMR68H/PMR75R

## Working Size (mm)

Model	A	B	C	D	E
PMR60H	1055	440	705	265	335
PMR60R	1060	335	710	265	335
PMR68H	1020	430	760	285	330
PMR75R	1020	430	760	285	330

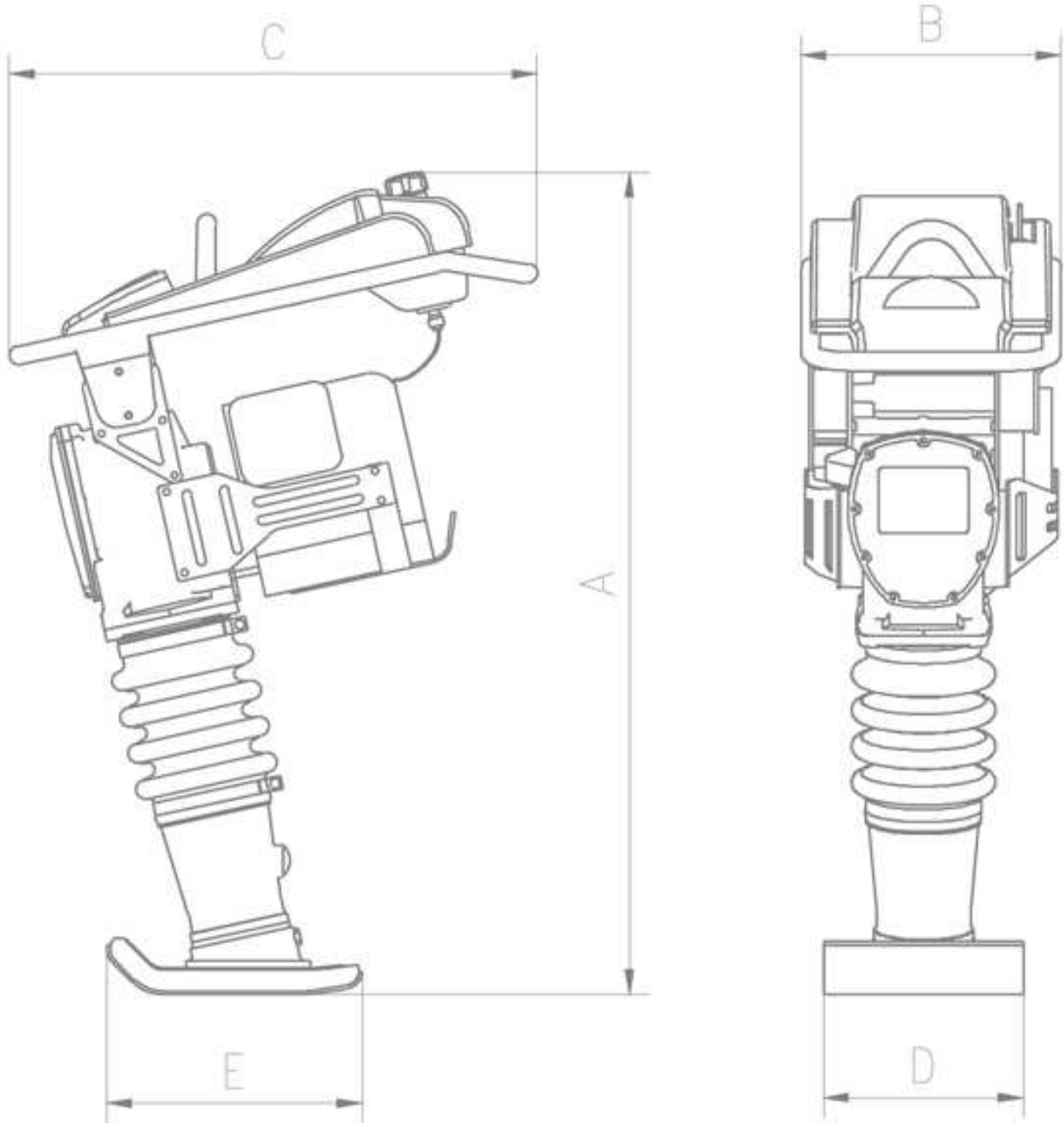

## Technical Specification



Model	PMR60H
Engine Type	Honda GX100
Power Kw(hp)	2.2(3.0)
Weight Kg(lb)	60(132)
Impact Force kN	10.7
Jumping Stroke mm(in)	50-85(2-3.4)
Fuel Tank L	2.8
Shoe size mm(in)	335 x 265(13 x 10)



Model	PMR60R
Engine Type	Robin EH-09
Power Kw(hp)	2.1(2.8)
Weight Kg(lb)	60(132)
Impact Force kN	10.7
Jumping Stroke mm(in)	50-85(2-3.4)
Fuel Tank L	2.8
Shoe size mm(in)	335 x 265(13 x 10)



Model	PMR68H
Engine Type	Honda GX100
Power Kw(hp)	2.2(3.0)
Weight Kg(lb)	68(150)
Impact Force kN	12.8
Jumping Stroke mm(in)	40-85(1.6-3.4)
Fuel Tank L	2.8
Shoe size mm(in)	350 x 285(14 x 11)



Model	PMR75R
Engine Type	Robin EH12-2D
Power Kw(hp)	3.0(4.0)
Weight Kg(lb)	75(165)
Impact Force kN	13.8
Jumping Stroke mm(in)	40-80(1.6-3.1)
Fuel Tank L	2.8
Shoe size mm(in)	350 x 285(14 x 11)

\*We reserve the right to improve or withdraw the specification or product without prior notice.





Essen, Germany, 9:30 PM

**MASTERPAC**<sup>®</sup>  
Professional Compaction

## FORWARD PLATE COMPACTOR



PC3008 Series

PC3610 Series

PC4012 Series

PC4515 Series

PC5018 Series

PC5021 Series

60kg

90kg

115kg



# FORWARD PLATE COMPACTOR

## PC3008/PC3610 SERIES

Ideal for small jobs or narrow areas



### Features

- Solid, high strength steel base plate with curved edges provides top performance.
- Robust design sealed belt cover for Clutch and Belt protection.
- Anti vibration removable flip over handle for easy transportation.
- Optional transport wheel for easy transportation around sites.
- Optional water tank for asphalt use.
- Optional polyerthene pad for paving is available for all single direction models.

### Option

- T - Water tank for asphalt compaction
- M - Rubber mat for pavement
- W - Transport wheel for easy transport

### Working Size (mm)

Model	A	B	C	D
PC3008 Series	1000	890	450	300
PC3610 Series	1000	890	490	360

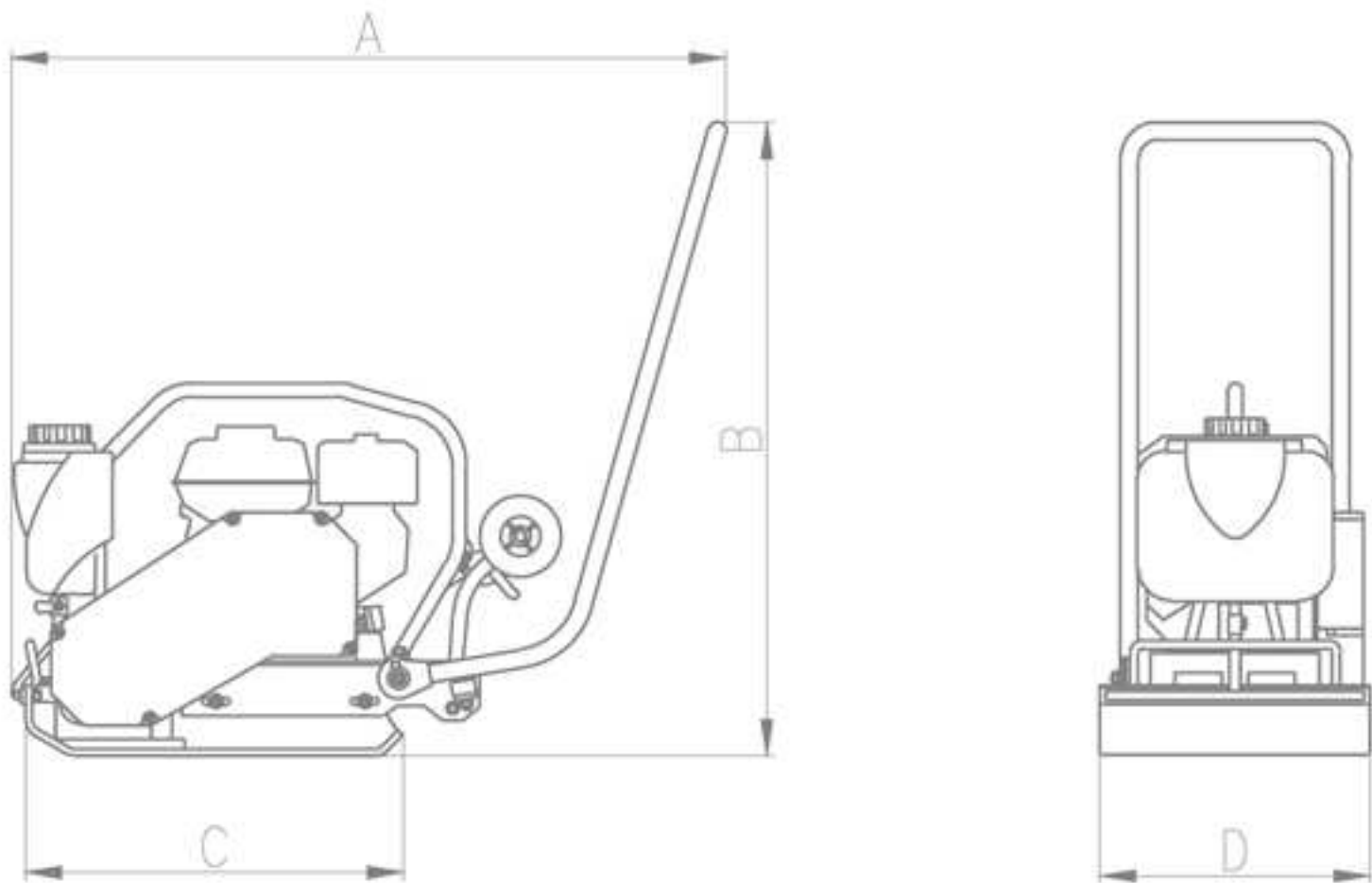

### Technical Specification

Model	PC3008H	PC3008R	PC3610H	PC3610R
Engine Type	Honda GX120	Robin EX13	Honda GX160	Robin EX13
Power kw(hp)	2. 9(4. 0)	3. 2(4. 2)	4. 0(5. 5)	3. 2(4. 2)
Weight kg(lb)	53(117)	53(117)	62(136)	62(136)
Plate Size L X W cm(in)	45x30(18x12)		49x36(19x14)	
Centrifugal Force kN	8		10	
Vibration Frequency vpm(Hz)	5900(98)		5900(98)	
Travel Speed m/min(ft/min)	20(72)		20(72)	

\*We reserve the right to improve or withdraw the specification or product without prior notice.



# FORWARD PLATE COMPACTOR

## PC4012/PC4515/PC5018/PC5021 SERIES

Ideal for all general applications- curbs, gutters, around tanks, forms, columns, footings, landscaping, paving blocks, drainage ditches, and light to medium road repair work.



## Features

- Solid, high strength steel base plate with curved edges provides top performance.
- Cast Iron wear resistant lubricated vibrator assembly.
- Robust design sealed belt cover for clutch and belt protection.
- Anti vibration removable flip over handle for easy transportation.
- Solid engine frame with lifting eye protect engine against dirt and damaging and for easy transportation.
- Sturdy protected throttle lever.
- Optional transport wheel for easy transportation around sites.
- Optional water tank for asphalt use.
- Optional polyethylene pad for paving applications also available.
- Powered by gasoline as HONDA, ROBIN, and diesel as LOMBARDINI, HATZ.



Cast Iron wear resistant lubricated vibrator assembly.



Sturdy protected throttle lever.

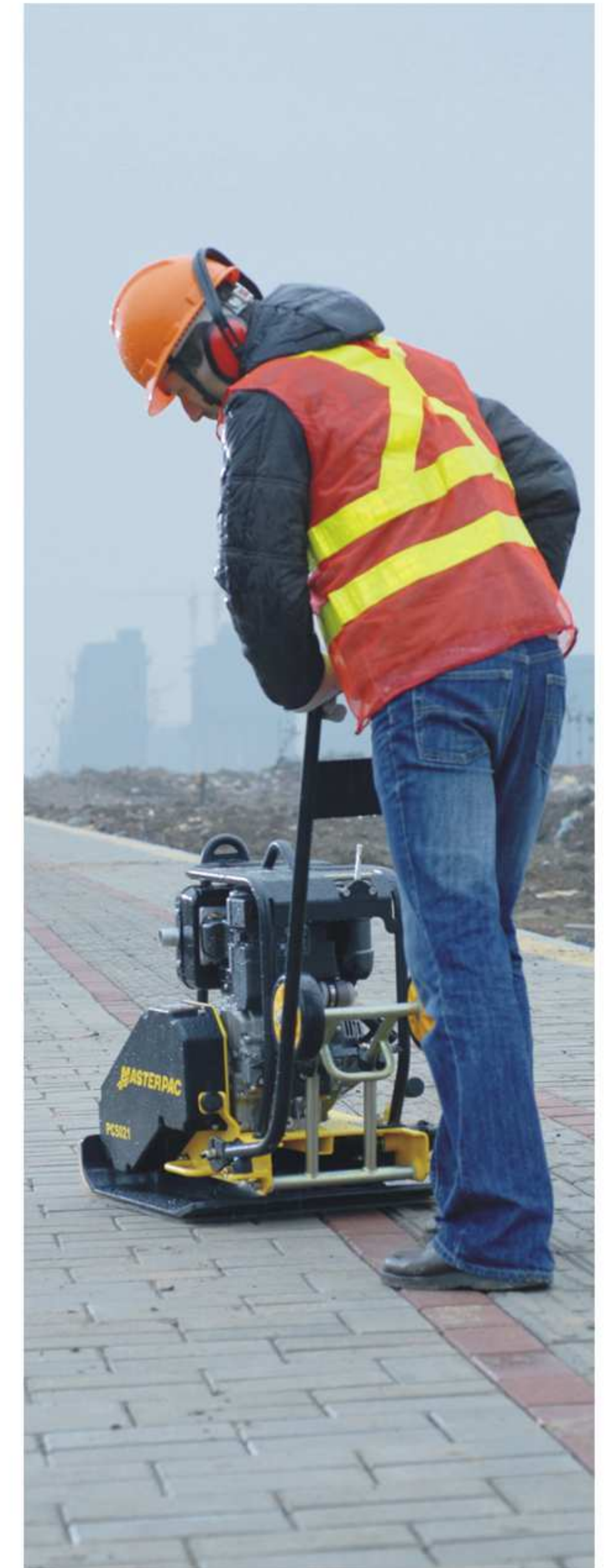



# FORWARD PLATE COMPACTOR

PC4012/PC4515/PC5018/PC5021 SERIES



## Working Size (mm)

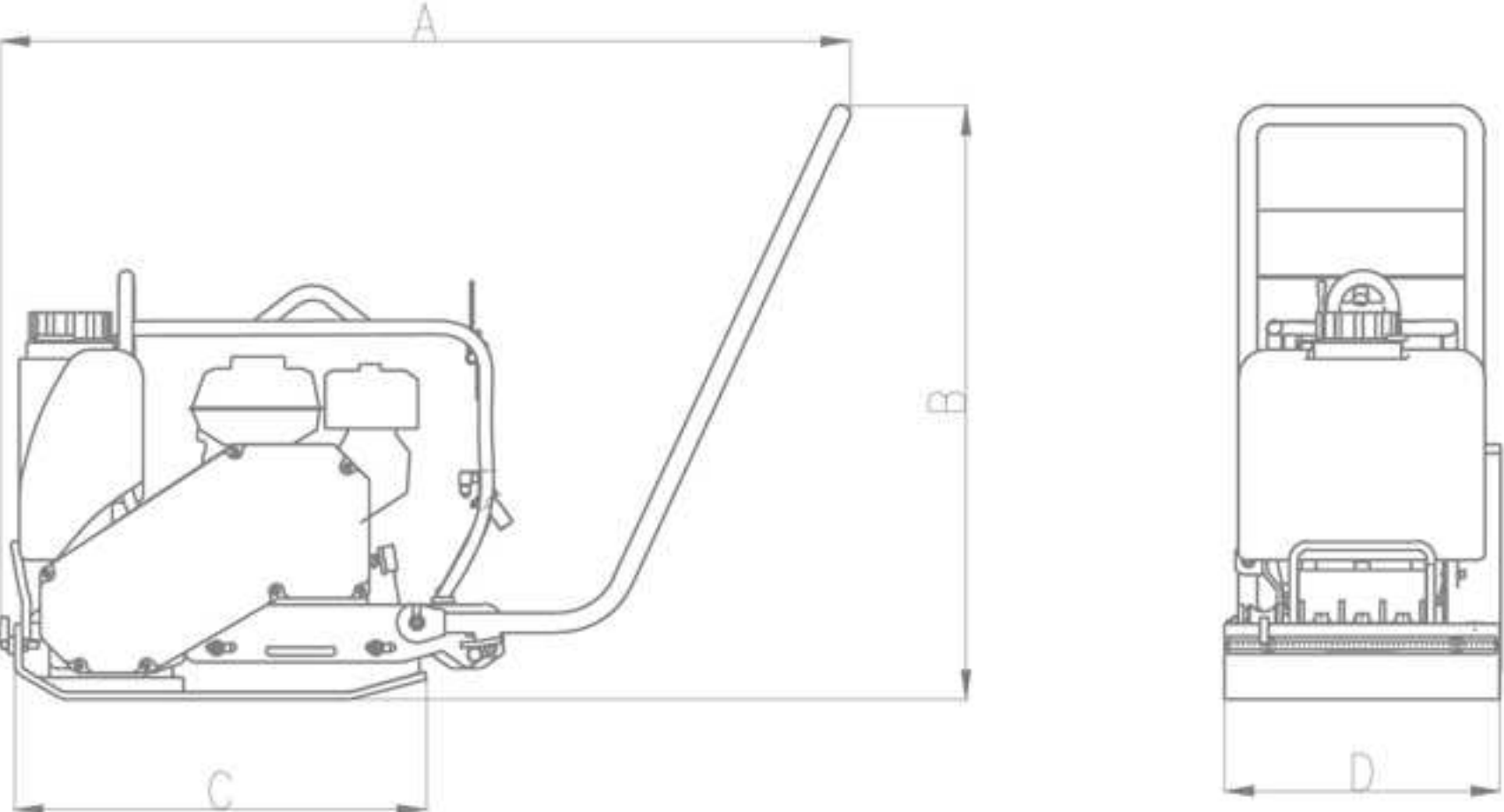

Model	A	B	C	D
PC4012 Series	1030	970	565	400
PC4515 Series	1070	940	565	450
PC5018 Series	1045	945	565	500
PC5021 Series	1065	950	565	500

## Option



- T - Water tank for asphalt compaction
- M - Rubber mat for pavement
- W - Transport wheel for easy transport

## Technical Specification



Model	PC4012H	PC4012R	PC4012L	PC4012A
Engine Type	Honda GX160	Robin EX17	Lombardini LD225	Hatz 1B20
Power kw(hp)	4.0(5.5)	4.2(5.7)	3.5(4.8)	3.5(4.8)
Weight kg(lb)	85(187)	85(187)	98(216)	98(216)
Plate Size L X W cm(in)	57x40(22x16)			
Centrifugal Force kN	12			
Vibration Frequency vpm(Hz)	5400(90)			
Travel Speed m/min(ft/min)	22(72)			



Model	PC4515H	PC4515R	PC4515L	PC4515A
Engine Type	Honda GX160	Robin EX17	Lombardini LD225	Hatz 1B20
Power kw(hp)	4.0(5.5)	4.2(5.7)	3.5(4.8)	3.5(4.8)
Weight kg(lb)	90(198)	90(198)	103(227)	103(227)
Plate Size L X W cm(in)	57x45(22x20)			
Centrifugal Force kN	15			
Vibration Frequency vpm(Hz)	5400(90)			
Travel Speed m/min(ft/min)	24(78)			



Model	PC5018H	PC5018R	PC5018L	PC5018A
Engine Type	Honda GX160	Robin EX17	Lombardini LD225	Hatz 1B20
Power kw(hp)	4.0(5.5)	4.2(5.7)	3.5(4.8)	3.5(4.8)
Weight kg(lb)	113(249)	113(249)	126(278)	126(278)
Plate Size L X W cm(in)	57x50(22x20)			
Centrifugal Force kN	18			
Vibration Frequency vpm(Hz)	5400(90)			
Travel Speed m/min(ft/min)	20(66)			



Model	PC5021H	PC5021R	PC5021L	PC5021A
Engine Type	Honda GX160	Robin EX17	Lombardini LD225	Hatz 1B20
Power kw(hp)	4.0(5.5)	4.2(5.7)	3.5(4.8)	3.5(4.8)
Weight kg(lb)	115(254)	115(254)	128(282)	128(282)
Plate Size L X W cm(in)	57x50(22x20)			
Centrifugal Force kN	21			
Vibration Frequency vpm(Hz)	5400(90)			
Travel Speed m/min(ft/min)	22(72)			

\*We reserve the right to improve or withdraw the specification or product without prior notice.





## Hydraulic Reversible Plate Compactor



Borkov, Denmark, 8:17 am



# HYDRAULIC REVERSIBLE PLATE COMPACTOR

## PCR3820/PCR4025/PCR5030 SERIES

Reversible plate compactors are ideal and versatile for high production and efficient compaction for sand, gravel and cohesive soils. The reversible vibratory plates offer two eccentric weights which increase the compaction force while creating a smooth transition between forward and reverse travel.

Ideally suited for confined granular and mixed soil applications such as trenches, highways, dams, parking areas, airports bridges, and construction foundations.



## Features

- Hydraulic adjustment control lever for easy direction change.
- On the spot compaction for problem areas.
- Infinitely variable hydrostatic forward and reverse motion.
- Reverse travel safety protection ensure the plate automatically reverts to slow forward travel if the operator releases the travel control lever while reversing.
- User friendly isolated vibration handles.
- Fully sealed lubricated wear resistant Cast iron vibrator assembly.
- Handles folds to 45 and 90 degree position for easy transportation and storage.
- Heavy-duty roll cage with lifting eye protect against dirt and damaging and for easy operation.
- Impact-resistant and open self cleaning base plate.
- Unique built in transport wheels provides easy transportation.
- Convenience Oil drain hose.
- Robust design sealed belt cover for clutch and belt protection.
- Electric starter is an option for diesel engine.
- The optional polyurethane pad for paving applications is available.
- Powered by gasoline as HONDA, ROBIN, and diesel as LOMBARDINI, HATZ.



90° handle position for space-saving storage



45° handle position for easy transport

## How to assemble transport wheel?

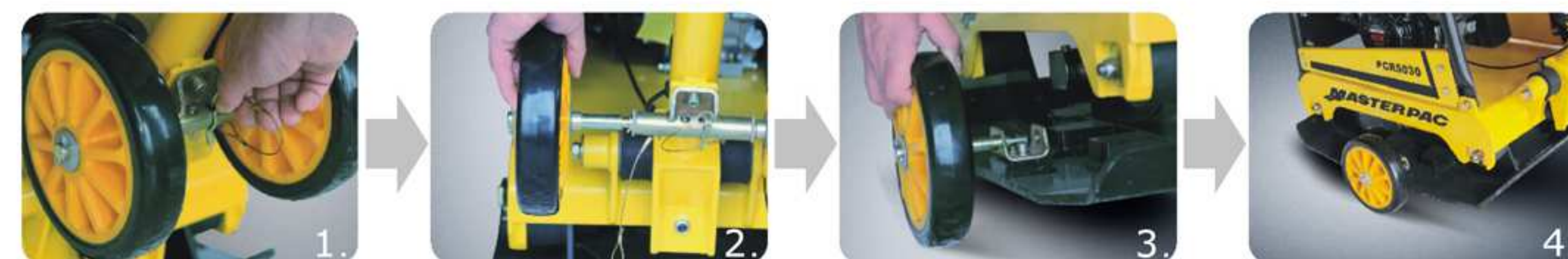



# HYDRAULIC REVERSIBLE PLATE COMPACTOR

PCR3820/PCR4025/PCR5030 SERIES

## Working Size (mm)

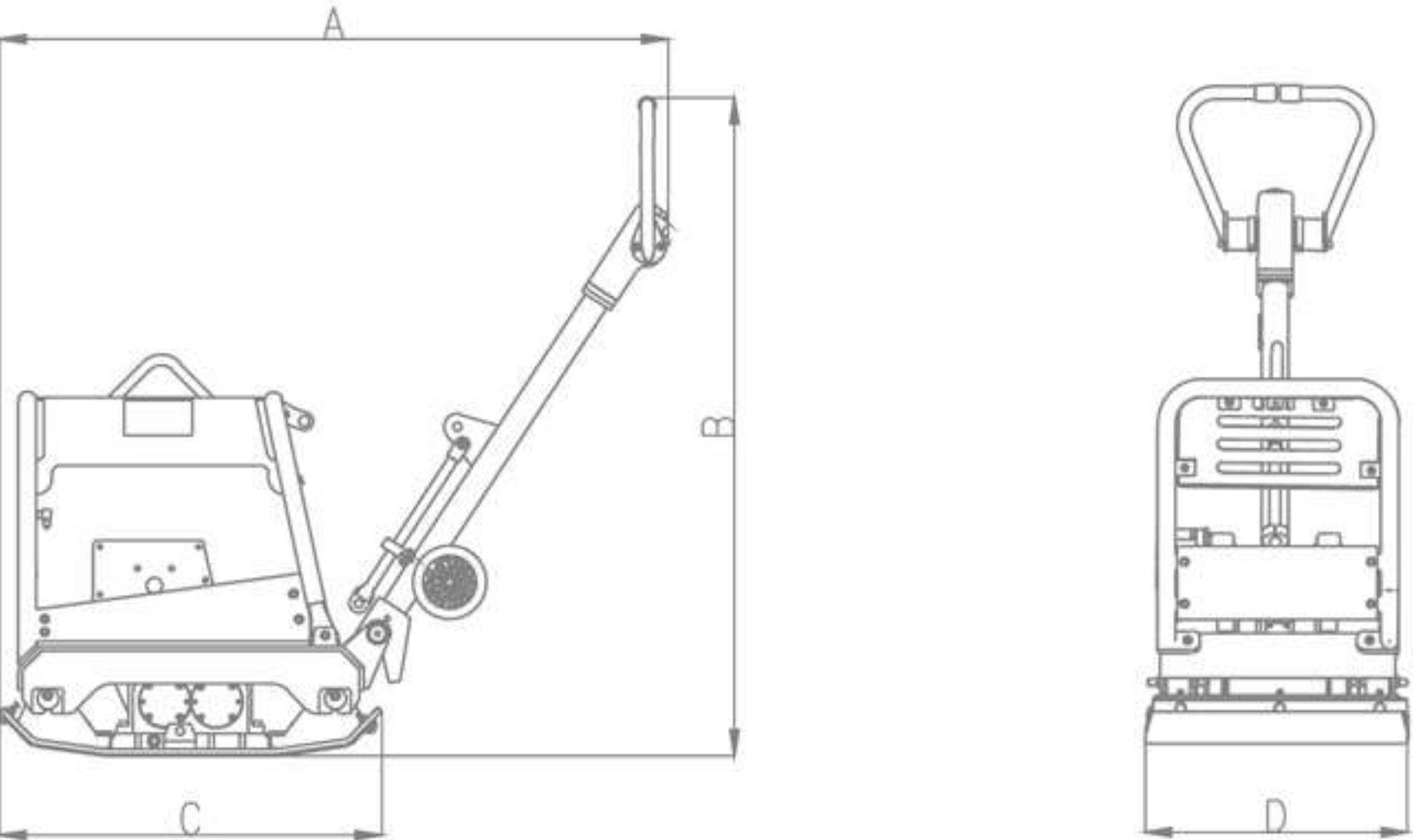

Model	A	B	C	D
PCR3820 Series	1155	1000	580	380
PCR4025 Series	1245	1008	648	400
PCR5030 Series	1268	1010	695	500

## Option



- M - Rubber mat for pavement
- W - Transport wheel for easy transport
- S - Electric starter

## Technical Specification



Model	PCR3820H	PCR3820R
Engine Type	Honda GX160	Robin EX17
Power kw(hp)	4. 0(5. 5)	4. 2(5. 7)
Weight kg(lb)	110(242)	110(242)
Plate Size L X W cm(in)	58x38(23x15)	
Centrifugal Force kN	20	
Vibration Frequency vpm(Hz)	5400(90)	
Travel Speed m/min(ft/min)	22(72)	



Model	PCR4025H	PCR4025R	PCR4025L	PCR4025A
Engine Type	Honda GX160	Robin EX17	Lombardini LD225	Hatz 1B20
Power kw(hp)	4. 0(5. 5)	4. 2(5. 7)	3. 5(4. 8)	3. 5(4. 8)
Weight kg(lb)	145(320)	145(320)	158(348)	158(348)
Plate Size L X W cm(in)	65x40(26x16)			
Centrifugal Force kN	25			
Vibration Frequency vpm(Hz)	5400(90)			
Travel Speed m/min(ft/min)	22(72)			



Model	PCR5030H	PCR5030R	PCR5030L	PCR5030A
Engine Type	Honda GX200	Robin EX17	Lombardini LD350	Hatz 1B30
Power kw(hp)	4. 8(6. 5)	4. 2(5. 7)	5. 5(7. 5)	5. 4(7. 3)
Weight kg(lb)	170(375)	170(375)	187(412)	187(412)
Plate Size L X W cm(in)	69x50(27x20)			
Centrifugal Force kN	30			
Vibration Frequency vpm(Hz)	5400(90)			
Travel Speed m/min(ft/min)	20(66)			

\*We reserve the right to improve or withdraw the specification or product without prior notice.



# HYDRAULIC REVERSIBLE PLATE COMPACTOR

## PCR6040/PCR6550/PCR7060 SERIES

Masterpac reversible plate compactors are the ideal and versatile for high production and efficient compaction for sand, gravel and cohesive soils. The reversible vibratory plates offer two eccentric weights which increase the compaction force while creating a smooth transition between forward and reverse travel.

Heavy-duty compactors are suitable for compaction of sand gravel, crushed aggregate as well as mixed soil with some cohesive content. Widely used in trench work, underground work (cable, water pipe, etc), backfilling along foundations and surface preparation.



## Features

- Hydraulic adjustment control lever for easy direction change.
- On the spot compaction for problem areas.
- Infinitely variable hydrostatic forward and reverse motion.
- Reverse travel safety protection ensure the plate automatically reverts to slow forward travel if the operator releases the travel control lever while reversing.
- User friendly isolated vibration handles.
- Fully sealed lubricated wear resistant Cast iron vibrator assembly.
- Handles folds to 90 degree position for ease of transportation.
- Heavy-duty roll cage with lifting eye protect against dirt and damaging and for easy operation.
- Reverse travel safety protection ensure the plate automatically reverts to slow forward travel if the operator releases the travel control lever while reversing.
- Impact – resistant and open self cleaning base plate.
- Unique built in transport wheels provides easy transportation.
- Convenient Oil drain hose.
- Robust design sealed belt cover for clutch and belt protection.
- Easy access to all maintenance points.
- Compact design with lower centre of gravity.
- Electric start as option for Lombardini diesel engine.



Handles folds to 90 degree position for ease of transportation.



600-700 mm wider plate size



# HYDRAULIC REVERSIBLE PLATE COMPACTOR

PCR6040/PCR6550/PCR7060 SERIES

## Working Size (mm)

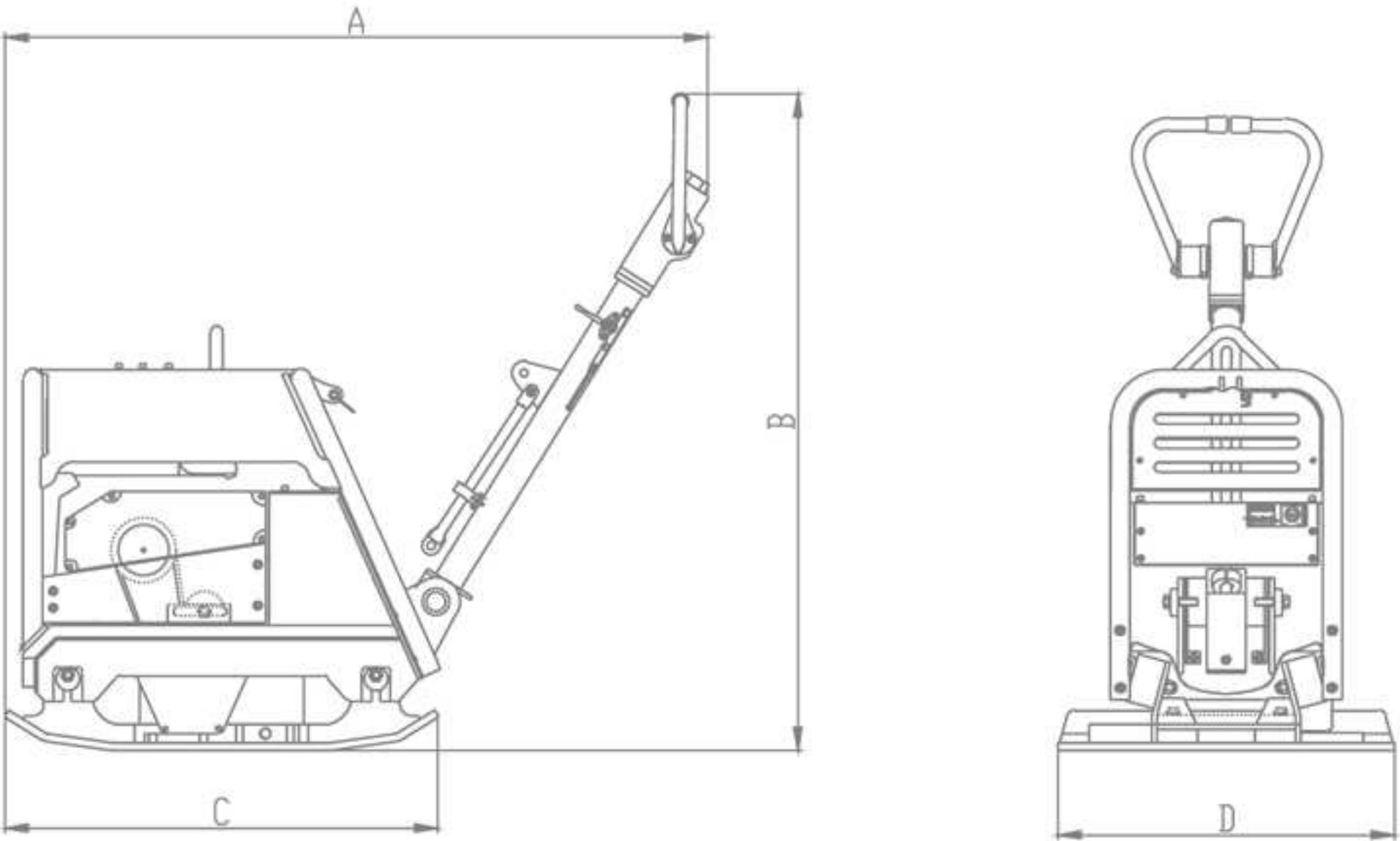

Model	A	B	C	D
PCR6040 Series	1540	1047	900	600
PCR6550 Series	1540	1047	900	655
PCR7060 Series	1585	1040	900	708

## Option



■ S - Electric starter



## Technical Specification



Model	PCR6040H	PCR6040L	PCR6040A
Engine Type	Honda GX270	Lombardini 15LD440	Hatz 1B40
Power kw(hp)	6. 6(9. 0)	8. 1(11)	7. 5(10. 2)
Weight kg(lb)	355(783)	375(825)	378(833)
Plate Size L X W cm(in)	90x60(35x24)		
Centrifugal Force kN	40		
Vibration Frequency vpm(Hz)	4140(69)		
Travel Speed m/min(ft/min)	20-24(66-79)		



Model	PCR6550H	PCR6550L	PCR6550A
Engine Type	Honda GX390	Lombardini 15LD440	Hatz 1B40
Power kw(hp)	9. 6(13. 0)	8. 1(11)	7. 5(10. 2)
Weight kg(lb)	396(873)	410(904)	413(911)
Plate Size L X W cm(in)	90x65(35x26)		
Centrifugal Force kN	50		
Vibration Frequency vpm(Hz)	4140(69)		
Travel Speed m/min(ft/min)	20-25(66-82)		



Model	PCR7060L	PCR7060A
Engine Type	Lombardini 15LD440	Hatz 1B40
Power kw(hp)	8. 1(11)	7. 5(10. 2)
Weight kg(lb)	465 (1025)	468(1032)
Plate Size L X W cm(in)	90x70(35x28)	
Centrifugal Force kN	60	
Vibration Frequency vpm(Hz)	4140(69)	
Travel Speed m/min(ft/min)	20-25(66-82)	

\*We reserve the right to improve or withdraw the specification or product without prior notice.





Ulan Bator, Mongolia, 2:26 PM

**MASTERPAC**<sup>®</sup>  
Professional Compaction

## VIBRATORY ROLLER



SVR58 Series

DVR65 Series

185kg

720kg



# SINGLE DRUM VIBRATORY ROLLER

## SVR58 SERIES

Masterpac single drum roller are lightweight and maneuverable for compaction of granular and asphalt applications, ideally suited to smaller repair and maintenance jobs such as footpath, bridges, patching, landscaping applications.



Deadman control and reversing protection.



Variable height adjustment for operator's comfort.



Narrow overhang for operation close to walls and curbs.





# SINGLE DRUM VIBRATORY ROLLER

## SVR58 SERIES



### Features

**MASTERPAC SVR58**, different to most of chain or belt driven roller on the market, is with a fully hydraulic-drive system consists of hydraulic pump and motors not only on vibration but also movement, eliminating the need for regular periodic adjustments and changes while providing infinitely variable working speed.

- DEADMAN CONTROL and REVERSING PROTECTION for maximum operator safety.
- Easy reach controls for operator comfort.
- Ergonomically design height-adjustable handle for operator comfort and simplified transport.
- Self-cleaning scrapers prevent the buildup of dirt.
- Beveled drum edge eliminates markings on surface.
- SIDE and CURB CLEARANCE allow for a closest approach to pavement, wall, curb and other obstacle.
- Compact design for easy handling in confined areas.
- Thick drum shells for longer drum life.
- Large corrosion-free water tank feature in easily removable for filling or cleaning.
- Built-in cooling fan is designed for longer life and continuous operation.



Thick drum shells for longer drum life.



Beveled drum edge.

### Working Size (mm)

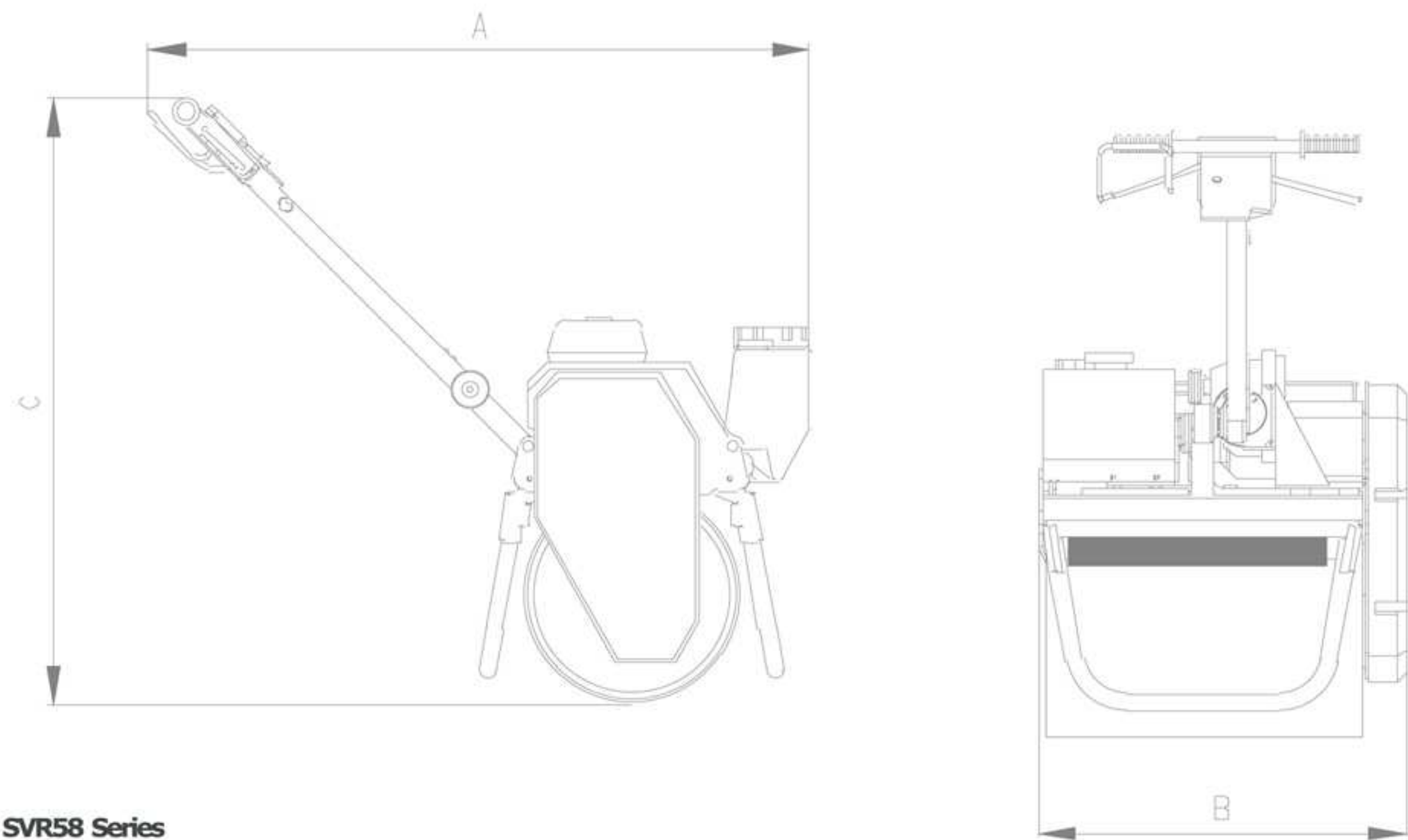

**SVR58 Series**  
A=1350    B=172    C=1320

### Technical Specification



Model	SVR58H	SVR58R
Engine Type	Honda GX160	Robin EX17
Horse power kw(hp)	4.0(5.5)	4.2(5.7)
Weight kg(lb)	185(408)	
Drum Diameter mm(in)	580 x ø400(23 x ø16)	
Centrifugal Force kN	10	
Static Linear Force N/cm	28.5	
Frequency kw vpm(Hz)	4560(76)	
Travel Speed km/h	0-1.5	
Water tank capacity L	15	

\*We reserve the right to improve or withdraw the specification or product without prior notice.



# DOUBLE DRUM VIBRATORY ROLLER

## DVR65 SERIES

Masterpac walk behind rollers are designed rugged and suitable for a wide range of applications in the construction industry.

The rollers deliver excellent compaction to all types of gravel and asphalt surfaces for large and confined areas.



Minimum overhang offer side clearance and curb clearance.



Ergonomically design handle with deadman control and reversing protection.





# DOUBLE DRUM VIBRATORY ROLLER

## DVR65 SERIES

### Features

**MASTERPAC DVR65**, different to most of chain or belt driven roller on the market, is with a fully hydraulic-drive system consists of hydraulic pump and motors not only on vibration but also movement, eliminating the need for regular periodic adjustments and changes while providing infinitely variable working speed.

- DEADMAN CONTROL lever offers REVERSING PROTECTION.
- Mechanical parking brake.
- Multi position handle for operator comfort and simplified transport.
- Built-in oil cooler will increase the productivity of machine.
- Ergonomically designed handle lever are conveniently positioned to ensure speed and vibration.
- Anti vibration controls ensure non-fatiguing and low HAV (Hand/Arm Vibration) for the operator.
- The SIDE and CURB CLEARANCE allow for the closest possible approach to pavements, curbs, walls and other obstacles.
- Dual smooth drums with beveled edge eliminates mark on the ground and asphalt.
- Easy access to front mounted Diesel engine.
- 65 Liter, corrosion-free water tank mounted at the rear of roller reduces sound and keeps dust to a minimum.
- Two scraper bars on each drum ensure a clean drum when working on asphalt.
- Minimum overhang offering suitable side and curb clearance.
- Unique CLUTCH/PUMP drive system provides easy cold weather starting and allows for no-load starting of engine.



Engine choice of LOMBARDINI and HATZ



Electric starter is as option



Sturdy protected throttle control

### Working Size (mm)

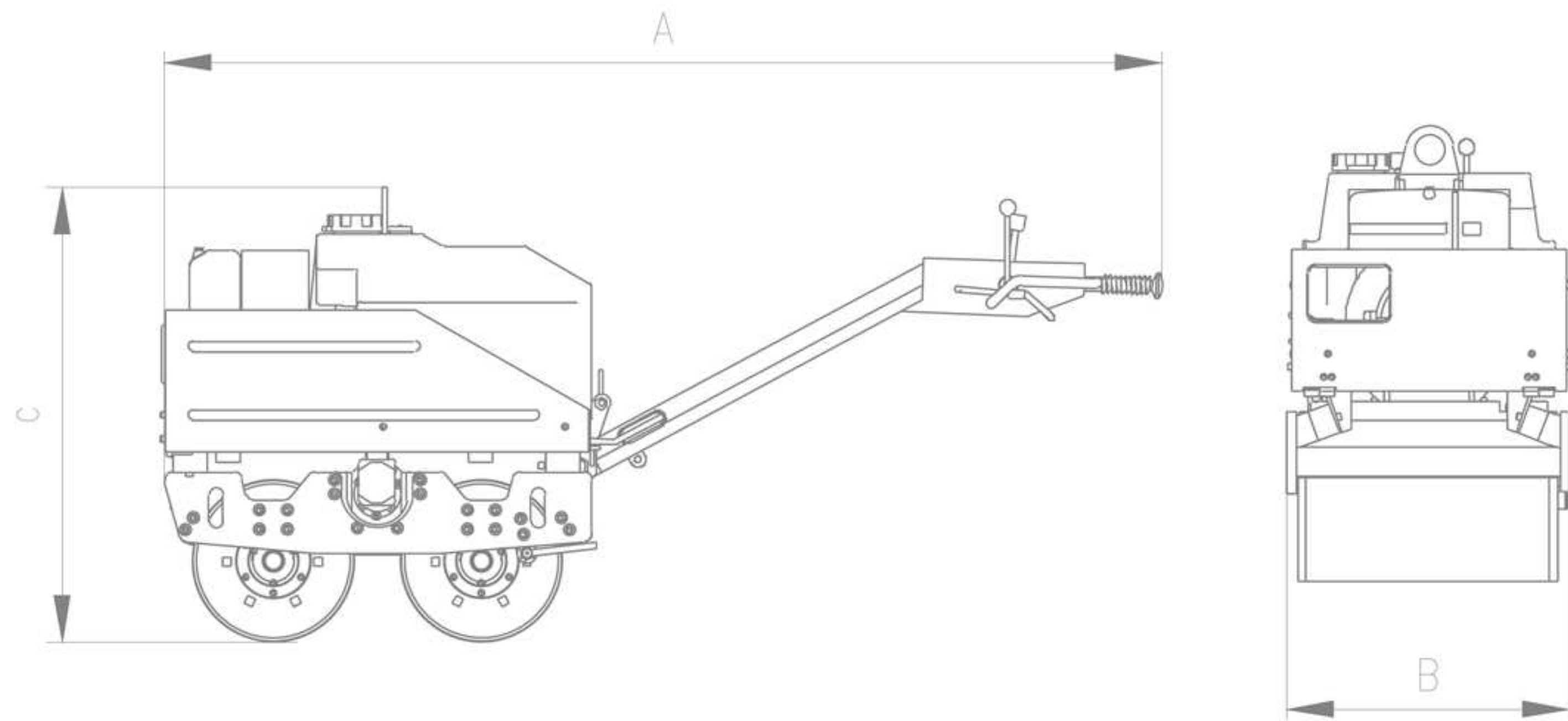

**DVR65 Series**  
A=2450    B=683    C=1130

### Technical Specification



Model	DVR65L	DVR65A
Engine Type	Lombardini 15LD440	Hatz 1B40
Power kw(hp)	8.1(11)	7.5(10.2)
Weight kg(lb)	718(1583)	721(1590)
Drum Diameter mm(in)	650 x ø404(25.6 x ø16)	
Static Linear Force N/cm	54	
Centrifugal Force kN	21	
Frequency vpm(Hz)	3300(55)	
Travel Speed km/h	0-3.6	
Water tank Capacity L	65	

\*We reserve the right to improve or withdraw the specification or product without prior notice.



## COMPACTION DEPTH EFFECT OF MASTERPAC COMPACTION MACHINES

	Tamping Rammer			Forward Plate Compactor						Hydraulic Reversible Plate Compactor						Vibratory Roller	
Layers	PMR60 Series	PMR68H	PMR75R	PC3008 Series	PC3610 Series	PC4012 Series	PC4515 Series	PC5018 Series	PC5021 Series	PCR3820 Series	PCR4025 Series	PCR5030 Series	PCR6040 Series	PCR6550 Series	PCR7060 Series	SVR58 Series	DVR65 Series
5 cm																	
10																	
15																	
20																	
25																	
30																	
35																	
40																	
45																	
50																	
55																	
60																	
65																	
70																	
75																	
80																	
85																	
90																	
95																	
100																	

Cohesive soils



Granular soils



Note: maximum compaction depths listed are a guideline-actual depths achieved depend on exact soil conditions.





By owning a MASTERPAC, you'll hear a lot of compliments about how great it looks. Your machine will likely stay that way, thanks to its user-friendly design.

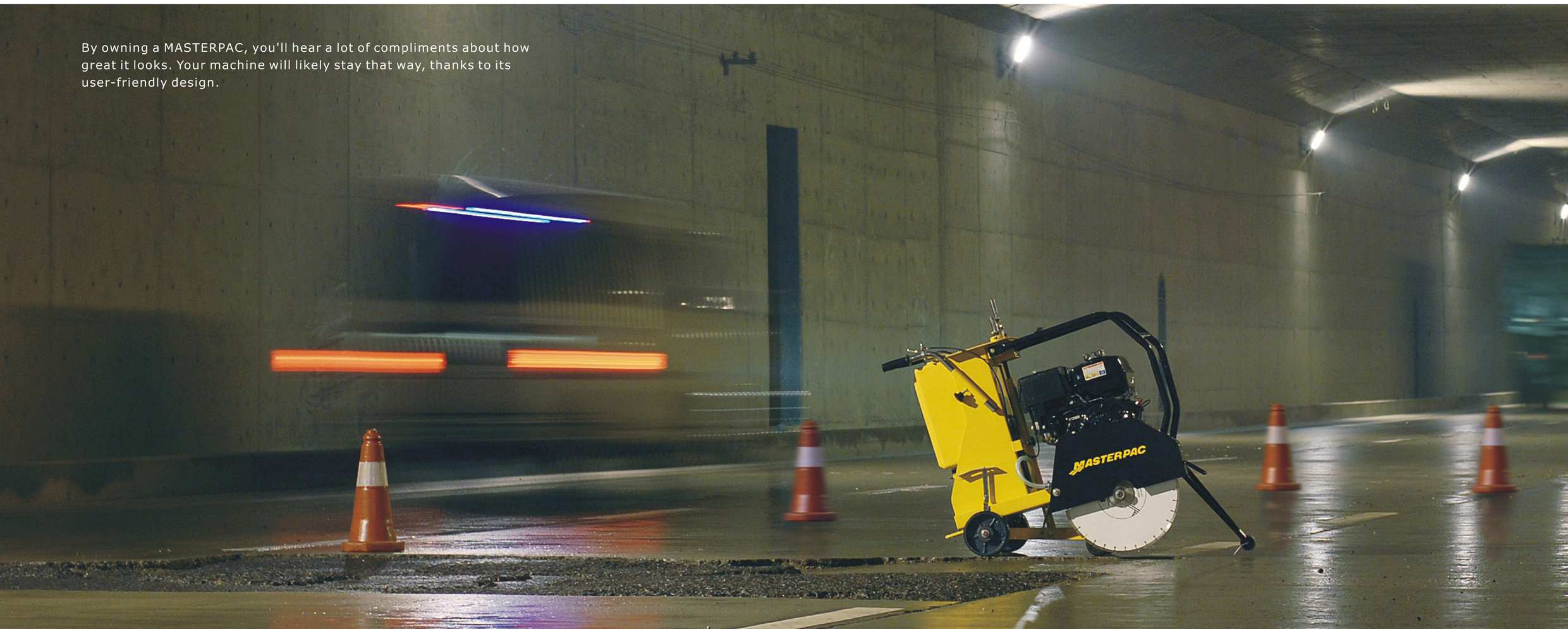





**MASTERPAC**®  
Professional Compaction

## SCREED & VIBRATOR





# VIBRATING SCREED

## PMD SERIES



Vibrating screed, oscillation mechanism to allow work in both directions, produce very accurate level without the need of guiding rails. It is designed to reduce time spent in leveling and economic finishing of large areas of concrete. The vibration of the blade improves the consolidation of the concrete and reduces time spent "bull floating" the concrete surface.



The blade is easy to change.

Clip together handle offer a maximum reach of 5.4 meters with 3 extension sections

The blade produced from hollow section aluminum extrusion with convex profiled sole

Blade angle is easily controlled by a blade pitch control

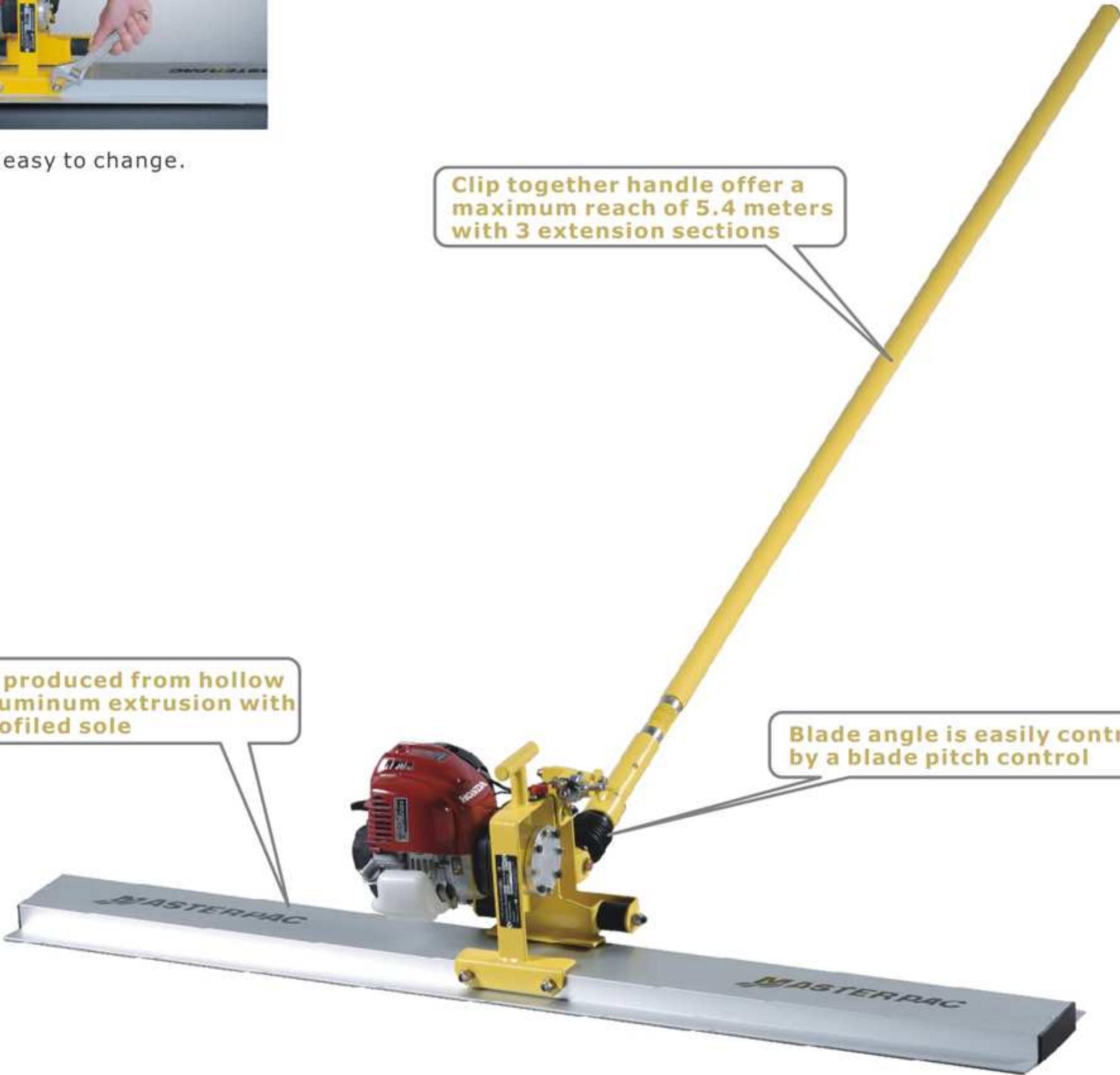

### Features

- The blade produced from hollow section aluminum extrusion with convex profiled sole, is specially designed for the pushing and pulling of concrete.
- Blade angle is easily controlled (for forward/backward movement) by a blade pitch control.
- Clip together handle offer a maximum reach of 5.4 meters with 3 extension sections.
- 4 different working width: 5ft/1.5m ,6.6ft/2.0m,8.2ft/2.5m,9.8ft/3.0m.
- Available with 4 strokes petrol engine for current needs of the market.
- Ergonomically design reduces physical effort and fatigue.
- Low cost to purchase and maintenance.
- Easy cleaning and transportation.

How to extend clip together handle



Turning the handle to the left, to make the blade incline backward, pulling and spreading the concrete.



Turning the handle to the right, to make the blade inclines forward, pushing and spreading the concrete.

### Technical Specification

Model	PMDH		PMDR	
Engine Type	Honda GX25		Robin EH025	
Power Kw(hp)	0.81(1.1)		0.81(1.1)	
Weight Kg(lb)	10(22)		10.5(23)	
Handle Length m(ft)	1.8(6) to 5.4(18)		1.8(6) to 5.4(18)	
Screed Blade Model	PMB-1	PMB-2	PMB-3	PMB-4
Length m(ft)	1.5(5)	2(6.6)	2.5(8.2)	3(9.8)
Weight Kg(lb)	6.2(13.7)	8.3(18.3)	10.3(22.7)	12.4(27.3)



# SURFACE FINISHING SCREED

## PCD SERIES

Simple Operation & Low Maintenance Design.  
Powered by petrol engine, provides uniform vibration over the entire blade length and enhances concrete compaction, makes it possible to level up to 4 times more concrete than the traditional method, and do it more accurately. The units lightweight of only 12kg makes it one of lightest portable unit on the market.



The blade is easily changed within 2 minutes, Masterpac blades are available in length from 4ft. (1.2m) to 16ft. (4.9m).



### Features

- Specially design, hardened aluminum blade ensuring a smoother finish than conventional screeds.
- Heavy rubber mounts to reduce the vibration level on the handle.
- Adjustable handle in height, vertical & horizontal position (optional).
- The rounded ends of the blade make it easy to go around obstacles.
- The tilt-up stand keeps the engine out of concrete or off the ground when not in use.
- One piece casting body easy connect to engine.
- Emergency stop switch available.
- 7 different working widths: 4ft/1.2m, 6ft/1.8m, 8ft/2.4m, 10ft/3.0m, 12ft/3.7m, 14ft/4.3m, 16ft/4.9m
- Easily changed blades, less than 2 minutes.



### How much you can save with MASTERPAC Screed

Comparison for screeding a 2000 sq. m. concrete slab

METHOD	CONVENTIONAL	SCREEDEASY
Labour required	4 men	1 man
Screeding per man	500 sq.m.	2000 sq.m.
Time required	10 hours	7 hours

You save more than 75% in comparison with the conventional method, EVEN save more than 50% in price comparing to other similar machine in the market.

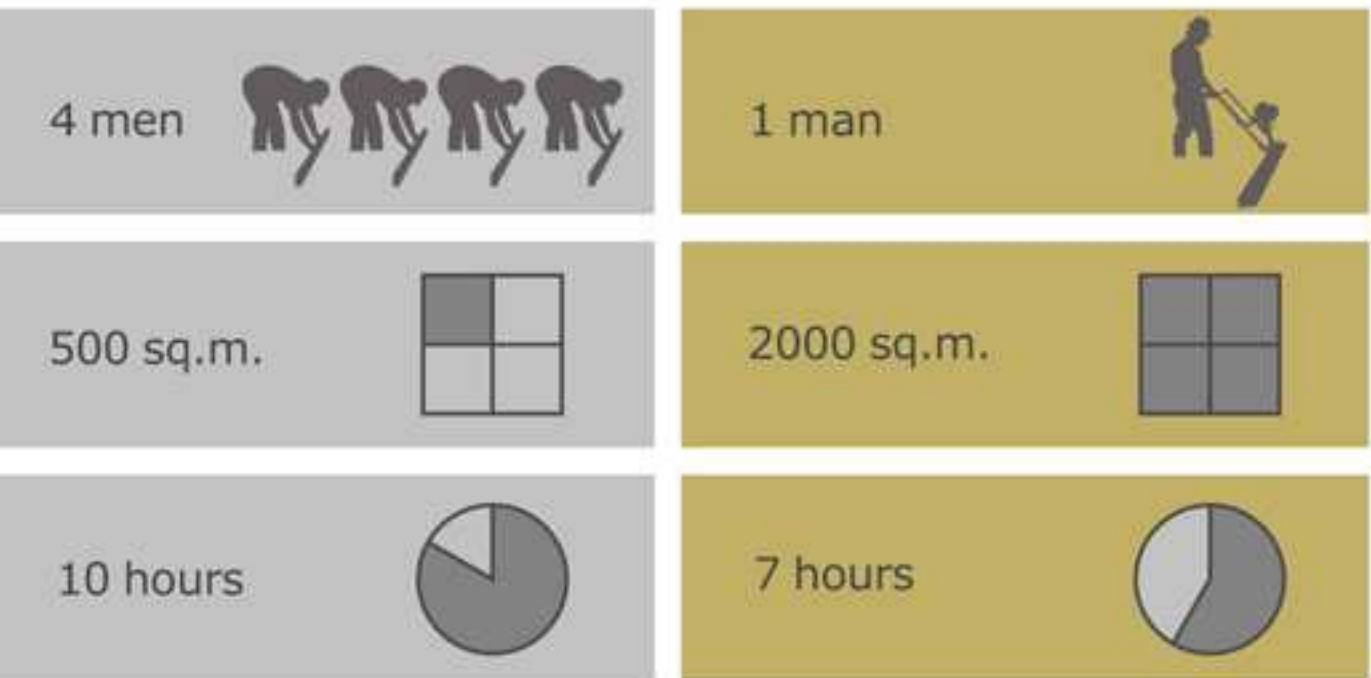

### Technical Specification

Model	PCDH				PCDR		
Engine Type	Honda GX35				Robin EH035		
Power kw(hp)	1.2(1.6)				1.2(1.6)		
Weight kg(lb)	12.7(28.0)				12.9(28.4)		
Blade Model	PCB4	PCB6	PCB8	PCB10	PCB12	PCB14	PCB16
Blade Size (ft)	1.2(4)	1.8(6)	2.4(8)	3.0(10)	3.7(12)	4.3(14)	4.9(16)
Weight kg(lb)	2.90(6.40)	4.36(9.40)	5.81(12.80)	7.27(16.00)	8.72(19.20)	10.16(22.40)	11.61(25.60)



# PENDULUM CONCRETE VIBRATOR



MASTERPAC internal concrete vibrators PVP series, using the pendulum principle, 3000rpm of the drive unit translates via the flexible shaft into 12, 000 vibrations per minute in the poker head.



## Features

- High frequency vibration allows the efficient compaction of low slump concrete mixes. Compaction improves the strength and finish of concrete by driving out entrapped air.
- The low speed of both the vibrator and vibrator drive unit results in longer service life.
- Quick change vibrator coupling for easy operation.

## Drive Unit

Model	PDRH PDSH	PDRR PDSR	PDLR PDSL
Engine Type	Honda GX160	Robin EX17	Lombardini 15LD225
Power kw(hp)	4.0(5.5)	4.2(5.7)	3.5(4.8)
Weight kg(lb)	21(46)	21(46)	34(75)



PDRR-Turnable Round Table



PDSH-Square Frame

## Casing & Poker head

Model	PVP32	PVP38	PVP45	PVP50	PVP70
Vibrator Head Dia x Length mm	32x442	38x442	45x442	50x442	70x442
Vibrator Amplitude mm	1	1.2	1.25	1.3	1.4
Frequency vpm	13500	13500	13500	13500	12000
Revolution of Flexible Shaft rpm	3000-3600				
Flexible Hose Length m	Standard 4m , Maximum 8m				
Approx Weight kg	11	12	13	16	17

## Usage tips & suggestions

- Insert vibrator head into concrete at regular intervals and slowly withdraw after a short delay at the deepest point.
- Distance between immersion points: approx. 10 times the diameter of the internal vibrator.
- Select distance between immersion points so that the concrete areas that are affected by the vibration overlap.

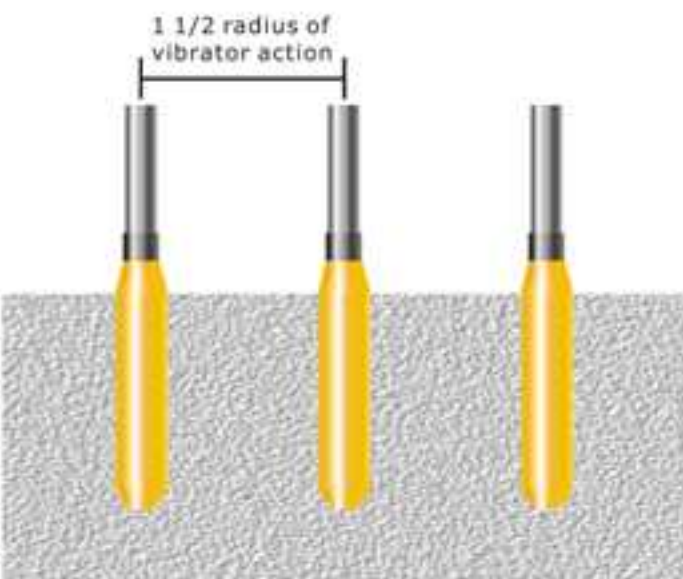

Proper

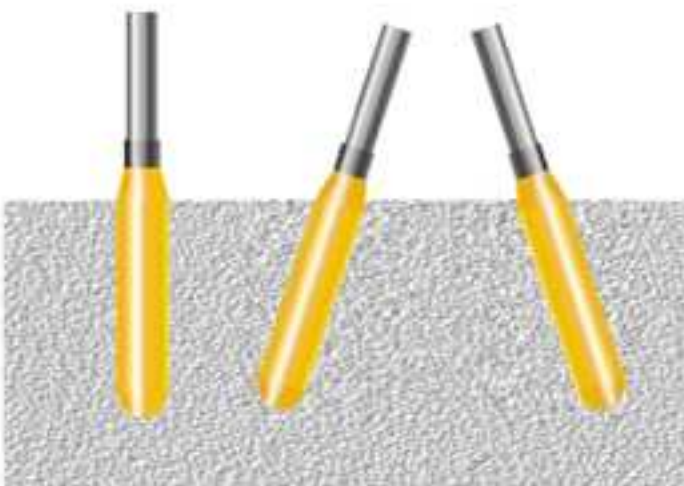

Incorrect

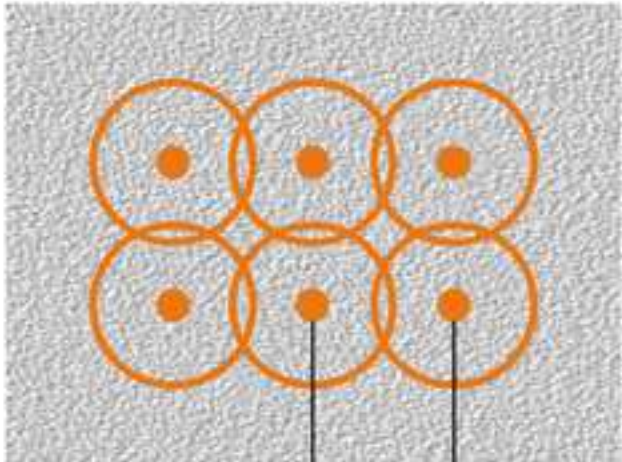

1 1/2 radius of vibrator action

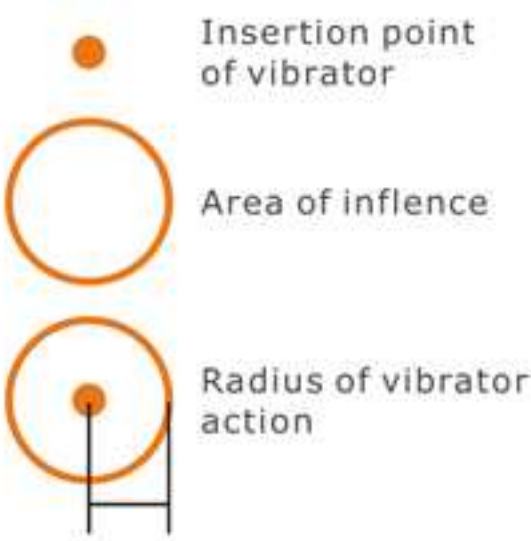

Insertion point of vibrator

Area of influence

Radius of vibrator action

## Submersible Pump (Flexible Shaft Pump)

Our pump is compact with aluminium casting body and can be used with ease even in areas without access to power supply. The high performance pump is designed to offer trouble free operation.

The pump can be driven by the engines through flexible shaft inserted in the hose. Our pump and vibrator could have the same connections. Recommended drive units are our PDR and PDS series.



Casing & Pump Head

## Casing & Pump Head

Model	PSP-2	PSP-3
Discharge Dia mm	50	75
Max. lift m	15	18
Max. Capacity L/min	1000	1300
Revolution rpm	3000-3600	3000-3600
Length of Hose m	*5	*5
Weight w/o Engine kg	21	22

\* Our standard length of flexible hose for the pump is 5m, 4-9m length is available.

## Engine & Vibrator Coupling Unit-Typical Connection

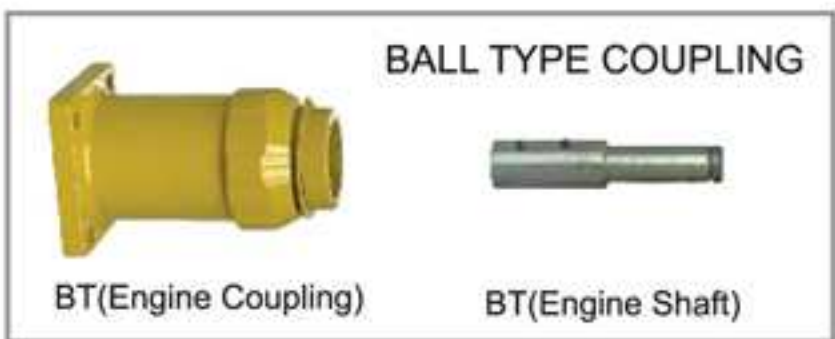

BALL TYPE COUPLING

BT(Engine Coupling)

BT(Engine Shaft)

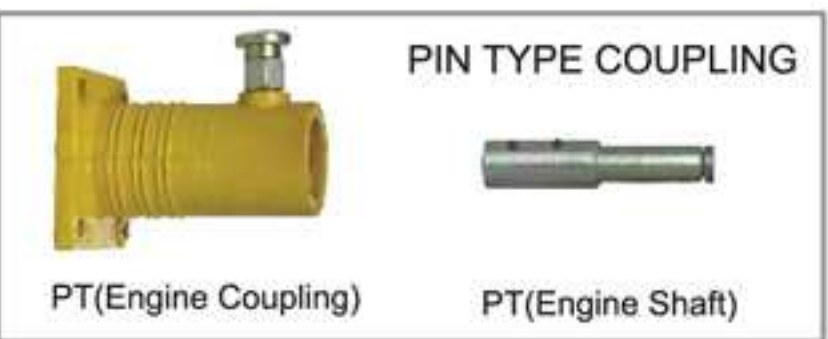

PIN TYPE COUPLING

PT(Engine Coupling)

PT(Engine Shaft)

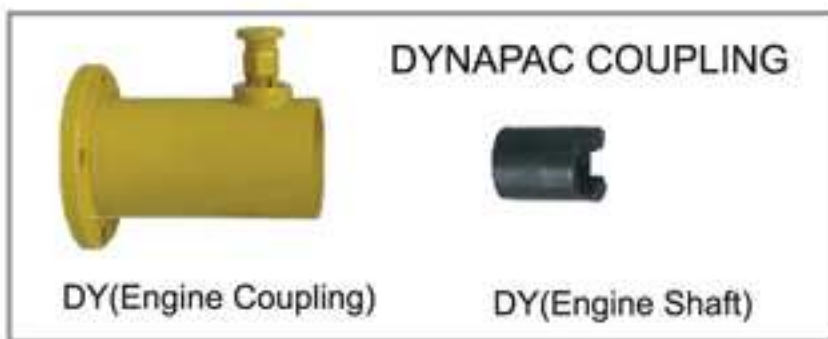

DYNAPAC COUPLING

DY(Engine Coupling)

DY(Engine Shaft)

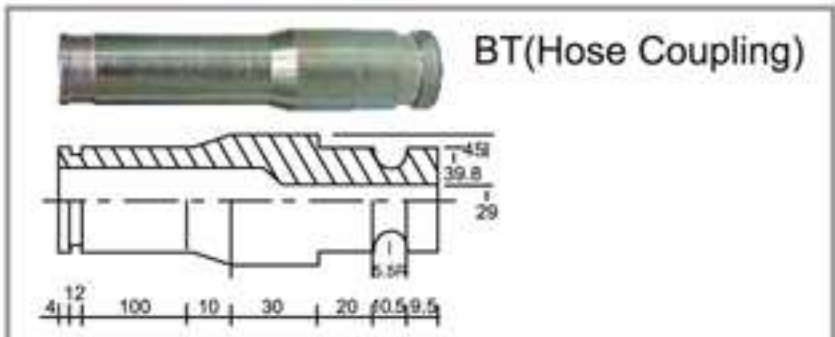

BT(Hose Coupling)

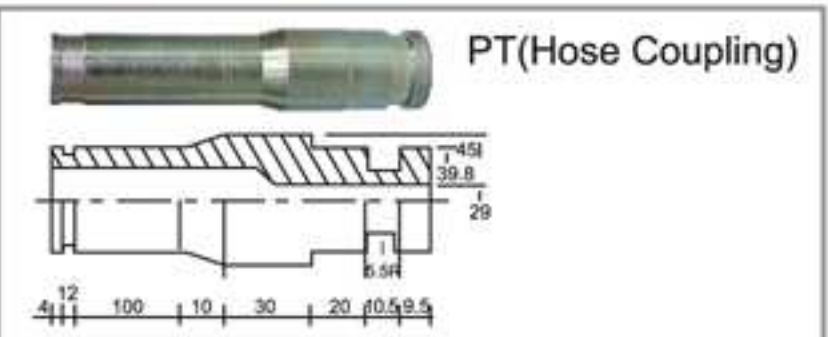

PT(Hose Coupling)

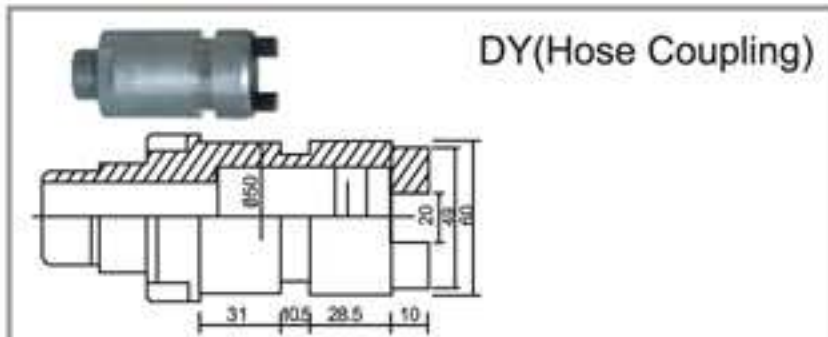

DY(Hose Coupling)

We reserve the right to improve or withdraw the specification or products without prior notice.



# ECCENTRIC CONCRETE VIBRATOR



## Portable Eccentric Concrete Vibrator

### Features

- Strong plastic housing with double insulation and water-proof protection.
- Oversized motor, with reinforced cable against bending.
- Lightweight vibrator provides easier handling and portability in situations with limited access.
- Faster consolidation by high cycle frequency and powerful centrifugal force.

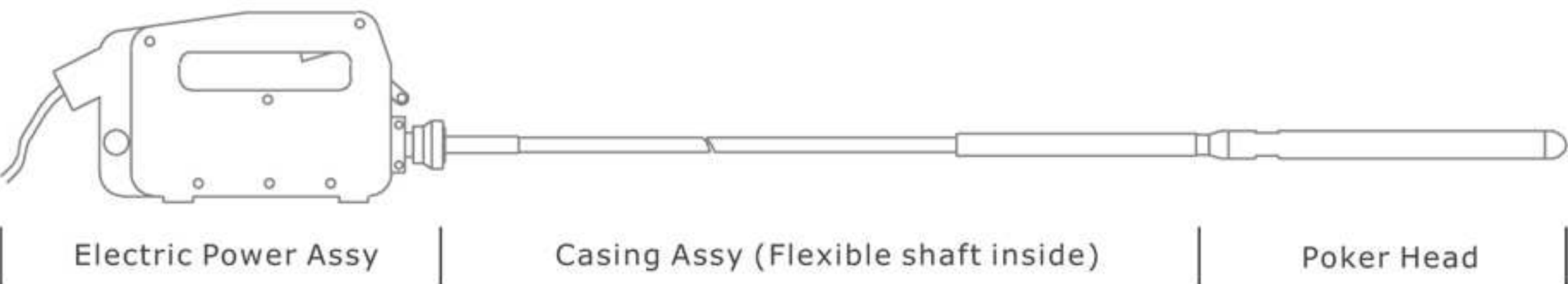

### Electric Power Assy

Model	PVE15
Power Input kw	1.5
Current A	6.0
Voltage Volts	115/230
Frequency Hz	50
Phase	single
Unloaded Speed r/min	18000
Weight kg(lb)	5(11)
Connection to Flexible shaft	Hexagonal Socket

### Casing Assy (flexible shaft inside)

Model	Length m	Weight kg	Correspondent to
VEF2610	1	1.65	PVK28/PVK32
VEF2620	2	2.90	
VEF2630	3	4.20	
VEF3210	1	2.95	PVK38/PVK45/ PVK50
VEF3220	2	5.00	
VEF3230	3	7.20	

### Poker Head

Model	PVK28	PVK32	PVK38	PVK45	PVK50
Dia x Length mm	28x210	32x250	38x250	45x430	50x450
Weight kg	0.60	0.95	1.55	3.80	4.60
Centrifugal Force kN	0.7	0.8	1	1.6	2.1
Vibrator Amplitude mm	1	1	1.2	1.3	1.5
Frequency vpm	12000-14000				
Revolution of Flexible Shaft rpm	12000-14000				

## Backpack Petrol Concrete Vibrator

Powered by Honda 4 stroke petrol engine with comfortable backpack, PBP portable vibrator allows operators vibrating concrete around the site with an ease to use unit. No need for electricity supply or separate drive unit.



### Features

- 4 stroke Honda engine, No oil/gasoline mixture, low noise and low emission.
- Optimal frequency to relieve air and voids in concrete mix.
- Comfortable and lightweight backpack.
- Engine base is swivel-designed both for right-handed and left-handed users.

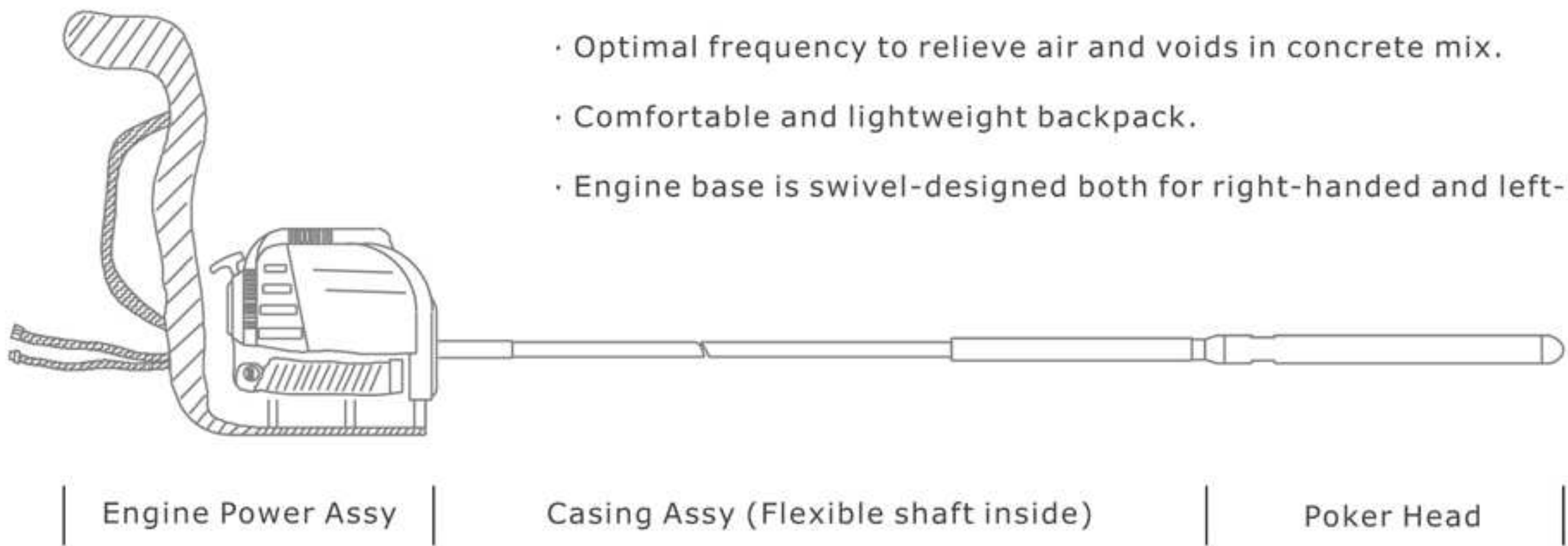

### Engine Power Assy

Model	PBP
Engine Type	Honda GX35
Power kw(hp)	1.2(1.6)
Weight kg(lb)	7.5(16.5)
Connection to Flexible shaft	Square Socket

### Casing Assy (flexible shaft inside)

Model	Length m	Weight kg	Correspondent to
VBF2615	1.5	2.25	PVK32
VBF2625	2.5	2.80	
VBF3215	1.5	3.55	PVK38
VBF3225	2.5	4.40	

### Poker Head

Model	PVK32	PVK38
Dia x Length mm	32x250	38x250
Weight kg	0.95	1.55
Centrifugal Force kN	0.8	1
Vibrator Amplitude mm	1	1.2
Revolution of Flexible Shaft rpm	6500-7000	





Toronto, Canada, 5:37 pm

**MASTERPAC**®  
Professional Compaction

## POWERTROWEL



PMT24 Series

PMT30 Series

PMT36 Series

PMT42 Series

PMT46 Series



# EDGING POWER TROWEL

## PMT24/PMT30 SERIES

Low maintenance & Long-life design.  
Engineered for the concrete professional for  
troweling small surfaces, edges and corners.



### Quick folding - less than 2 minutes

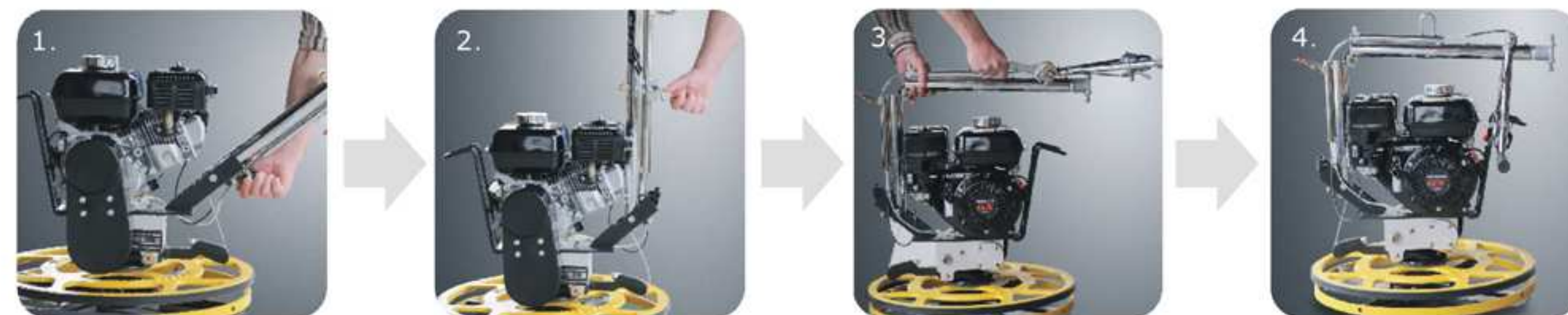

### Features

- Independent rotating flywheel allows operating close to walls and edges.
- Precision bearings ensure consistent operation of flywheel.
- Heavy-duty bronze worm gear for extra long-life.
- Over-built cast aluminum gearbox assures long service interval.
- Spider assembly features in precision alignment, serviceability, and resistance to application induced bending or wearing.
- Chrome plated foldable handle for easy transportation and storage.
- Ergonomically belly-cushion comforts for operator's hip (allows to conveniently push the trowel).
- Dead-man switch assures operator's safety and easy control.
- Twist knob control ensures precise blade adjustment.
- Closed design of guard ensures safety operation.
- Optional Blue blade is with stronger material than standard blades and, combined with its ability to flex slightly, performance is improved and blade life prolonged.
- Optional plastic blade leaves no burnish marks on the floor.



Independent rotating flywheel  
allows operating close to walls  
and edges.



# WALK-BEHIND POWER TROWEL

## PMT36/PMT42/PMT46 SERIES

Low maintenance & Long-life design.

Ideal 36", 42" & 46" diameter troweling machine are designed for all type of flooring applications for the concrete professional and can be used with either combination blades or finishing blades.



Lifting tube allows trowel to be transported on the job-site with only two people.



## Features

- Heavy-weight assures a superior finish.
- Perfectly balanced design for easy and comfortable operation.
- Heavy-duty bronze worm gear for extra long-life.
- Over-built cast aluminum gearbox delivers the torque needed for panning as well as the high speeds needed for finishing.
- Spider assembly features in precision alignment, serviceability, and resistance to application induced bending or wear.
- Gear box oil gauge for easy reading of oil level.
- Chrome plated height adjustable handle comfort and easy control for operator.
- Lifting tube allows trowel to be transported on the job-site with only two people.
- Twist knob control ensures precise blade adjustment.
- Safety designed guard ring according to EU standard.
- Ergonomically designed belly-cushion comforts for operator's hip.
- Dead-man switch assures operator's safety and easy control.
- Stabilizer ring reduces blade chatter.
- Optional Blue blade is thicker than ordinary blades and, combined with its ability to flex slightly, performance is improved and blade life prolonged.
- Optional Plastic blade leaves no burnish marks on the floor.

## Option



- Chrome plated long handle is available as option.
- Lifting eyelet another method for easy transportation.
- Optional trolley wheel for easy transportation.



# POWER TROWEL

## PMT24/PMT30/PMT36/PMT42/PMT46 SERIES



### Working Size (mm)

Model	A	B	C
PMT24 Series	1500	700	900
PMT30 Series	1580	760	900

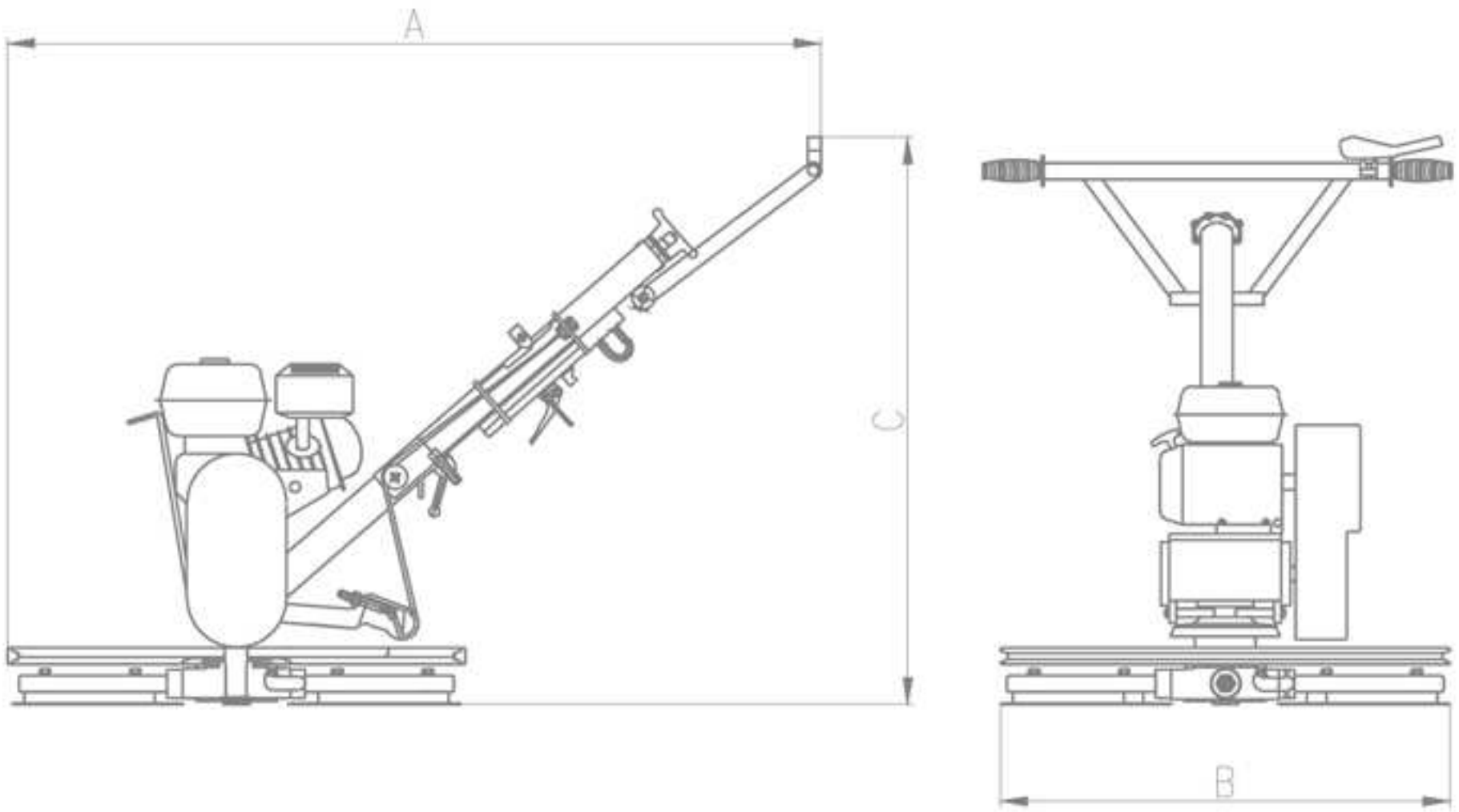

Model	A	B	C
PMT36 Series	1890	970	900
PMT42 Series	2030	1160	1000
PMT46 Series	2060	1220	1000

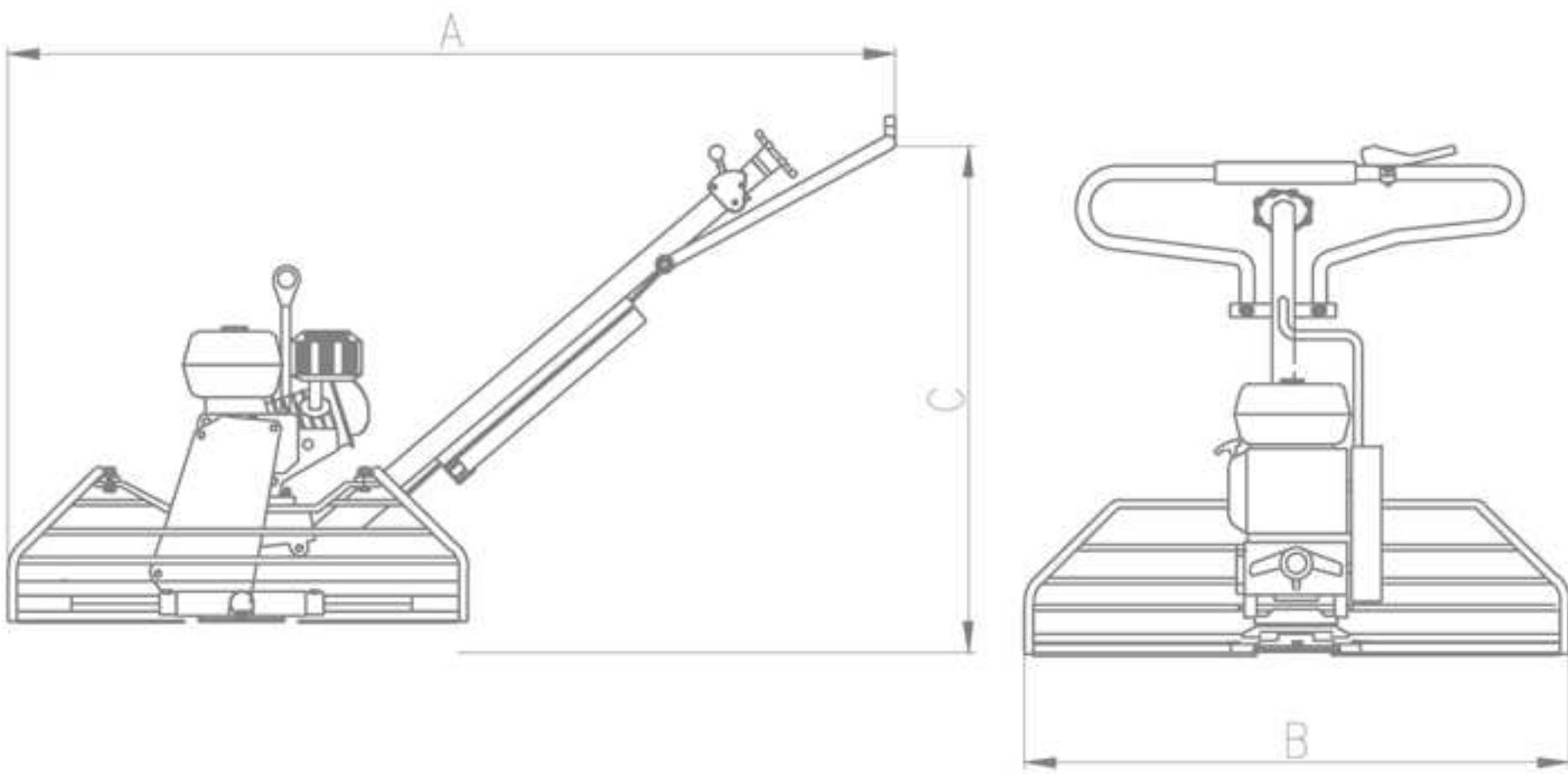

### Technical Specification



Model	PMT24H	PMT24R
Engine Type	Honda GX160	Robin EX13
Power kw(hp)	4.0(5.5)	3.2(4.2)
Weight kg(lb)	56(124)	57(126)
Blade Speed rpm	109-156	109-156
Rotor Dia. cm(in)	61(24)	61(24)



Model	PMT30H	PMT30R
Engine Type	Honda GX160	Robin EX17
Power kw(hp)	4.0(5.5)	4.2(5.7)
Weight kg(lb)	60(132)	62(137)
Blade Speed rpm	109-156	109-156
Rotor Dia. cm(in)	76(30)	76(30)



Model	PMT36H	PMT36R
Engine Type	Honda GX160	Robin EX17
Power kw(hp)	4.0(5.5)	4.2(5.7)
Weight kg(lb)	81(179)	83(183)
Blade Speed rpm	117-167	117-167
Rotor Dia. cm(in)	91(36)	91(36)



Model	PMT42H	PMT42R
Engine Type	Honda GX270	Robin EX27
Power kw(hp)	6.6(9.0)	6.6(9.0)
Weight kg(lb)	104(229)	100(221)
Blade Speed rpm	117-167	117-167
Rotor Dia. cm(in)	106(42)	106(42)



Model	PMT46H	PMT46R
Engine Type	Honda GX270	Robin EX27
Power kw(hp)	6.6(9.0)	6.6(9.0)
Weight kg(lb)	107(236)	103(227)
Blade Speed rpm	117-167	117-167
Rotor Dia. cm(in)	117(46)	117(46)

\*We reserve the right to improve or withdraw the specification or product without prior notice.





# RIDE-ON POWER TROWEL

## PRT73

Ride-on trowel works efficiently and cost-effective for accurate and highly productive finishing of large concrete surface and super FF flat floor tolerance.



## Features

- Heavy duty gearbox provides longer life and low maintenance.
- Steering system features a twin stick multi-directional steering system, providing immediate machine control and precise maneuverability.
- Fine hand control for blade pitch ensures precise blade adjustment.
- Tilt forward seat reveals a built in hoist hook for transport on or off the work site and allows easy engine access.
- Adjustable sliding seat for Front-To-Back.
- Low machine profiles provide a low center of gravity and check the working area easily.
- Rugged frame is made of harden steel for severest site conditions.
- Super heavy-duty gearbox and spider assembly stands up to the most grueling job.
- Side mounted fuel tank and water tank with big volume for long working time.
- Trowel arm alignment: adjustment screws allow easy job site blade alignment.
- Light is adjustable for different direction.
- Tool kit in convenient location easy for operator.



Fine hand control for blade pitch ensures precise blade adjustment.



Lifting tube allows trowel to be transported on the job-site with only two people.



Super heavy-duty gearbox and spider assembly stands up to the most grueling job.



# RIDE-ON POWER TROWEL

## PRT73



### Working Size (mm)

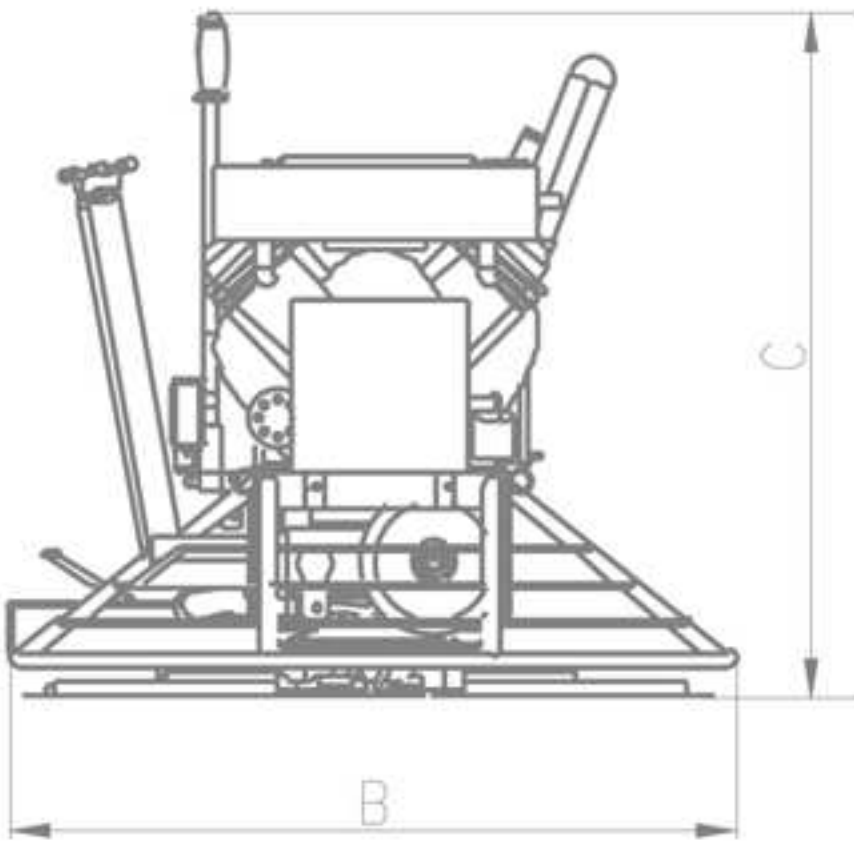
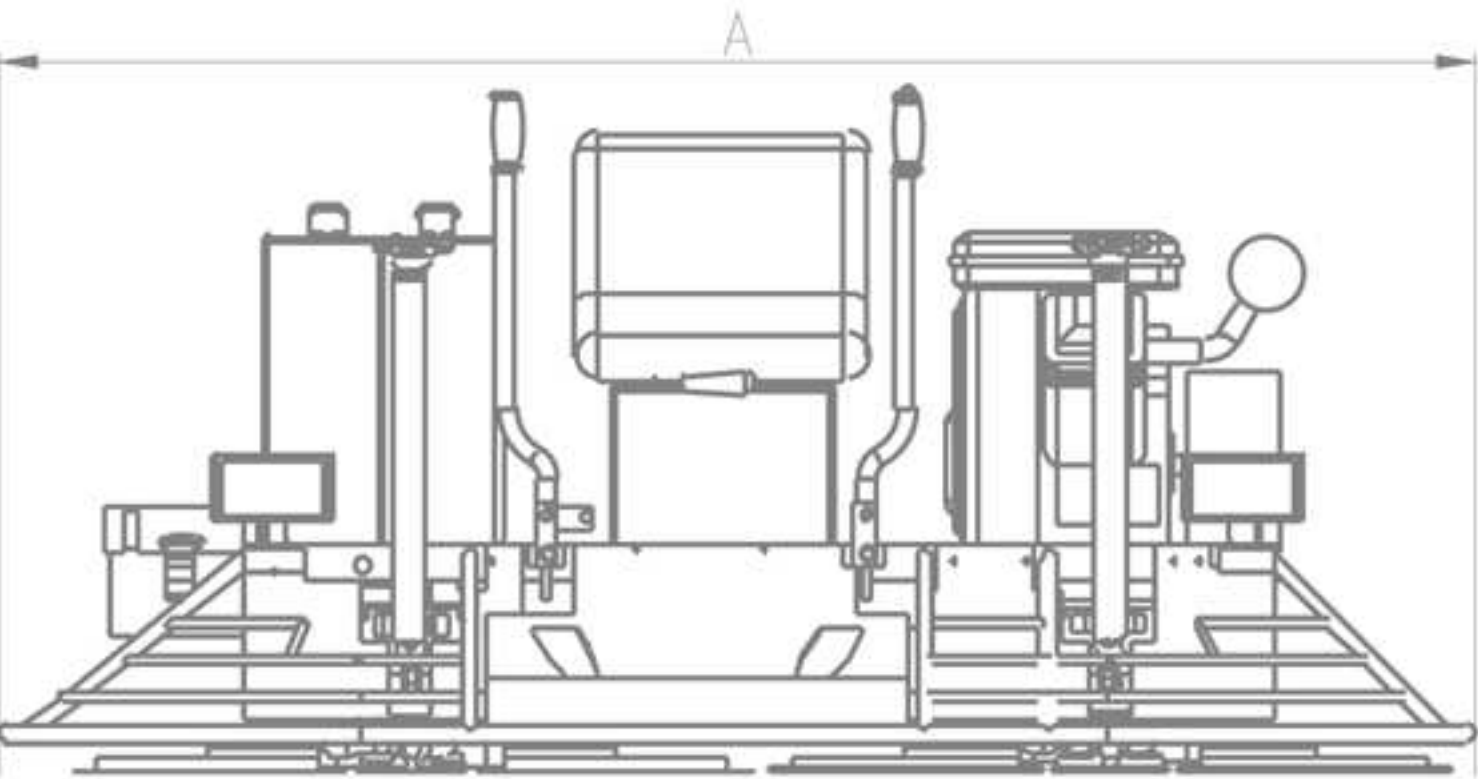

PRT73    A=1900    B=1000    C=1050

### Technical Specification



Model	PRT73
Engine Type	Honda GX670
Power kw(hp)	17.6(24)
Weight kg(lb)	280(617)
Blade Speed rpm	130-150
Working Dia. Mm(in)	1860(73)
Overlapping	NO

\*We reserve the right to improve or withdraw the specification or product without prior notice.







Standard Blade

MASTERPAC offers a complete line of finish blades and combination blades for your edge, walk-behind or ride-on power trowel. We use high quality steel and high strength rivets to maximize blade life. All blades fit most other brands of power trowels.



Super-Blue<sup>™</sup> blade

MASTERPAC Super-Blue<sup>™</sup> blade was designed to provide a perfect balance between longer blade life and maximum operating smoothness with the versatility to be used on both ride-on, edge and walk-behind power trowels.

The Super-Blue<sup>™</sup> is with stronger material than standard blades and, combined with its ability to flex slightly, performance is improved and blade life prolonged.



Available in finish and combination-blade styles only.

Plastic blade



Plastic blades made from a high-density plastic, made to float and finish any application where leaving burnish marks is a concern. Blade life comparable to steel blades. Provides a hard, polished finish.

Available in combination-blade styles only.

Float pan

Super-flat and Flat configurations are available for walk-behind and ride-on trowels. Easy movement from wet to dry areas. Shake-on topping are easily applied.



Technical Specification

	Standard	Super-Blue <sup>™</sup>	Plastic	Thickness mm	Dimension	Correspondent to
Finishing Blade	TBF040901	UBF040901	—	1.6	4.75" x 9"	PMT24 Series
	TBF040902	UBF040902	—	2.0		
	TBF061001	UBF061001	—	1.6	6" x 10.5"	PMT30 Series
	TBF061002	UBF061002	—	2.0		
	TBF061401	UBF061401	—	1.6	6" x 14"	PMT36/PRT73 Series
	TBF061402	UBF061402	—	2.0		
	TBF061601	UBF061601	—	1.6	6" x 16"	PMT42 Series
	TBF061602	UBF061602	—	2.0		
	TBF061801	UBF061801	—	1.6	6" x 18"	PMT46 Series
	TBF061802	UBF061802	—	2.0		
Combination Blade	TBC0409	UBC0409	PBC0409	2.0	4.75" x 9"	PMT24 Series
	TBC0610	UBC0610	PBC0610	2.0	6" x 10.5"	PMT30 Series
	TBC0814	UBC0814	PBC0814	2.0	8" x 14"	PMT36/PRT73 Series
	TBC0816	UBC0816	PBC0816	2.0	8" x 16"	PMT42 Series
	TBC0818	UBC0818	PBC0818	2.0	8" x 18"	PMT46 Series
Float Pan	TBP250	—	—	2.5	25"	PMT24 Series
	TBP310	—	—	2.5	31"	PMT30 Series
	TBP370	—	—	2.5	37"	PMT36 Series
	RBP370	—	—	3.0	37"	PMT36/PRT73 Series
	TBP430	—	—	2.5	43"	PMT42 Series
	TBP460	—	—	2.5	47"	PMT46 Series

We reserve the right to improve or withdraw the specification or products without prior notice.





**MASTERPAC**<sup>®</sup>  
Professional Compaction

## FLOOR SAW



PFG10 Series



PMF18 Series



MASTERPAC offers a wide range of blades for aspects of flat saw requirements. A full range of diamond blade is available and supplied on all relevant products. Details on request.



GREEN CONCRETE SAW  
PFG10 SERIES

The compact designed, lightweight, multipurpose saw allowing for control joints cutting in green concrete, decorative cutting and light slab demolition.



Features

- Prevent random cracking and premature joint failure.
- Lightweight yet heavy-duty construction.
- 10" blade capacity for a 3" depth of cut.
- VACUUM NOZZLE hook-up on blade guard.
- Suitable for CONTROL JOINT CUTTING in green concrete and DECORATIVE CUTTING in cured concrete, LIGHT SLAB DEMOLITION in cured concrete and asphalt.
- Saws right to the edge of walls and columns.
- Center blade mount design for straight line cutting.
- REAR POINTER drops into cut to ensure straight cutting.
- Adjustable handle height for operator comfort.
- Tough polyurethane wheels assembled with sealed ball bearings for absorbing vibration and riding smoothly on all surfaces.
- Standard 5/8" blade arbor.
- EASY CRANK for raising/lowering cutting depth.



Suggested dry cutting diamond blade with undercut protection for Green Concrete.



Rear pointer drops into cut to ensure straight cutting.



Easy crank for raising lowering cutting depth.

Working Size (mm)

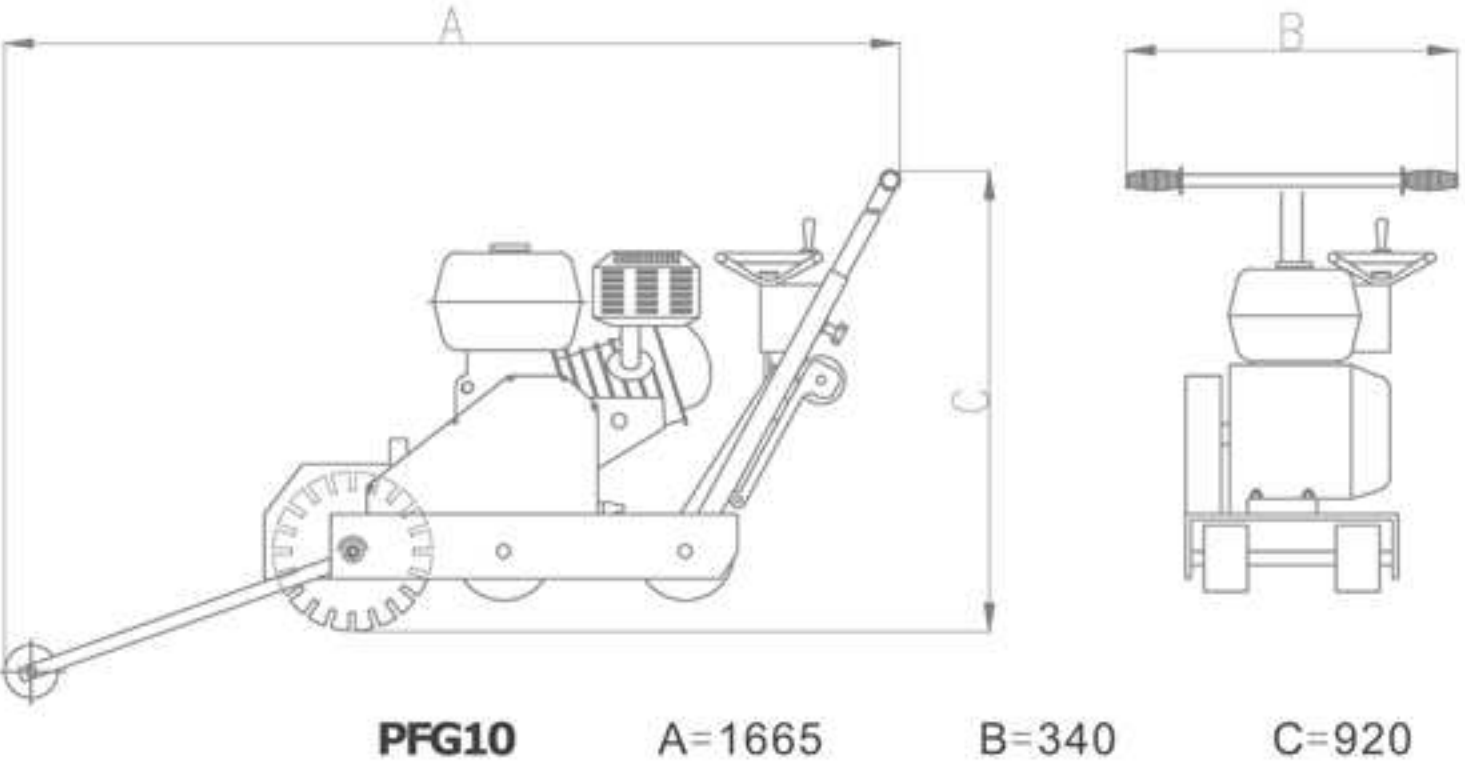

Technical Specification



Model	PFG10H	PFG10R
Engine Type	Petrol, Honda GX200	Petrol, Robin EX17
Power kw(hp)	4.8(6.5)	4.2(5.7)
Cutting Depth mm(in)	82.6(3.25)	82.6(3.25)
Blade size in	10"	10"
Operation weight kg(lb)	50(110)	49(108)
Depth adjustment	Handle Rotation	

\*We reserve the right to improve or withdraw the specification or product without prior notice.



# FLOOR SAW

## PMF14/PMF18/PMF20 SERIES



Designed for strength, durability and performance. Whether cutting concrete or asphalt, the reinforced steel box frame design adds strength necessary to reduce vibrations while sawing. Minimizing vibrations enhances the performance of the blade and extends the life of the saw. Consist of the most popular sizes and configurations for the professional.

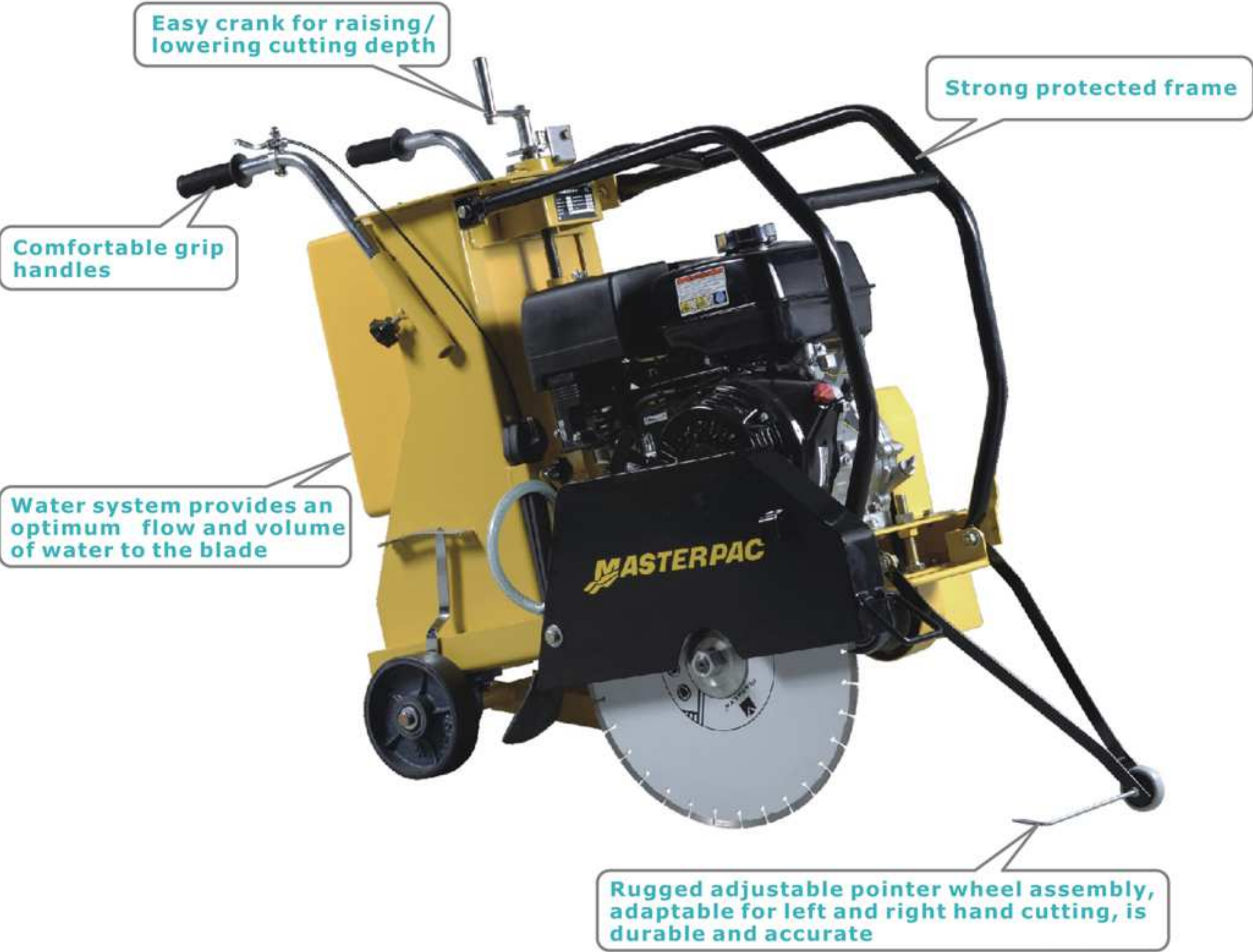

### Working Size (mm)

Model	A	B	C
PMF14 Series	1560	480	950
PMF18 Series	1460	585	950
PMF20 Series	1710	550	1050

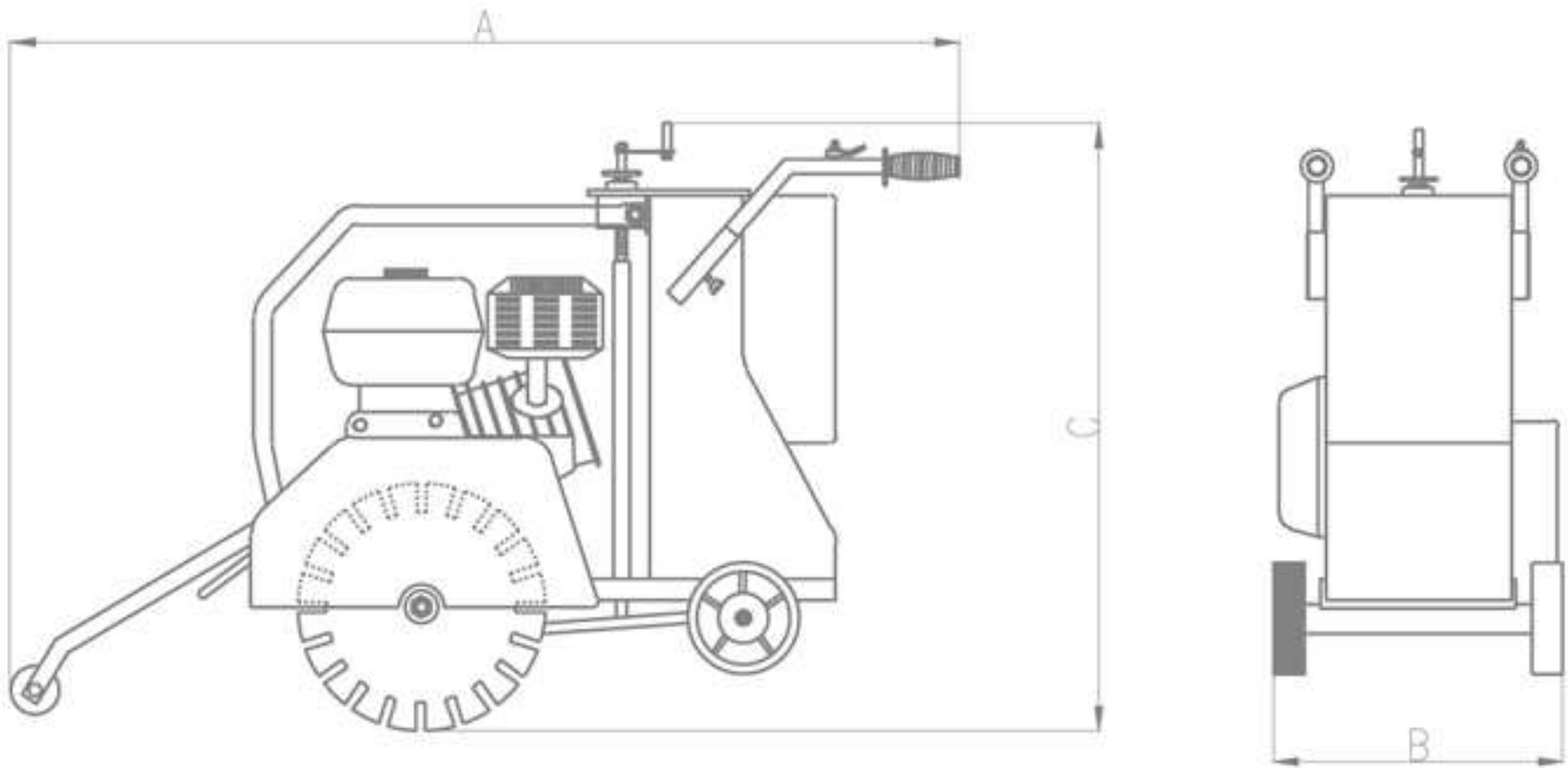

### Features

- Dual blade flanges & reversible guard enable right and left hand cutting.
- Rugged adjustable pointer wheel assembly, adaptable for left and right hand cutting, is durable and accurate.
- Strong protected frame for easy transportation and protect engine undamaged.
- Super-rigid box frame ensures straight cuts while resisting warping and vibration--prolongs saw life; extends blade life.
- Quality shaft bearings for long service life.
- Easy crank for raising/lowering cutting depth.
- Comfortable grip handles.
- Hinged front, lift-up blade guard is designed to provide easy blade replacement.
- Saw position guide helps ensure straight cuts.
- Water system provides an optimum flow and volume of water to the blade.



Dual blade flanges & reversible guard enable right and left hand cutting.



Integrated meter for accurate cutting.

### Technical Specification

Model	PMF14H	PMF14R	PMF14L
Engine Type	Honda GX160	Robin EX17	Lombardini LD225
Power kw(hp)	4. 0(5. 5)	4. 2(5. 7)	3. 5(4. 8)
Weight kg(lb)	83(183)	83(183)	96(212)
Max. Cutting Depth cm(in)	9(3. 5)		
Blade Size cm(in)	30-35(12-14)		
Depth Adjustment	Handle Rotation		
Driving	Manual Push		
Water Tank Capacity L	12		

Model	PMF18H	PMF18R	PMF18L
Engine Type	Honda GX390	Robin EH36	Lombardini LD440
Power kw(hp)	9. 6(13. 0)	8. 6(11. 5)	8. 1(11)
Weight kg(lb)	138(304)	138(304)	152(335)
Max. Cutting Depth cm(in)	14(5. 5)		
Blade Size cm(in)	30-45(12-18)		
Depth Adjustment	Handle Rotation		
Driving	Manual Push		
Water Tank Capacity L	35		

Model	PMF20H	PMF20R	PMF20L
Engine Type	Honda GX390	Robin EH36	Lombardini LD440
Power kw(hp)	9. 6(13. 0)	8. 6(11. 5)	8. 1(11)
Weight kg(lb)	195(430)	195(430)	209(461)
Max. Cutting Depth cm(in)	17(6. 7)		
Blade Size cm(in)	35-50(14-20)		
Depth Adjustment	Handle Rotation		
Driving	Semi-self Propelled		
Water Tank Capacity L	40		

\*We reserve the right to improve or withdraw the specification or product without prior notice.