

ORISON

FARM EQUIPMENT



SOLUTION FOR FARM INDUSTRIES



STABLE, DURABLE & RELIABLE !



...

ORISON Farm Equipment specialized machinery designed to streamline the process of preparing and distributing animal feed on the farm. These tools contribute to the efficiency of livestock and poultry management, ensuring a balanced and nutritious diet for optimal animal health.

TABLE OF CONTENT

01	Grass Pellet Mill	19	Counterflow Cooler	37	Bucket Elevator
03	Feed Pellet Mill	21	Rotary Screener	39	Screw Conveyor
05	Shrimp Feed Pellet	23	Powder Sieve	40	Pneumatic Three Way & Gate Valve
07	Aquatic Single Screw Extruder	25	Drum Type Precleaner	41	Air Lock & Draught Fan
09	Hammer Mill	27	Permanent Magnet	42	Biomass Pelletizer
11	Double Roller Crumbler	29	Pulse Dust Collector	44	Organic Fertilizer Pellet Machine
13	Single Shaft Double Layer Paddle Mixer	31	Automatic Packing System	46	Drum Chipper
15	Single Shaft Double Ribbon Mixer	33	Rotary Distributor	48	Alfalfa/Straw/Husk/Grass Hammer Mill
17	Horizontal Circulation Dryer	35	Liquid Adding System	50	Rotary Drum Drying Machine



Advanced
Technology



High Precision
Gear Rotation



High Quality
Components



Overload
Protection

TYPE: OGPM SERIES

BEST FOR FARM INDUSTRIES

GRASS PELLETT MILL

is mainly suitable for the production of ruminant feed pellets with various grass powders and raw grains such as forage, alfalfa, straw, hemp, hops and so on.

1. The main transmission adopts high-precision gear rotation, and the efficiency is increased by about 15% compared with the belt transmission type, and the ring mold adopts the quick-release type hoop type.

2. High-quality imported bearings and oil seals are used in the transmission part of the whole machine to ensure efficient, stable and low noise.

3. The international advanced level compensation serpentine spring coupling has the characteristics of novel structure, compact, safe, low failure and so on.

4. Strengthen the working strength of the main working parts from the materials, heat treatment and other processes to meet the granulation requirements of biomass particles.

5. There are a number of innovative designs on the ring die, mainly to improve the problems of the ring die to prevent cracking, increase in output and increase in total output.

6. Configured with overload protection device to increase the service life of equipment.

7. The feed auger, conditioner, door cover and ring die are made of stainless steel to avoid contamination of raw materials due to equipment corrosion and longer service life.



TECHNICAL DRAWING

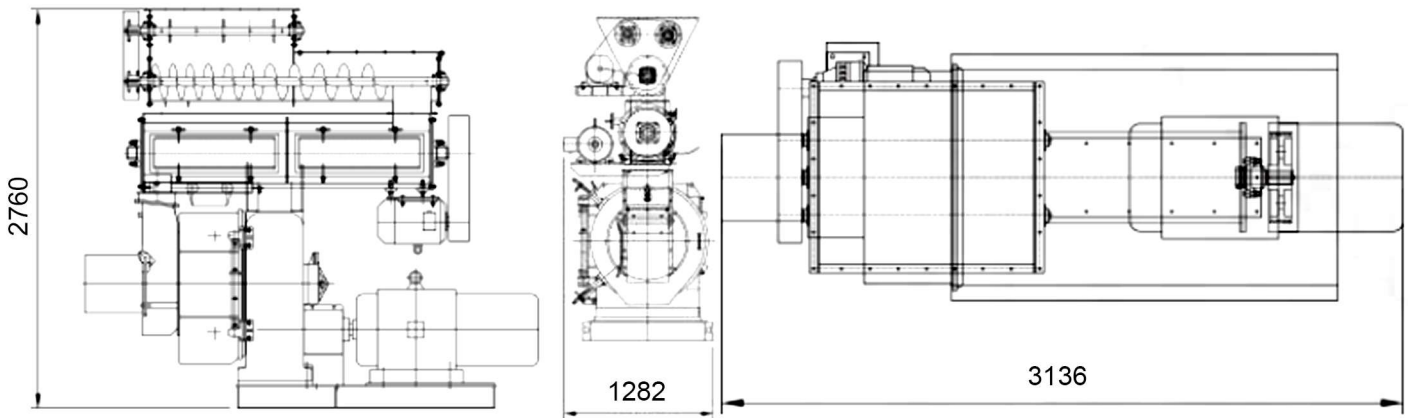

Detail Product :

- Ring Die Material : Stainless Steel
- Door Cover of Granulation Room : 6mm / SUS304
- Feed Chute : 3mm / SUS304
- Gear Box : HT250
- Gear : 42CrMo
- Gear Shaft : 20CrMnTi
- Spindle : 42CrMo
- Empty Shaft : 42CrMo
- Bearing : SKF
- Main Motor Series : 4P Using Siemens Motor



Product Specification

Model	Capacity	Main Motor Power	Forced Feeder	Conditioner Power	Ring Die Diameter	Finished Pellet Diameter
OGPM320	0.7~4 t/h	22 Kw	1.1 Kw	2.2 Kw	320 mm	2~12 mm
OGPM350	1~6 t/h	37 Kw	1.5 Kw	4 Kw	350 mm	2~12 mm
OGPM420	2~10 t/h	90 Kw	1.5 Kw	7.5 Kw	420 mm	2~12 mm
OGPM520	3~15 t/h	132 Kw	1.5 Kw	7.5 Kw	520 mm	2~12 mm
OGPM768	4~30 t/h	250 Kw	2.2 Kw	11 Kw	762 mm	2~12 mm
OGPM858	5~40 t/h	280 Kw	3 Kw	15 Kw	858 mm	2~12 mm



Advanced
Technology



High Quality
Components



High Precision
Gear Rotation



Overload
Protection



TYPE: OFPM SERIES

BEST FOR FARM INDUSTRIES

FEED PELLETT MILL

is mainly suitable for the production of animal feed pellets for livestock, poultry, ruminant, aquaculture and so on.

1. The machine has small volume, low power consumption, low noise, and adjustable feeding speed. It has the characteristics of compact structure, beautiful appearance and stable performance.

2. The main transmission box is made of castings, with large bearing capacity, good stability and long service life.

3. The main transmission system adopts gear transmission, which has high efficiency, and its output is 15% higher than that of the belt type. It adopts high-precision aviation-grade gear grinding technology to ensure stable gear transmission and low noise.

4. The feed auger, conditioner, door cover and ring die are made of stainless steel to avoid contamination of raw materials due to equipment corrosion and longer service life.

5. Equipped with safety pins, such as the main motor is overloaded, the safety pin is broken, and it plays the role of overload protection.

6. Equipped with 2 cutters, which can effectively control the length of the finished pellets.



LOW POWER CONSUMPTION



TECHNICAL DRAWING

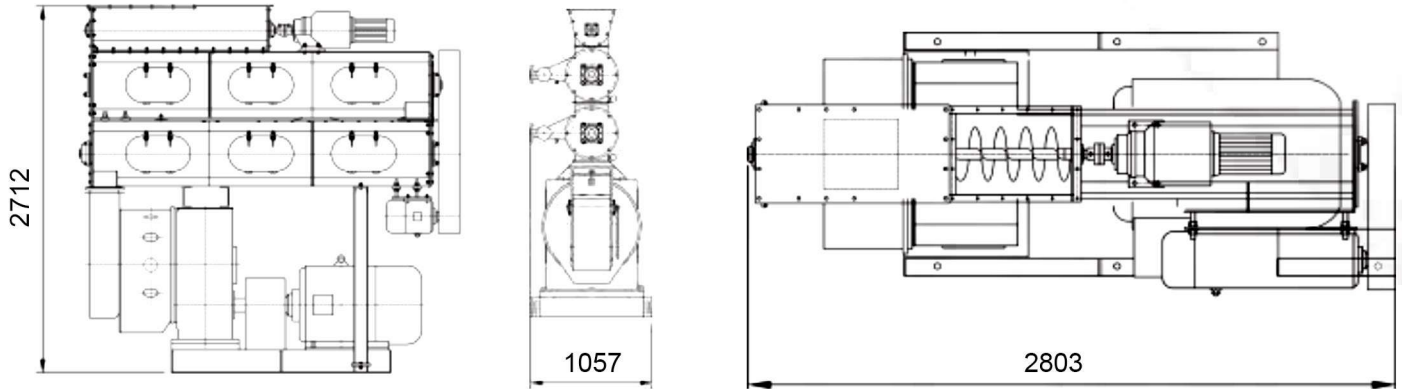

Detail Product :

- **Ring Die Material** : Stainless Steel
- **Door Cover of Granulation Room** : 6mm / SUS304
- **Feed Chute** : 3mm / SUS304
- **Gear Box** : HT250
- **Gear** : 42CrMo
- **Gear Shaft** : 20CrMnTi
- **Spindle** : 42CrMo
- **Empty Shaft** : 42CrMo
- **Bearing** : SKF
- **Main Motor Series** : 4P Using Siemens Motor



Product Specification

Model	Capacity	Main Motor Power	Forced Feeder	Conditioner Power	Ring Die Diameter	Finished Pellet Diameter
OFPM250	1~2 t/h	22 Kw	1.1 Kw	1.5 Kw	250 mm	2~12 mm
OFPM320	3~4 t/h	37 Kw	1.5 Kw	2.2 Kw	320 mm	2~12 mm
OFPM350	5~7 t/h	55 Kw	1.5 Kw	7.5 Kw	350 mm	2~12 mm
OFPM420	8~12 t/h	110 Kw	1.5 Kw	11 Kw	420 mm	2~12 mm
OFPM508	10~18 t/h	160 Kw	2.2 Kw	11 Kw	508 mm	2~12 mm
OFPM558	15~25 t/h	180/200 Kw	2.2 Kw	11 Kw	558 mm	2~12 mm
OFPM678	20~30 t/h	220/250 Kw	2.2 Kw	11 Kw	673 mm	2~12 mm
OFPM768	25~40 t/h	250/280 Kw	2.2 Kw	15 Kw	762 mm	2~12 mm
OFPM858	28~45 t/h	315/355 Kw	2.2 Kw	15 Kw	858 mm	2~18 mm



Advanced
Technology



High Quality
Components



High Precision
Gear Rotation



Overload
Protection

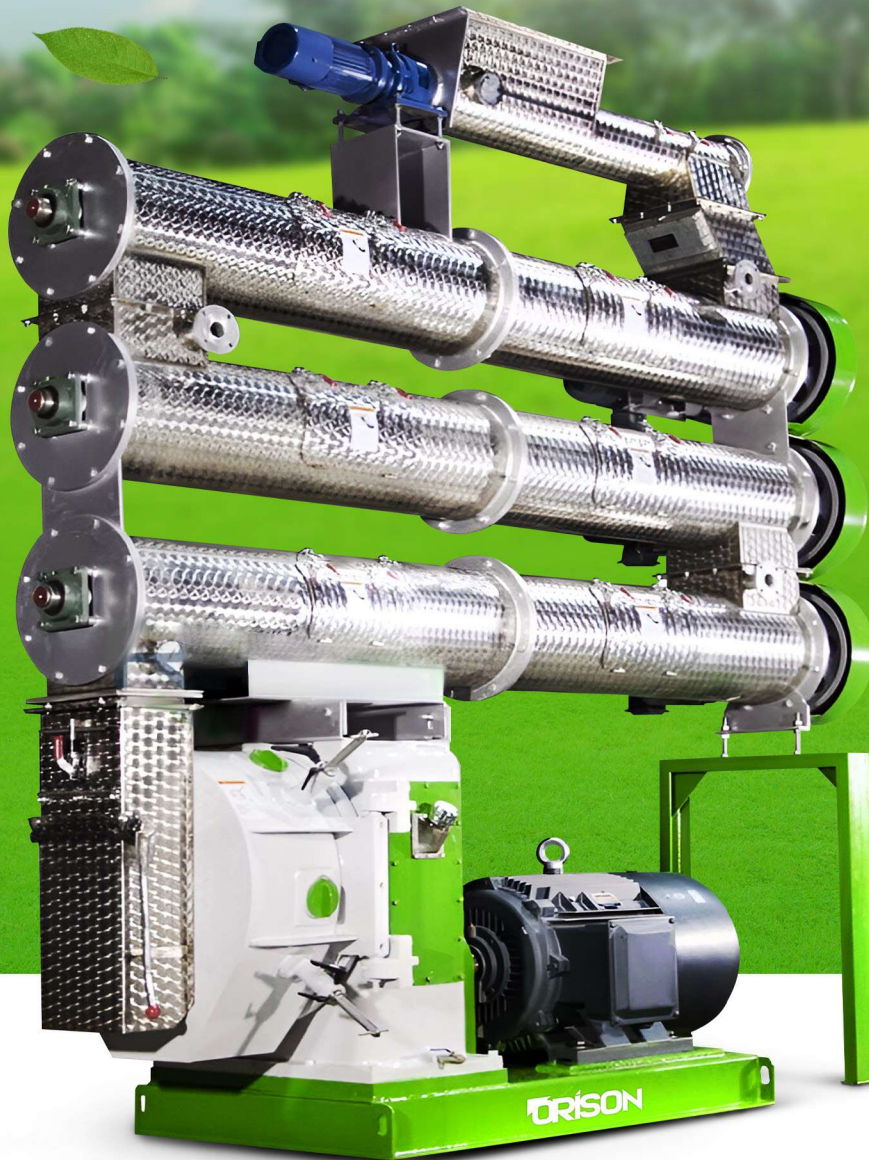

TYPE: OSPM SERIES

BEST FOR FARM INDUSTRIES

SHRIMP FEED PELLET

According to the characteristics of shrimp material to design the speed of the ring die, which greatly improves the production capacity of the pellet machine and the appearance and internal quality of the shrimp pellet.

1. Centralized valve control system, reliable steam addition and convenient operation.
2. The main drive and pressing chamber have been upgraded and improved, the output has been increased, and the pellet quality has been better.
3. The feeding device adopts circular feeding barrel and variable frequency feeding. The feeder is connected with the feeding barrel to prevent caking and ensure uniform feeding.
4. The conditioner uses a three-layer jacketed conditioner or a double-shaft differential conditioner. The specially designed blade installation, the rotate speed of the conditioning shaft and the steam adding system can ensure that the material can be fully conditioning and matured.

5. The cutter assembly is fixed on the box body, there is no need to exit the cutter when opening the door. The blades are made of high-speed tool steel or a special alloy of tip welding. The blade thickness is 2-3 mm.

6. Design special press roller for shrimp feed, Improve the original feeding scraper and distribute the materials equally to each pressing area, so that the materials are evenly distributed.



TECHNICAL DRAWING

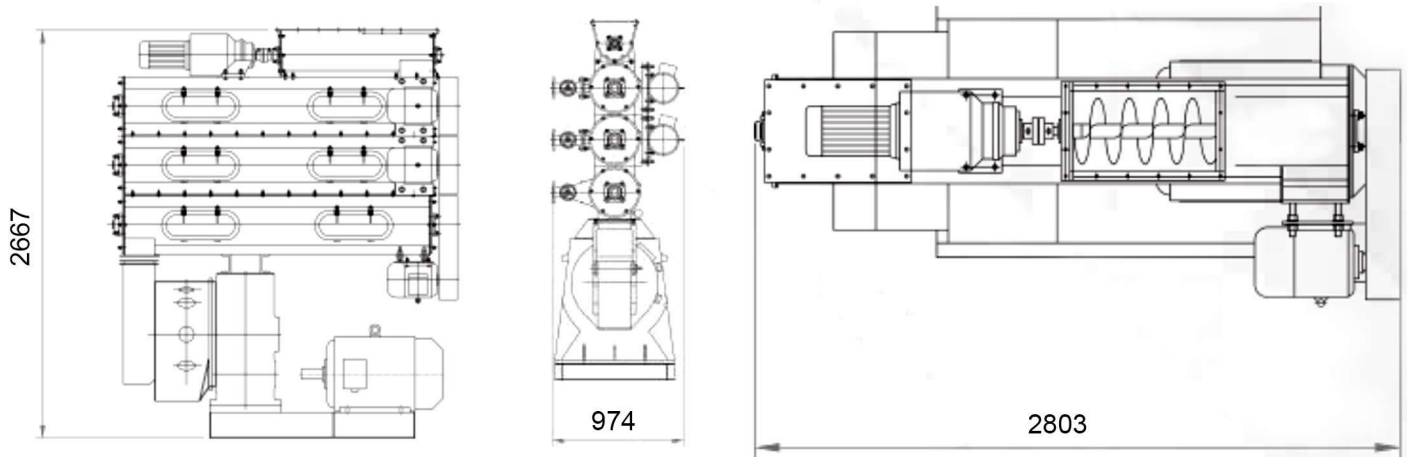

Detail Product :

- Ring Die Material : Stainless Steel
- Door Cover of Granulation Room : 6mm /SUS304
- Feed Chute : 3mm /SUS304
- Gear Box : HT250
- Gear : 42CrMo
- Gear Shaft : 20CrMnTi
- Spindle : 42CrMo
- Empty Shaft : 42CrMo
- Bearing : SKF
- Main Motor Series : 6-8P Using Siemens Motor

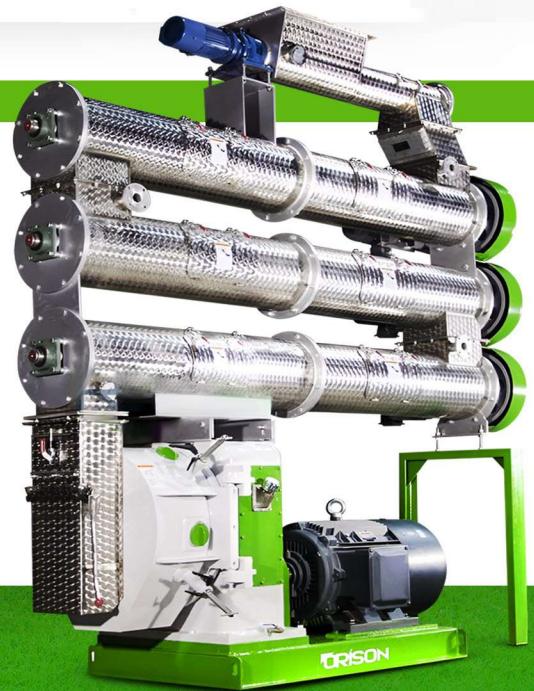

Product Specification

Model	Capacity	Main Motor Power	Forced Feeder	Conditioner Power	Ring Die Diameter	Finished Pellet Diameter
OSPM320	0.3~1 t/h	22 Kw	1.5 Kw	2.2 Kw	320 mm	1~13 mm
OSPM350	0.5~2 t/h	37 Kw	1.5 Kw	3 Kw	350 mm	1~13 mm
OSPM420	1.2~4 t/h	90 Kw	1.5 Kw	7.5 Kw	420 mm	1~13 mm
OSPM508	2.0-5 t/h	132 Kw	2.2 Kw	11 Kw	508 mm	1~13 mm
OSPM558	3.0~8 t/h	180/200 Kw	2.2 Kw	11 Kw	558 mm	1~13 mm
OSPM678	4.0~10 t/h	220/250 Kw	2.2 Kw	11 Kw	673 mm	1~13 mm
OSPM768	4.5~12 t/h	250/280 Kw	2.2 Kw	11 Kw	762 mm	1~13 mm
OSPM858	5.5~15 t/h	315/355 Kw	2.2 Kw	15 Kw	858mm	1~13 mm

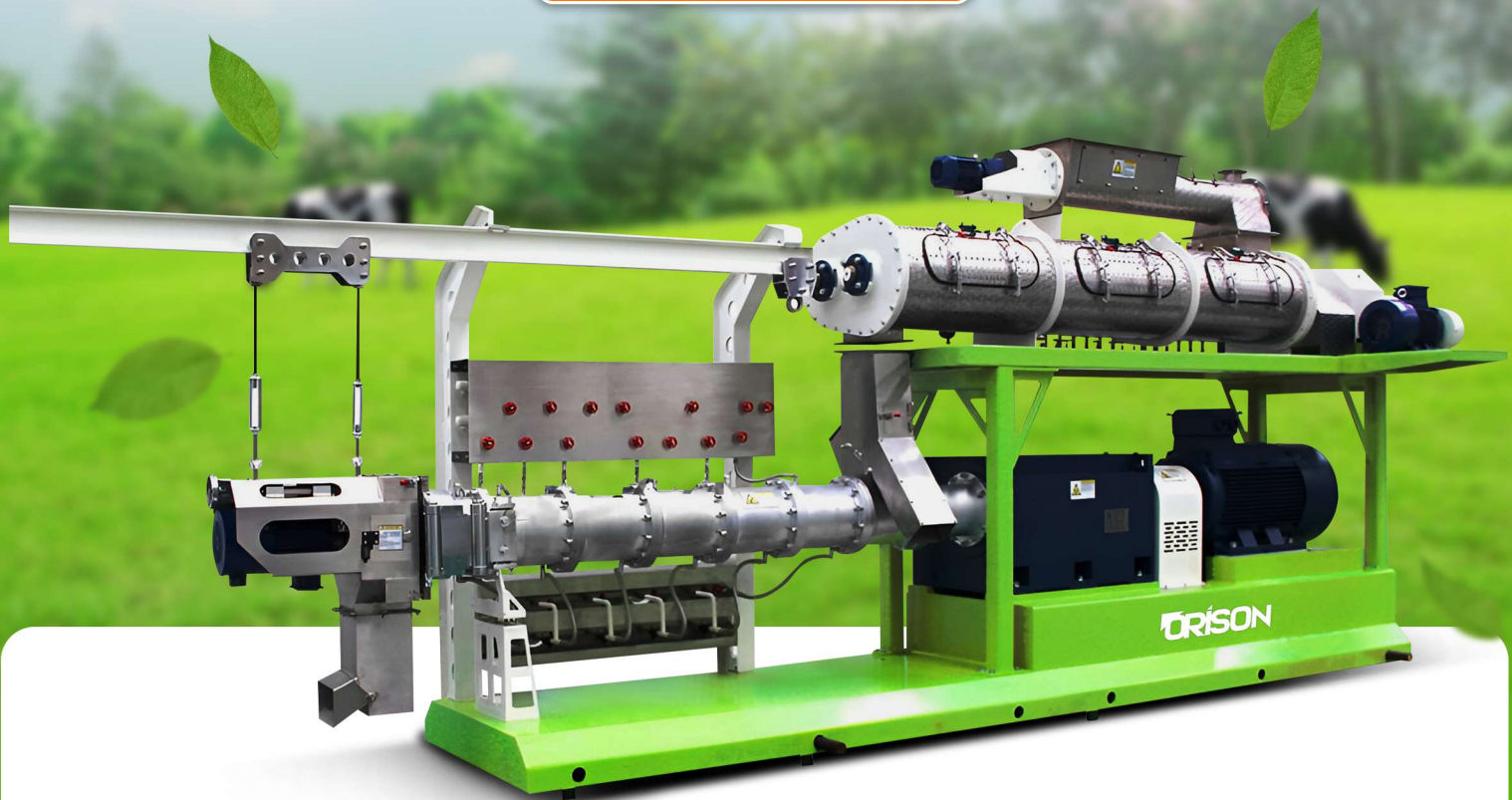

TYPE: OASE SERIES

BEST FOR FARM INDUSTRIES



Advanced
Technology



High Quality
Components



Stable &
High Durability



High Precision
Gear Rotation

AQUATIC SINGLE SCREW EXTRUDER

High-efficiency extruder is suitable for production high-grade floating or sinking aquatic feed, food, pet feed, etc. especially viscous formula materials.

1. Suitable for processing of various floating and sinking aquatic feed, suckling pig feed, pet feed, and food, etc.
2. Optional density adjustment system for processing sinking feed can increase productivity by 1.5 to 2 times.
3. Bearings in the transmission case adopt FAG or SKF bearings to ensure long-term stable operation.
4. Feeding system: unique designed bin without sediment, to ensure the smooth feeding, prevent caking and realize automatic feeding.

5. Fully utilize steam heat energy to replace mechanical energy, reduce electricity consumption per ton of material and increase capacity.

6. Fully automatic control system, realize one-man multi-machine control, improve labor productivity.



HIGH-EFFICIENCY EXTRUDER

TECHNICAL DRAWING

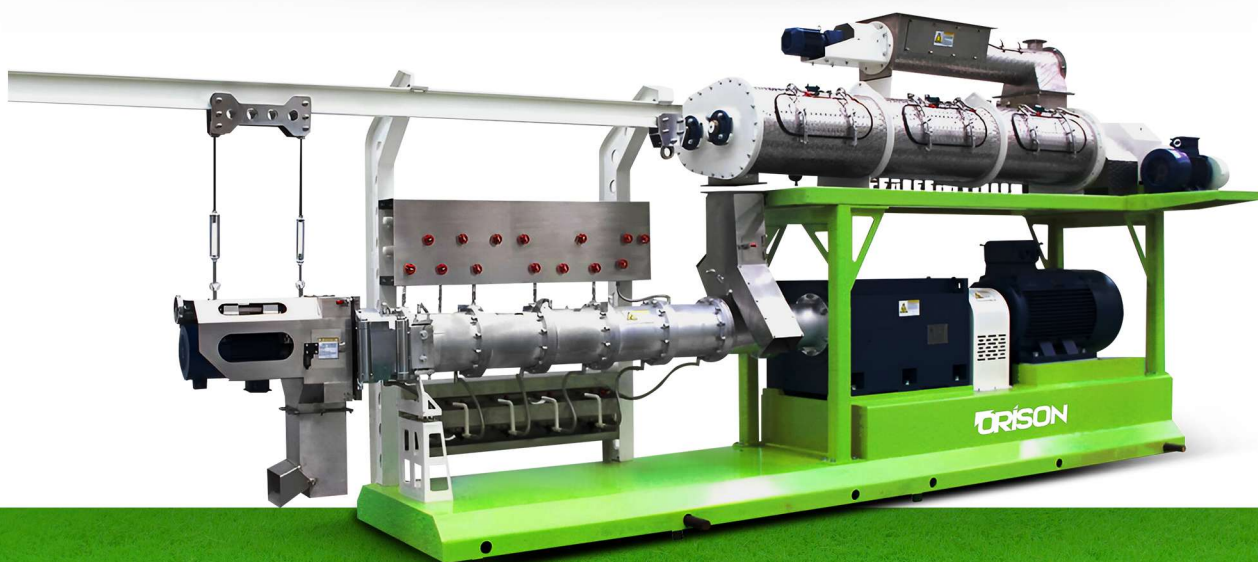
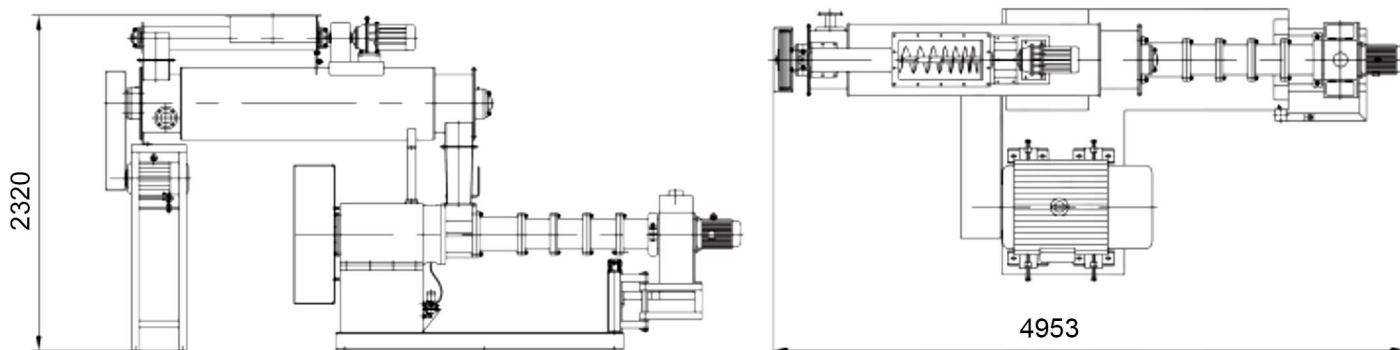

Product Specification

Model	Main Power	Dia. Of Screw	Capacity
OASE165	160/200 Kw	165 mm	3~4/4~5 t/h
OASE218	250/315 Kw	218 mm	6~8/8~10 t/h
OASE268	315/400 Kw	268 mm	10~12/12~14 t/h





Advanced
Technology



High Precision
Gear Rotation



High Quality
Components



Stable &
High Durability



BEST FOR FARM INDUSTRIES

TYPE: OHM SERIES

HAMMER MILL

is used by large and medium-sized livestock, poultry and aquatic feed enterprises to crush raw material, It is also suitable for fine crushing in the pharmaceutical industry. It can crush all kinds of granular materials, such as corn, sorghum, wheat, beans, crushed cake and other materials.

1. The efficient configuration of the crushing system makes the current of the crushing process fluctuate no more than 10%, and improves the utilization rate of kinetic energy (electric power).

2. Advanced water-drop crushing chamber design, reasonable secondary crushing structure, the capacity is increased by 25% compared with other models.

3. Patented shaft-end air intake system, the capacity of small size materials is increased by more than 20%.

4. Ultra-wide crushing working area, fully optimized arrangement of hammers, and the performance of micro crushing reaches a new high degree.

5. The rotor can work in forward and reverse directions, and the hammer has a longer service life.

6. Equipped with high-precision dynamic balance to detect the rotor, the equipment has low vibration, low noise and humanization.

7. The movable operation door and the linkage type screening device make the operation and maintenance more convenient.

8. Equipped with safety interlock device to protect personal safety.



TECHNICAL DRAWING

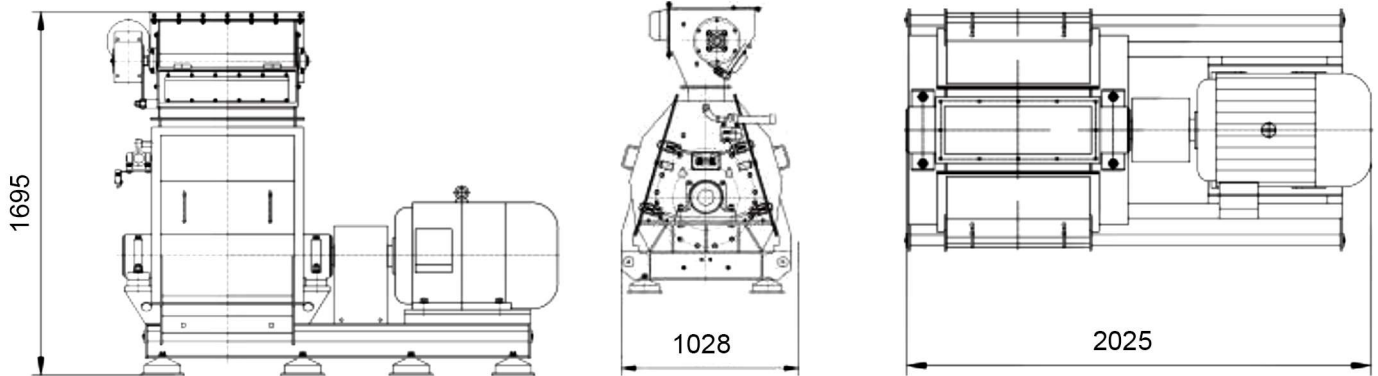

Detail Product :

- **Shell** : -10/Q235
- **Hammer Plate** : -10/Q235
- **Hammers** : -5/45#
- **Bearing** : SKF Bearing
- **Motor** : Using Siemens Motor

High efficiency Orison Hammer Mill is more suitable for fine crushing of raw materials. It consists of a rotating shaft with free-swinging hammers that impact the material, reducing it in size.



Product Specification

Model	Rotor Diameter	Crushing Chamber Width	Rotating Speed	Line Speed of Hammers	Power	Finished Pellet Diameter
OHM56*40	560 mm	400 mm	2980 Rpm	88 m/s	30/37 Kw	3~6 t/h
OHM66*60	660 mm	600 mm	2980 Rpm	103 m/s	55/75 Kw	5~8 t/h
OHM66*80	660 mm	800 mm	2980 Rpm	103 m/s	90/110 Kw	8~13 t/h
OHM66*100	660 mm	1000 mm	2980 Rpm	103 m/s	132 Kw	12~16 t/h
OHM138*30E	1380 mm	300 mm	1440 Rpm	103 m/s	110/132 Kw	15~20 t/h
OHM138*40E	1380 mm	400 mm	1440 Rpm	103 m/s	132/160 Kw	18~25 t/h



TYPE: ODRC SERIES

BEST FOR FARM INDUSTRIES



Advanced
Technology



High Quality
Components



Stable &
High Durability



High Precision
Gear Rotation

DOUBLE ROLLER CRUMBLER

Applicable to special equipment for breaking large particles into small particles in the production of poultry feed and aquatic products.

1. Imported parts, stable performance
It is widely used in the crushing of livestock and poultry pellets and aquatic pellets. The key parts are import, reliable in performance, and easy to operate and maintain.

2. Novel structure and high yield
Using the unique dual-roller differential tooth principle to achieve the crushing of $\phi 1.5 \sim 6.0$ mm granular material, high yield and less graded material return.

3. Optional

According to different crushing granularity requirements of users, special tooth-shaped crushing rollers can be equipped



STABLE & HIGH DURABILITY

TECHNICAL DRAWING

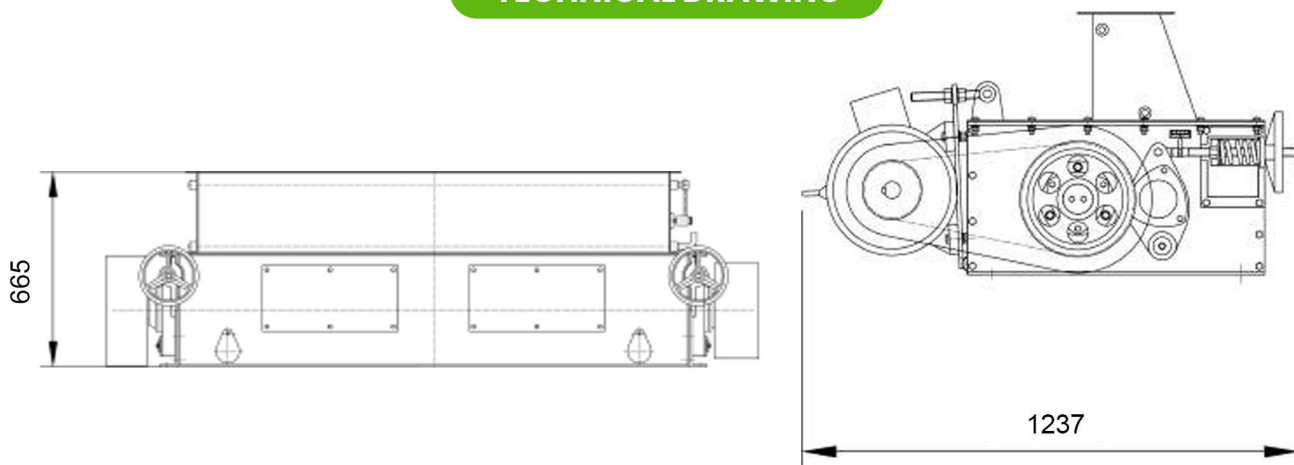

Detail Product :

- **Shell** : 6mm/Q235
- **Shell End Blade** : 10mm/Q235
- **Bearing** : SKF Bearing
- **Feed Roller Gear Motor** : Customized Brand

Product Specification

Model	Capacity	Power	Fast Roller Speed	Slow Roller Speed	Roll Specifications
ODRC15*80	2-4 t/h	4 Kw	725 Rpm	477 Rpm	φ150*800 mm
ODRC15*100	3-6 t/h	5.5 Kw	725 Rpm	477 Rpm	φ150*1000 mm
ODRC15*150	7-12 t/h	7.5 Kw	725 Rpm	477 Rpm	φ150*1500 mm
ODRC20*170	10-20 t/h	15 Kw	725 Rpm	477 Rpm	φ150*1700 mm



TYPE: OSDP SERIES

BEST FOR FARM INDUSTRIES

SINGLE SHAFT DOUBLE LAYER PADDLE MIXER

is equipped with a shell, machine cover, paddle shaft, discharge mechanism, motor reducer, transmission mechanism and air outlet.

1. Double-layer rotor design, mixing uniformity up to 97.7%, short mixing time.
2. Equipped with a large-section return air pipe to reduce dust and prevent materials from segregating, no residue.
3. Full-open discharge door, with smaller clearance between paddle and body shell design, zero leakage.
4. The discharge door is sealed with silica, and the shaft end is sealed with specially designed packing seal to ensure no leakage.

5. Oversized access door, reasonable design, convenient cleaning and maintenance, saving time.

6. The inspection door is equipped with a travel switch to protect personal safety.



STABLE & HIGH DURABILITY



LOW ENERGY CONSUMPTION

TECHNICAL DRAWING

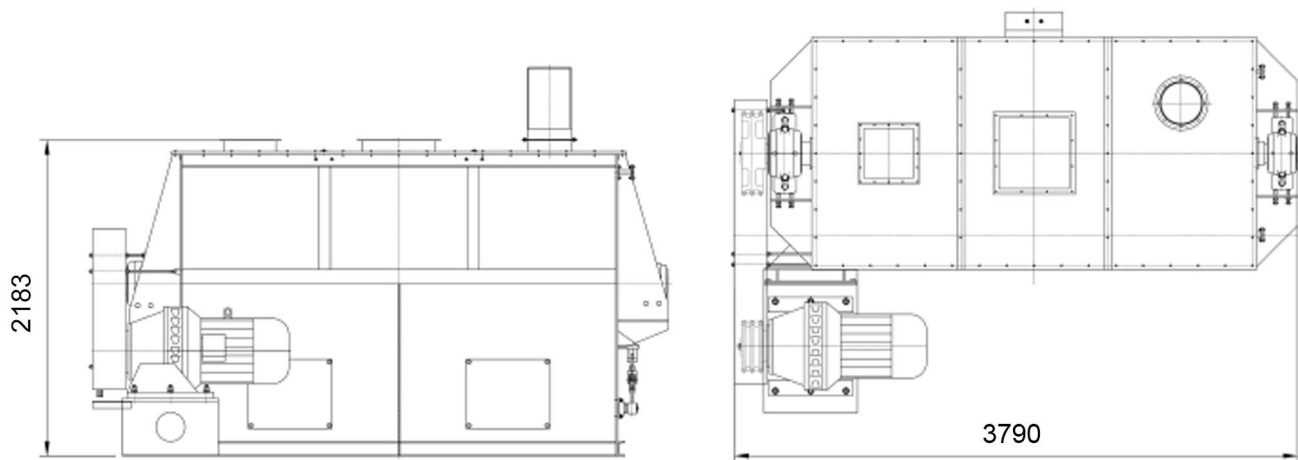

Detail Product :

- **Bearing** : SKF Bearing
- **Geared Motor** : Customized Brand
- **Shaft-Mounted Speed** : the speed reducer and the main shaft directly drive, the transmission efficiency is higher plough blade structure, low residue.

Product Specification

Model	Capacity	Material	Power	Mixing Amount Per Batch	Effective Volume
OSDP1A	Direct Connection	Carbon Steel	11 Kw	500 Kg/bat	1 m ³
OSDP1B	Direct Connection	Stainless Steel	11 Kw	500 Kg/bat	1 m ³
OSDP2A	Direct Connection	Carbon Steel	22 Kw	1000 Kg/bat	2 m ³
OSDP2B	Direct Connection	Stainless Steel	22 Kw	1000 Kg/bat	2 m ³
OSDP2L	Direct Connection	Carbon Steel	22 Kw	1000 Kg/bat	2 m ³
OSDP3A	Direct Connection	Carbon Steel	30 Kw	1500 Kg/bat	3 m ³
OSDP4L	Direct Connection	Carbon Steel	30 Kw	2000 Kg/bat	4 m ³
OSDP4A	Direct Connection	Carbon Steel	37 Kw	2000 Kg/bat	4 m ³
OSDP6A	Direct Connection	Carbon Steel	55 Kw	3000 Kg/bat	6 m ³



TYPE: OSDR SERIES

BEST FOR FARM INDUSTRIES



Advanced
Technology



High Quality
Components



Stable &
High Durability



High Precision
Gear Rotation

SINGLE SHAFT DOUBLE RIBBON MIXER

It is used to mix powdered materials to make the components of the mixture evenly distributed and ensure the quality of compound feed.

1. Suitable for mixing powdery, granular, flake and miscellaneous materials in feed, food, chemical, pharmaceutical, pesticide and other industries.

2. The mixing time of each batch is 3~6 minutes, especially suitable for mixing materials with more liquid mixture.

3. Grease feeding pipe is installed in the machine, the overall structure is reasonable, and the operation and maintenance are convenient.

4. With novel rotor structure, mixing uniformity variation coefficient $CV < 7\%$.

5. The shaft end and the discharge door adopt unique and mature sealing technology to ensure no leakage.

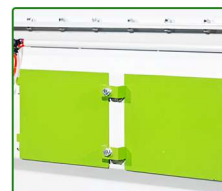

STABLE & HIGH DURABILITY

TECHNICAL DRAWING

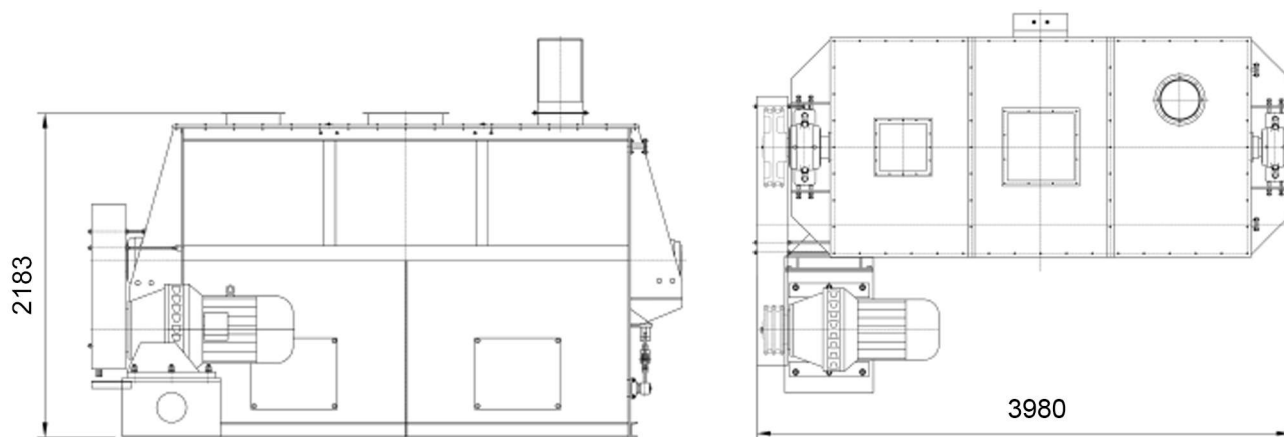

Detail Product :

- **Bearing** : SKF Bearing
- **Geared Motor** : Customized Brand
- **Door Opening Cylinder (With Magnetic Switch)** : High Quality Brand

Product Specification

Model	Power	Mixing Amount per Batch	Effective Volume
OSDR0.5A	4 t/h	250 Kg/bat (Manual Feeding)	0.5 m ³
OSDR1.0A	7.5 t/h	500 Kg/bat (Manual Feeding)	1 m ³
OSDR1.0A	7.5 t/h	500 Kg/bat (Pneumatic Feeding)	1 m ³
OSDR2.5L	18.5 t/h	1000 Kg/bat (Pneumatic Feeding)	2.5 m ³
OSDR5.0L	30 t/h	2000 Kg/bat (Pneumatic Feeding)	5 m ³



TYPE: ORHD SERIES

BEST FOR FARM INDUSTRIES



Advanced
Technology



High Quality
Components



Stable &
High Durability



High Precision
Gear Rotation

HORIZONTAL CIRCULATION DRYER

ORISON Horizontal Circulation Dryer is suitable for drying grain particles, aquatic feed, pet feed and other particulate matter.

1. Adopting imported PET woven mesh belt, high conveying and ventilation efficiency, drying efficiency increased by more than 25%, acid and alkali resistance, and no connection gaps, so the material does not get stuck on the breathable woven mesh or fall between the bottom plates, Feed pellets are absolutely not destroyed or deformed.

2. Circulation and reflux of dry hot air greatly improves heat exchange efficiency and saves a lot of steam energy. The drying time is adjusted by frequency conversion stepless adjustment, which is easy to control the moisture content of the product and reach the standard range.

3. Adopt swinging cloth distributor, the cloth is uniform and the moisture uniformity is good

4. According to user needs, an automatic temperature control device can be selected. The drying temperature control adopts a microcomputer PID automatic temperature control system and a proportional pneumatic control valve. The temperature control is accurate within 3°C. After the temperature is set, the amount of steam is automatically adjusted to effectively achieve the stability of the moisture content of the finished product and reduce unnecessary steam waste in the production process.



STABLE & HIGH DURABILITY



LOW ENERGY CONSUMPTION

TECHNICAL DRAWING

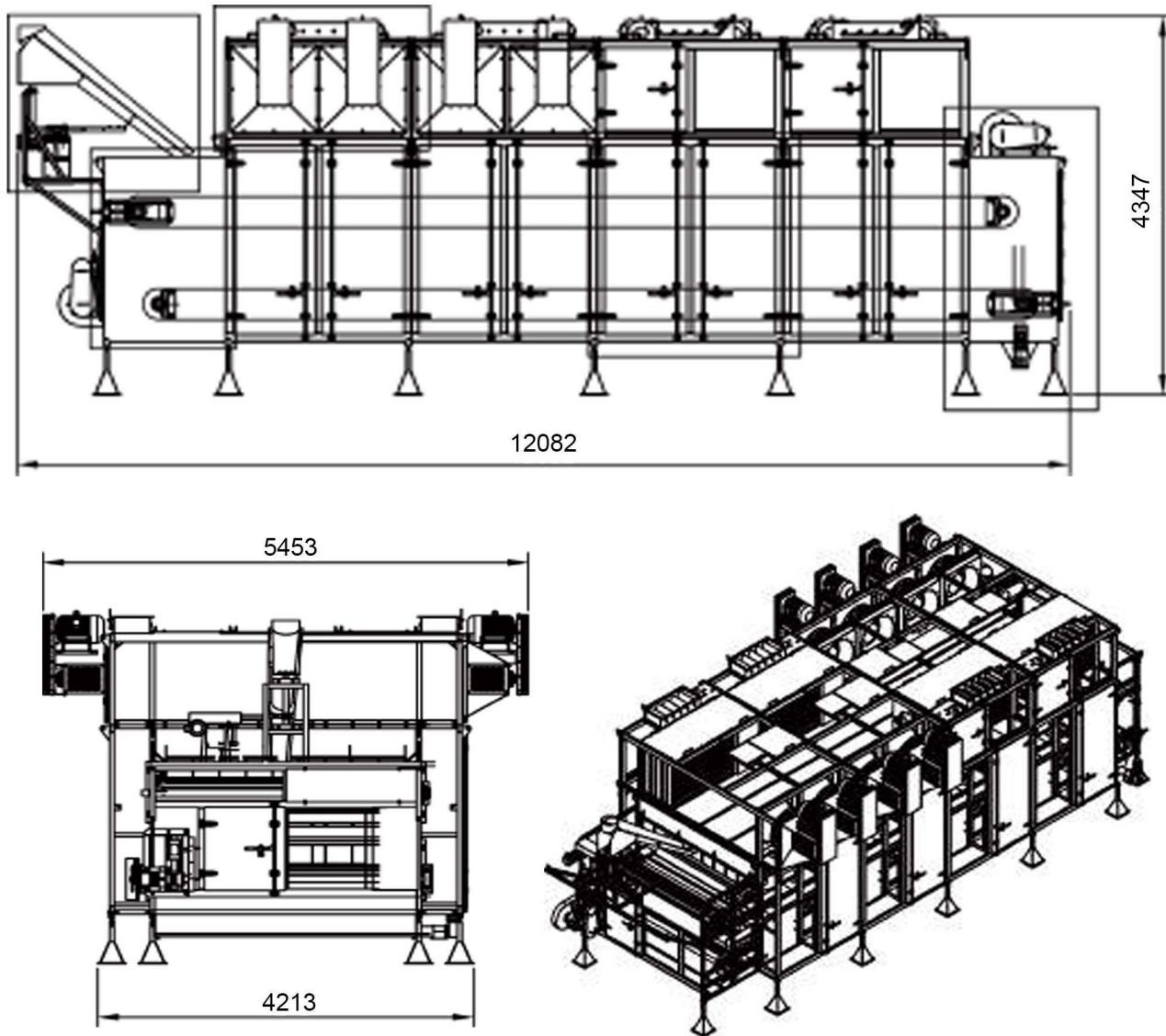

Product Specification

Model	Capacity	Required Steam	Unevenness of Material Drying	Total Power	Drying Sections
ORHD8000-4	3~5 t/h	0.8~1.5 Kw	$\leq 2\%$	46.85 Kw	4
ORHD8000-6	3~6 t/h	0.8~1.6 Kw	$\leq 2\%$	47.95 Kw	6
ORHD8000-8	4~8 t/h	1.1~2.1 Kw	$\leq 2\%$	62.85 Kw	8



Advanced
Technology



High Precision
Gear Rotation



High Quality
Components



Stable &
High Durability



TYPE: OCC SERIES

BEST FOR FARM INDUSTRIES

COUNTERFLOW COOLER

is widely applied in feed processing industry for cooling of all kinds of pellet materials.

1. Cooling performance is remarkable : Using the countercurrent cooling principle to cooling high temperature and high humidity particles, which can avoid the phenomenon of sudden cooling caused by direct contact between cold air and hot material, and thus prevent the surface cracking of particles. Meanwhile, the cooling effect is significant because of the use of closed air lock feeder and large air inlet area.

2. The use of sliding valve reciprocating discharge mechanism, stable movement, reliable, small residual.

3. Cooling box with octagonal shape, reduce dead Angle residue.

4. Advanced mechanical level control, high degree of automation.

5. The top of the cooler and the closed air lock feeder are made of stainless steel with strong corrosion resistance and long service life.

6. Adjustable Four - direction pellet distributor, uniform distribution.

7. The lower hopper are arc Angle, no residue.

8. Special requirements are available : Equipped with an electric rotating homogenizer (optional), so that the pellets in the machine are maintaining at the same level, more uniform cooling effect.



STABLE & HIGH DURABILITY



LOW ENERGY CONSUMPTION

TECHNICAL DRAWING

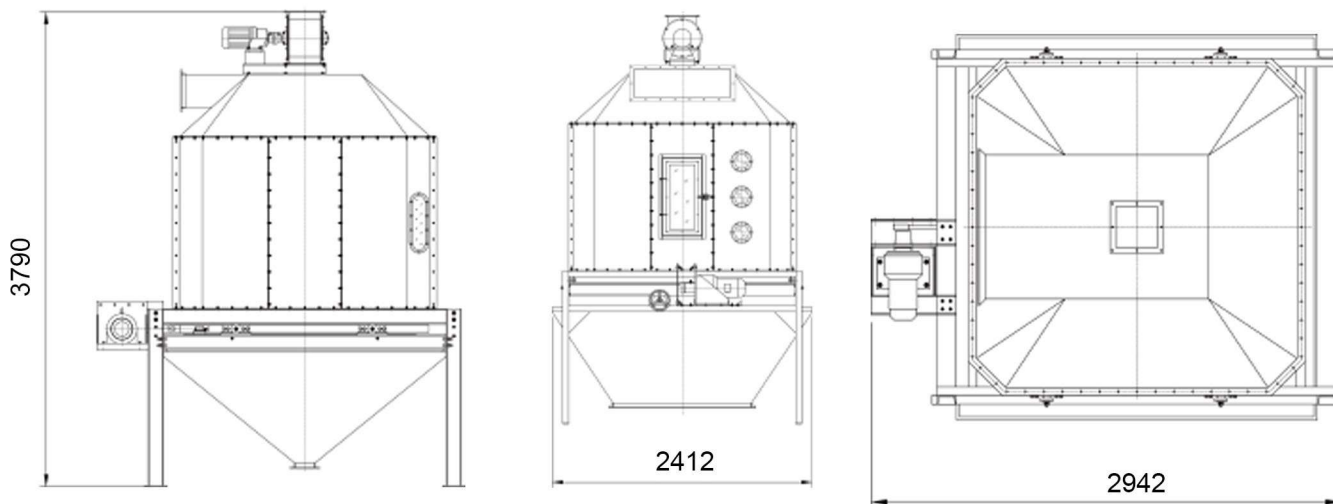

Detail Product :

ORISON Counterflow Cooler, advanced theory of counterflow cooling, ORISON Counterflow Cooler is widely applied in feed processing industry for cooling of all kinds of pellet materials.

- **Closed Air Lock Feeder** : 3mm Stainless Steel
- **Case** : -3/Q235 (Optional : 3mm Stainless Steel)
- **Discharging Mode** : Reciprocating Slide Valve
- **Material Leveler** : Mechanical



Product Specification

Model	Capacity	Power	Cooling Time	Suction Air	Temperature Of Material After Cooling
OCC11*11	1.5~2 t/h	0.75 Kw	6~15 min	750m ³ /h	Room Temperature +3~5°C
OCC14*14	3~5 t/h	1.5 Kw	6~15 min	750m ³ /h	Room Temperature +3~5°C
OCC17*17	5~8 t/h	1.5 Kw	6~15 min	750m ³ /h	Room Temperature +3~5°C
OCC20*20	9~12 t/h	1.5 Kw	6~15 min	750m ³ /h	Room Temperature +3~5°C
OCC24*24	13~18 t/h	1.5 Kw	6~15 min	750m ³ /h	Room Temperature +3~5°C



TYPE: ORS SERIES

BEST FOR FARM INDUSTRIES



Advanced Technology



High Quality Components



Stable & High Durability



High Precision Gear Rotation

ROTARY SCREENER

ORISON ORS series rotary screener, is a widely suitable for grain, feed, flour, chemical, food and many industry of high efficiency material grading screen equipment

1. Suitable for the classification and secondary circulation crushing process of granular materials and crushed materials, as well as the cleaning and grading treatment of some particles and powder materials. Adopt triangle belt transmission bias balance mechanism and elastic tail support mechanism, the material makes a rotary motion on the working surface of the horizontal rotary body, the screening accuracy is high, and the vibration is small.

2. No oil lubrication is needed to avoid oil leakage.

3. The streamlined design inside the discharge port prevents material from depositing and avoids cross contamination.

4. The screen pressing mechanism is firm and the screen changing is fast.

5. Two-layer sieve, three-layer sieve and two-layer sieve can be customized according to needs.

STABLE & HIGH DURABILITY



TECHNICAL DRAWING

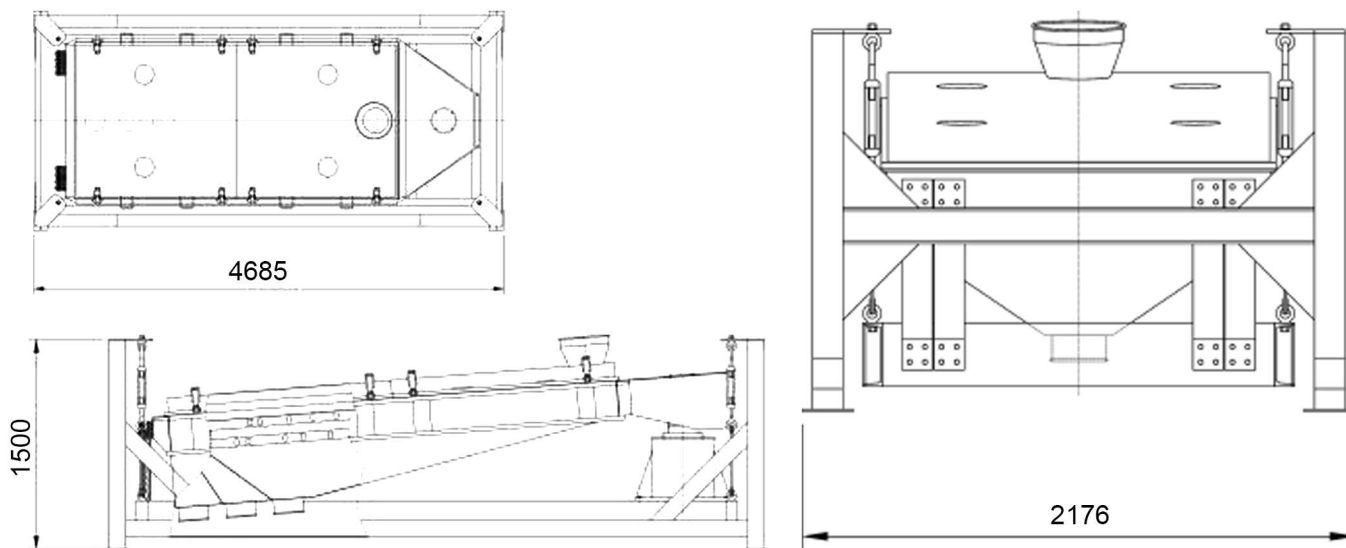

Detail Product :

Suitable for the classification and secondary circulation crushing process of granular materials and crushed materials, as well as the cleaning and grading treatment of some particles and powder materials.

- **Screen Ship Shell** : -3/Q235
- **Screen Ship Top Cover** : -2/Q235
- **Bearing** : SKF Bearing



Product Specification

Model	Power	Capacity	Size of Screen Surface	Turning Radius
ORS80*2C	1.5 Kw	3~8 t/h	2000*800 mm	25~35 mm
ORS100*2C/3C	2.2 Kw	8~10 t/h	2160*1000 mm	25~35 mm
ORS125*2C/3C	4 Kw	8~15 t/h	2400*1250 mm	25~35 mm
ORS150*2C/3C	5.5 Kw	15~20 t/h	3200*1500 mm	25~35 mm



STABLE & HIGH DURABILITY



LOW ENERGY CONSUMPTION



TYPE: OPS SERIES

BEST FOR FARM INDUSTRIES



Advanced
Technology



High Quality
Components



Stable &
High Durability



Excellent
Performance

POWDER SIEVE

ORISON OPS series Powder Sieve plays a pivotal role in the processing and refinement of agricultural materials. This specialized sieve is designed to sift powdered substances such as fertilizers, pesticides, or powdered feed additives, separating fine particles from coarse ones.

1. It is used for the cleaning of powdery materials, effectively crushing the clumps and separating stones in the powdery auxiliary materials. This machine can also be used for sieving the caked mixed materials.

2. It has the characteristics of high output, good cleaning effect, small power consumption, simple result, and small footprint.

3. The equipment is provided with an inspection door, which is convenient for daily maintenance and inspection, as well as easy replacement of the screen cylinder.

4. According to the nature of the material, suitable sieve holes can be selected to achieve a better separation effect.



STABLE & HIGH DURABILITY



TECHNICAL DRAWING

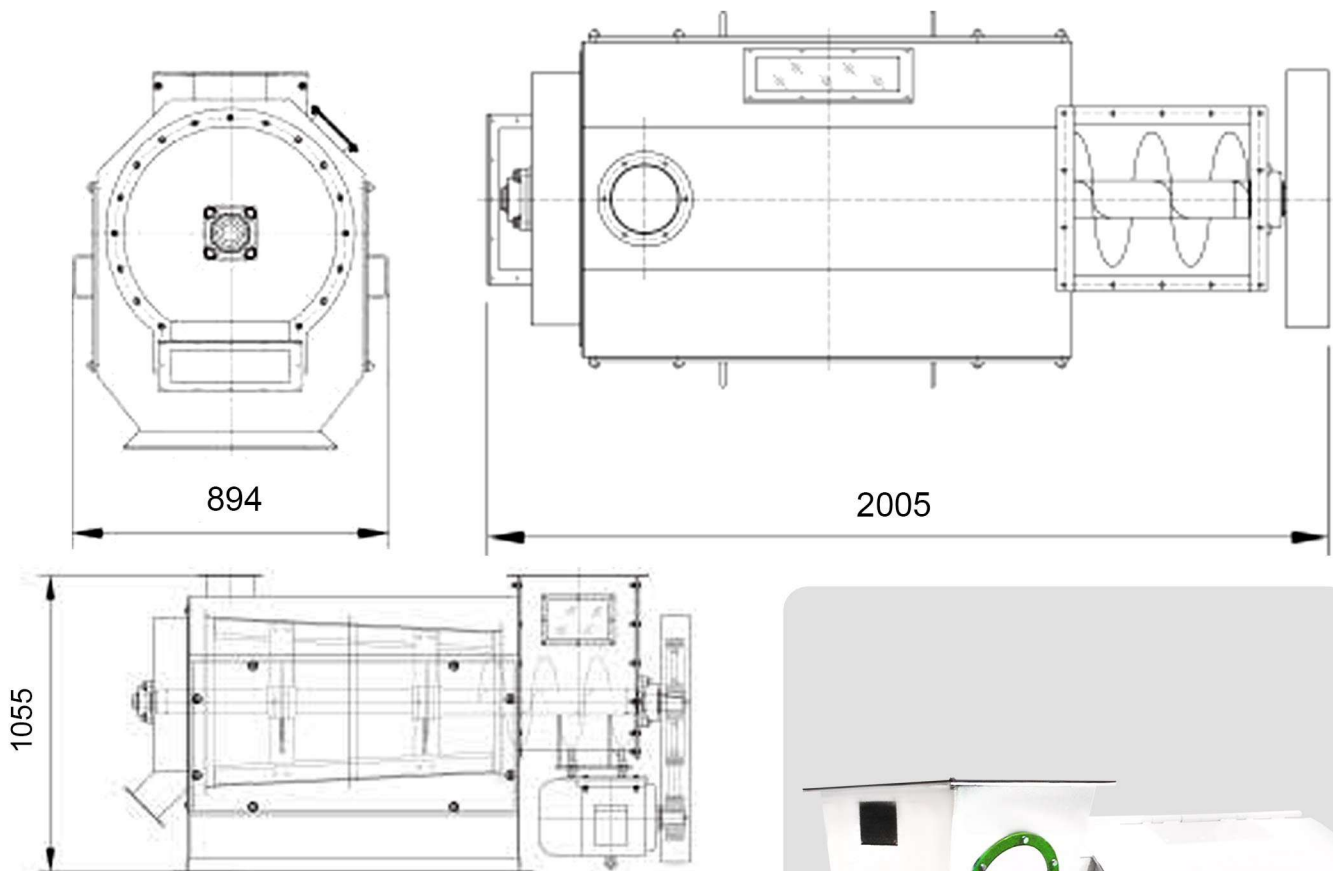

- **Shell** : -3/Q235
- **Screen Cylinder** : -5/Q235
- **Screen Hole Size** : $\phi 16$, $\phi 20$, $\phi 30$
- **Driven by Belt Pulley** : Stable Transimission
- **Motor** : Domestic High Quality or Imported Motor



Product Specification

Model	Screen Cylinder Specifications	Power	Screen Hole Diameter	Screen Cyinder Inclination	Capacity	Impurity Removal Rate
OPS60*50*100	$\phi 600 \times 800 \times 1000$ mm	5.5 KW	$\phi 16 \sim 30$ mm	3°	10~15 t/h	≥95%
OPS90*80*110	$\phi 800 \times 900 \times 1100$ mm	7.5 KW	$\phi 16 \sim 30$ mm	3°	40~50 t/h	≥95%



STABLE & HIGH DURABILITY



LOW ENERGY CONSUMPTION



TYPE: ODPc SERIES

BEST FOR FARM INDUSTRIES

DRUM TYPE PRECLEANER

is widely used in the raw material receiving part of flour mills, feed mills and other industries.

1. Applicable to the cleaning of raw grain in grain, feed processing, grain warehouse and other industries. It can clean wheat straw, corn leaves, corn cobs, straw, stones, hemp rope and other debris in raw grains such as corn, wheat, rice, soybean and so on.

2. High output, good cleaning effect, small power consumption, simple structure and small footprint.

3. Two quick-opening inspection doors are set up, which is convenient for daily maintenance and inspection, as well as easy replacement of screen cylinder.

4. Two observation windows are set on the side and top cover, which is convenient for observing the operation status of the equipment.

5. According to the nature of the material, suitable sieve holes can be selected to achieve a better separation effect.



STABLE & HIGH DURABILITY



LOW ENERGY CONSUMPTION

TECHNICAL DRAWING

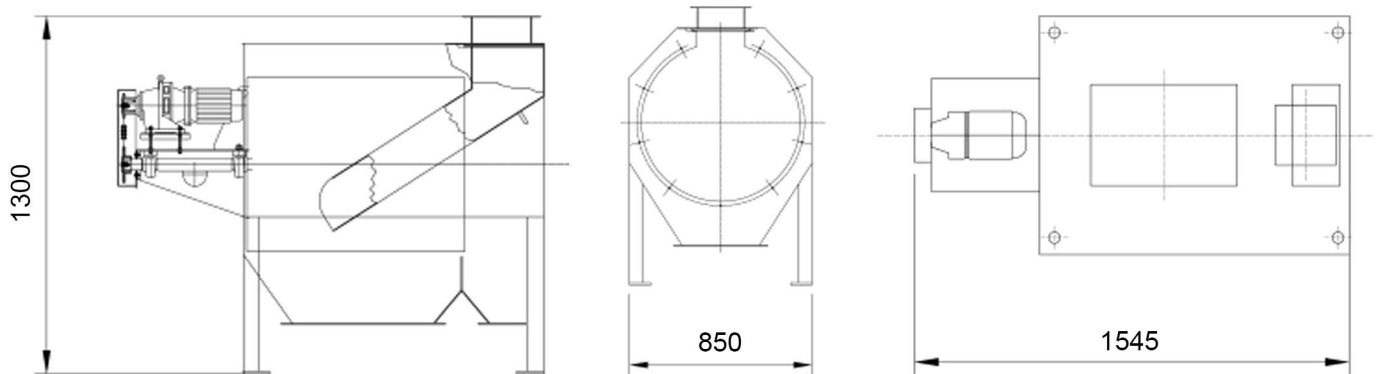

Detail Product :

ORISON Drum Type Precleaner is widely used in the raw material receiving part of flour mills, feed mills and other industries. Mainly used to remove large impurities such as straw, hemp rope, paper pieces, soil, corn leaves, corn on the cob and other debris to protect the machinery and equipment from failure or damage.

- **Shell** : -3/Q235
- **Rotary Drum** : -3/Q235
- **Screening Hole** : 20x20; 30x30
- **Bearing** : SKF Bearing
- **Gear Motor** : Custom Brand Gear Motor



Product Specification

Model	Power	Capacity	Rotary Screen Rotate Speed	Dimension
ODPC63	0.75 Kw	15~30 t/h	21 Rpm	25~35 mm
ODPC80	0.75 Kw	20~40 t/h	17 Rpm	25~35 mm
ODPC100	1.5 Kw	30~50 t/h	12 Rpm	25~35 mm



STABLE & HIGH DURABILITY



LOW ENERGY CONSUMPTION



Advanced
Technology



High Precision
Gear Rotation



High Quality
Components



Stable &
High Durability



TYPE: OPM SERIES

BEST FOR FARM INDUSTRIES

PERMANENT MAGNET

is mainly used to separate the magnetic metal included in the raw materials. It is suitable for feed plants, grain and oil processing plants, solvent plants and brewing plants of various sizes.

1. Strong separation of magnetic metal inclusions in raw materials.
2. The magnetic core is made of newly developed rare-earth permanent magnet material, the magnetic field strength is >3000GS, and the iron removal efficiency is >99%
3. Without power, the comprehensive performance reaches the international advanced level.



STABLE & HIGH DURABILITY



LOW ENERGY CONSUMPTION

TECHNICAL DRAWING

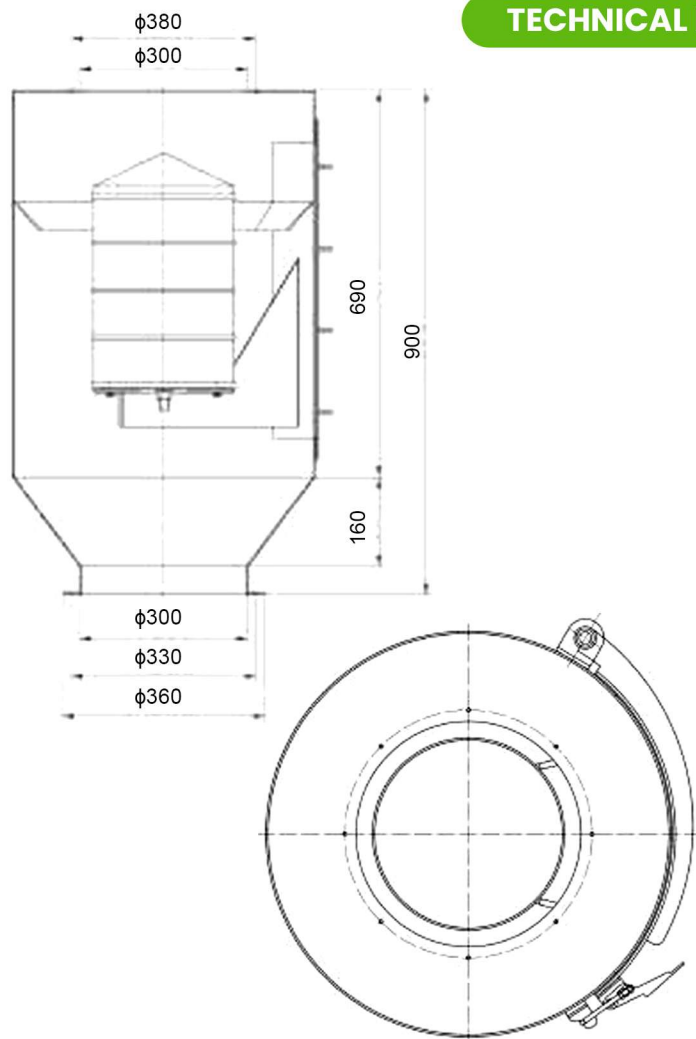

- Shell : -4/304
- Magnetic Field Intensity : $\geq 3000\text{GS}$

Product Specification

Model	Power	Capacity Powdery/Granules	Magnetic Induction on the surface of the cylinder	Iron Removal Rate
OPM20	200 Kw	25/30 t/h	≥ 3000	$\geq 99\%$
OPM25	250 Kw	35/50 t/h	≥ 3000	$\geq 99\%$
OPM30	300 Kw	45/70 t/h	≥ 3000	$\geq 99\%$



STABLE & HIGH DURABILITY



LOW ENERGY CONSUMPTION



Advanced
Technology



High Quality
Components



High Precision
Gear Rotation



Stable &
High Durability



TYPE: OPDC SERIES

BEST FOR FARM INDUSTRIES

PULSE DUST COLLECTOR

ORISON pulse dust collector are applicable to stand-alone or centralized air suction and dust removal or recycling filtration in grain processing, feed pellets, machinery, building materials and cement industries

1. The body is a square structure, the filter bag is a round cloth bag.
2. A special big compressed air bag is directly connected with the solenoid valve, the compressed air supply is sufficient, the work is stable and reliable, and the sealing performance is good.
3. Large processing air volume, small footprint and low noise.

4. Large filtering area and high dust removal efficiency (299.9%).

5. Pressure gauges and vents can be set according to customer needs.



STABLE & HIGH DURABILITY

TECHNICAL DRAWING

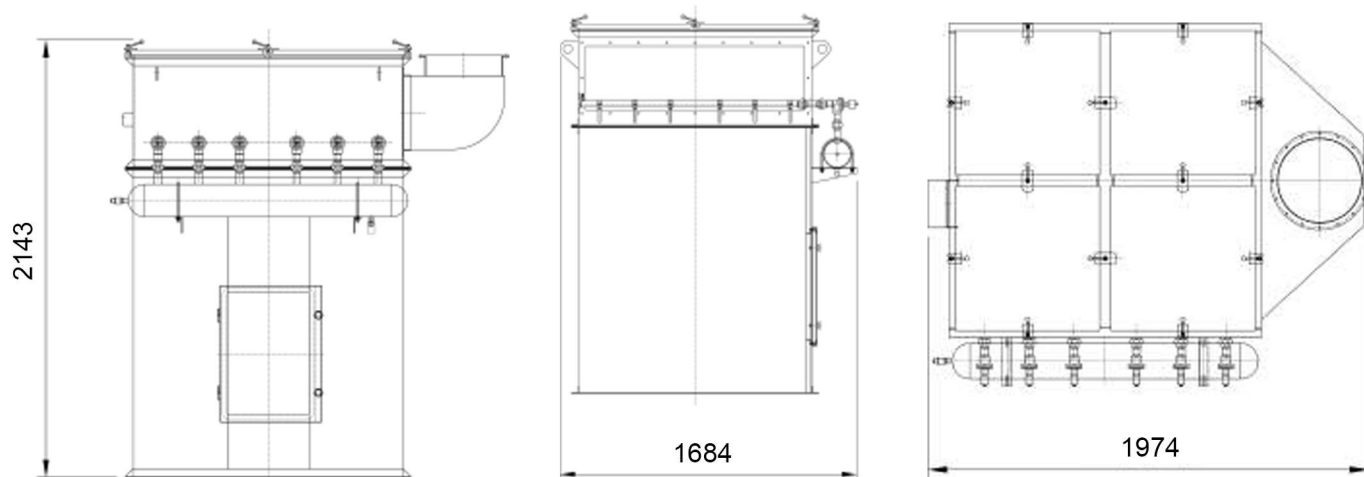

Detail Product :

- **Shell** : -3/Q325
- **Solenoid Valve** : Large-caliber brand
- **Filtrering Bag** : Needle Felt Filter Bag
- **Solenoid Valve Voltage** : DC24V
- **Solenoid Valve Current** : 0.8 -1 A
- **Temperature** : -20~50°C



Product Specification

Model	Fan Power	Filtering Area	Air Volume
OPDC4A	0.75 Kw	2 m ²	240-480 m3/h
OPDC6A	1.5 Kw	3 m ²	360-720 m3/h
OPDC8A/B	1.5 Kw	4 m ²	480-960 m3/h
OPDC12A/B	2.2 Kw	6 m ²	720-1440 m3/h
OPDC18A/B	3 Kw	9 m ²	1080-2160 m3/h
OPDC24A/B	5.5 Kw	12 m ²	1440-2880 m3/h
OPDC36A/B	11 Kw	18 m ²	2160-4320 m3/h
OPDC48A	15 Kw	24 m ²	2880-5760 m3/h

TYPE: OAPS SERIES

BEST FOR FARM INDUSTRIES

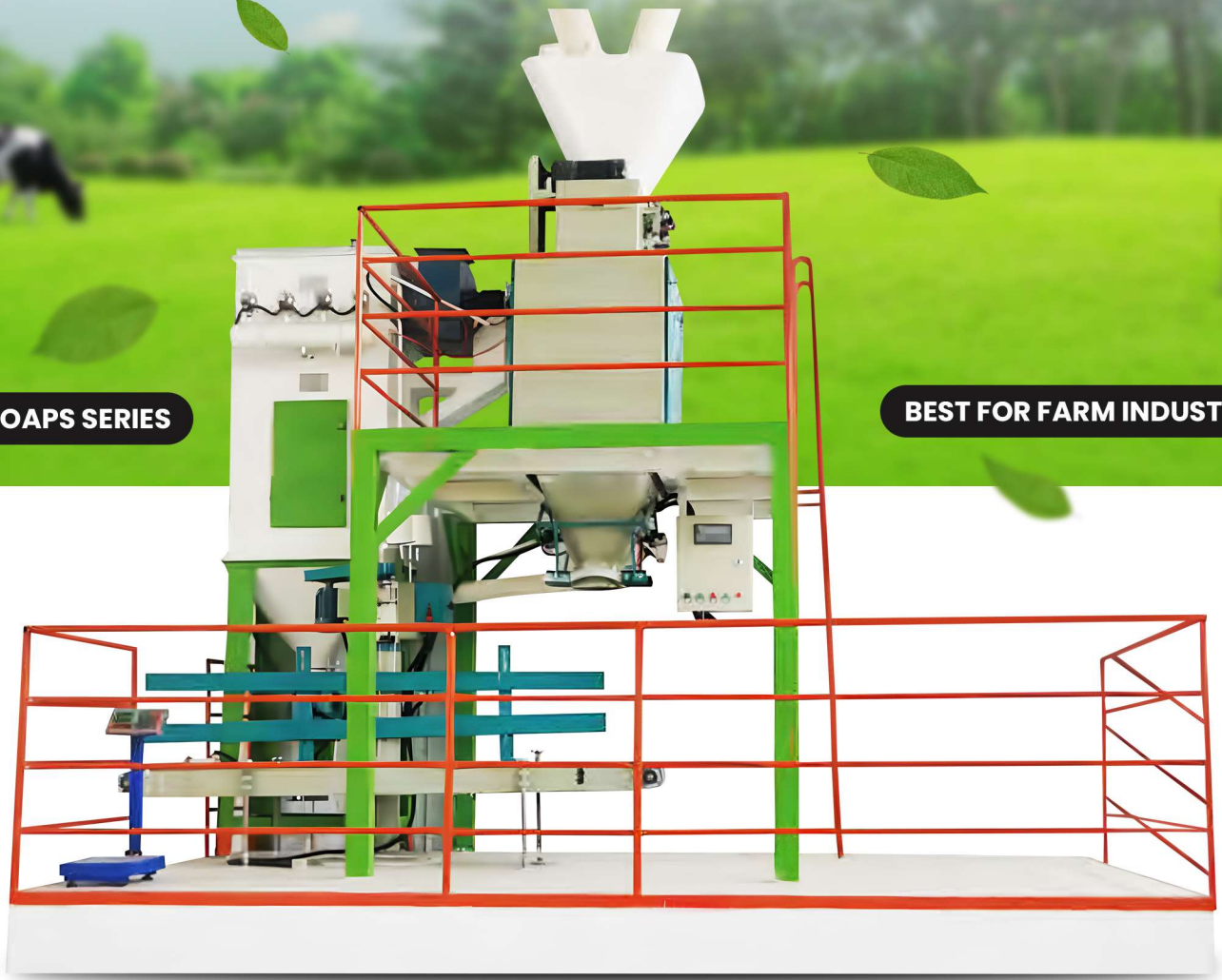

AUTOMATIC PACKING SYSTEM

ORISON Automatic Packing System It is a professional quantitative weighing and packaging equipment. High packing accuracy is high, Fast packing speed and high efficiency

1. The system is suitable for the particle material and powder material with good fluidity. If the material is corrosive, the parts contacting with the material should be made of stainless steel.

2. Adopt no-weighing-hopper structure that can reduce the height, thus the structure is more compact and easy to install. Also it can reduce the dust.

3. Apply digital intelligent weighing control instrument, which has high accuracy, fast speed, stable and reliable running, easy to operate.

4. The instrument has many functions, such as auto tare, zero tracking, out-of-tolerance alarm, communication, gross weight weighing, net weight and bag number count etc.

5. Reasonable design, convenient operation and labor saving.

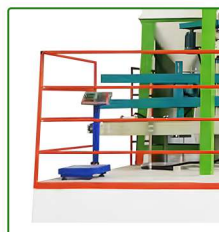

STABLE & HIGH DURABILITY

TECHNICAL DRAWING

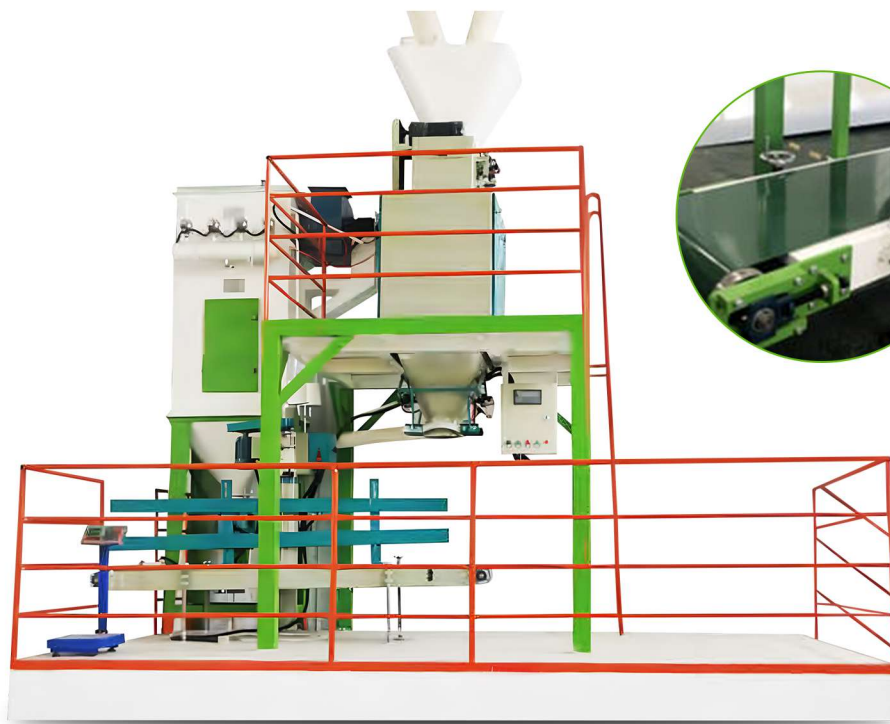

Whether the weighing and packaging of feed pellets is accurate or not is directly affected the reputation and economic benefits of the feed pelletizing plants.

The automatic feed pellet weighing and packaging system can perfectly ensure dynamic weighing accuracy, it is popular with more and more feed pellet processing plants.

Product Specification

Model	Application	Feeding Method	Speed (Bags/Min)	Powder	Precision	Temperature Range
OAPS-C50/D	Pellet	Gravity	6~8	1.1 Kw	Static+0.1% Dynamic+0.2%	-10~40°C
OAPS-A50/D	Powder	Screw	6~8	3 Kw	Static+0.1% Dynamic+0.2%	-10~40°C
OAPS-B50/D	Pellet/Powder	Belt	6~8	3 Kw	Static+0.1% Dynamic+0.2%	-10~40°C
OAPS-B50/S	Pellet/Powder	Belt	10~12	5 Kw	Static+0.1% Dynamic+0.2%	-10~40°C
OAPS-150/Y	Premix	Screw	6~8	3 Kw	Static+0.1% Dynamic+0.2%	-10~40°C



Advanced
Technology



High Precision
Gear Rotation



High Quality
Components



Stable &
High Durability

TYPE: ORD SERIES

BEST FOR FARM INDUSTRIES

ROTARY DISTRIBUTOR

is a set of control and management in the integration of intelligent computer batching system, superior performance, stable and reliable, and can be widely used in flour, feed, fertilizer, construction and other industries of batching control.

1. Mechanical self-locking structure, orientation and bend positioning accurate and reliable. Automatic cleaning machine, dust, the structure is compact.
2. Small occupation space, easy maintenance.
3. It is widely used in various mixing tank at the top of the material assigned.



LOW ENERGY CONSUMPTION



STABLE & HIGH DURABILITY



ORISON Rotary Distributor is a set of control and management in the integration of intelligent computer batching system, superior performance, stable and reliable, and can be widely used in flour, feed, fertilizer, construction and other industries of batching control.

Product Specification

Model	Power	Distributor Speed	Outlet Diameter	Weight
ORD4	0.55 Kw	1.5 Rpm	φ219;φ250	190 Kg
ORD6	0.55 Kw	1.5 Rpm	φ219;φ250	230 Kg
ORD8	0.55 Kw	1.5 Rpm	φ219;φ250	296 Kw
ORD10	0.55 Kw	1.5 Rpm	φ219;φ250	350 Kw



Advanced
Technology



High Precision
Gear Rotation



High Quality
Components



Stable &
High Durability



TYPE: OLAS SERIES

BEST FOR FARM INDUSTRIES

LIQUID ADDING SYSTEM

1. It is suitable for adding fats, molasses, phospholipids and other nutrients to the batch mixer, with a wide range of adaptation.

2. An indispensable link in feed processing, which can improve feed quality and processing performance.

3. High accuracy, reliable use, easy operation and maintenance.

4. There is a heating system in the tank, and the upper and lower liquid levels can be automatically controlled and monitored.

5. Equipped with various reliability electric liquid pumps for a variety of liquids, and has a good shaft seal.



LOW ENERGY CONSUMPTION





LOW ENERGY CONSUMPTION



STABLE & HIGH DURABILITY



Product Specification

Model	Add Flow Rate	Power	Add Precision
OLAS50A	50 L/min	2.2 Kw	0.5 %
OLAS100A	100 L/min	3 Kw	0.5 %
OLAS150A	150 L/min	5.5 Kw	0.5 %
OLAS200A	200 L/min	5.5 Kw	0.5 %

1. It is suitable for adding fats, molasses, phospholipids and other nutrients to the batch mixer, with a wide range of adaptation.
2. indispensable link in feed processing, which can improve feed quality and processing performance.
3. High accuracy, reliable use, easy operation and maintenance.
4. The heating system in the tank, and the upper and lower liquid levels can be automatically controlled and monitored.
5. Equipped with various reliability electric liquid pumps for a variety of liquids, and has a good shaft seal.



Advanced
Technology



High Quality
Components



High Precision
Gear Rotation



Stable &
High Durability

TYPE: OBE SERIES

BEST FOR FARM INDUSTRIES

BUCKET ELEVATOR

ORISON Bucket Elevator is a kind of fixed conveying equipment. It is designed and manufactured with new technology and new materials. It has novel appearance, safe operation, simple structure, high output, good sealing performance, less material residue, low noise, flexible process arrangement. It is widely used for vertical lifting of particulate and powdery materials in grain, oil, food, feed and chemical industries.

Model	Power	Capacity
OBE36/18	≤4 Kw	6~15 t/h
OBE36/28	≤7.5 Kw	15~30 t/h
OBE40/23	≤11 Kw	25~35 t/h
OBE50/28	≤22 Kw	50~70 t/h
OBE63/28	≤37 Kw	80~100 t/h



LOW ENERGY CONSUMPTION



STABLE & HIGH DURABILITY

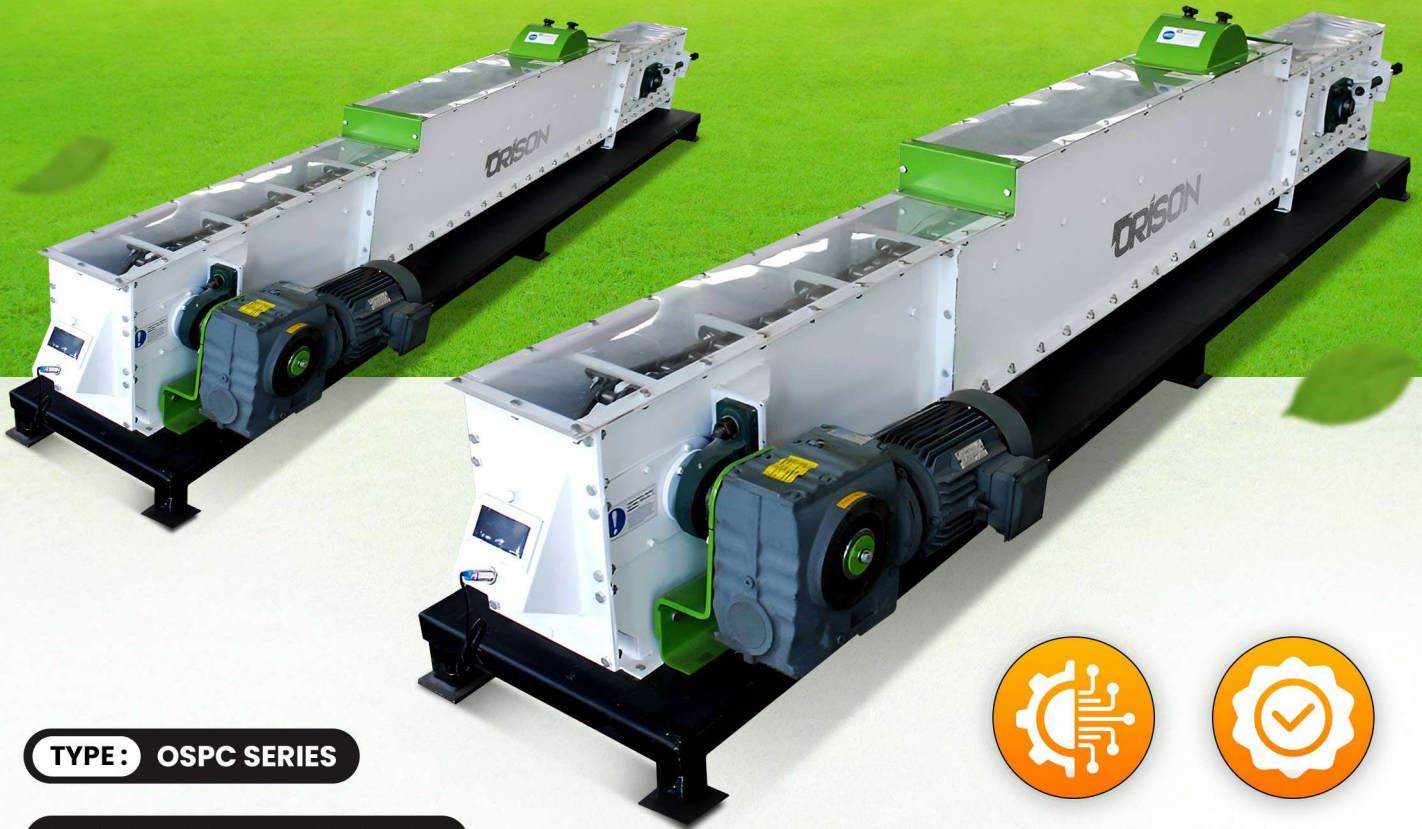

TYPE: OSPC SERIES

BEST FOR FARM INDUSTRIES



Advanced
Technology



High Quality
Components

SCRAPER CONVEYOR

ORISON Scraper Conveyor is a kind of continuous conveying equipment for bulk materials in enclosed rectangular section shell by means of moving scraper chain. It is mainly used for conveying powder, granular and small pieces of materials. It can be widely used in the horizontal transportation of bulk materials in feed factories, flour factories, rice factories, oil factories, starch factories, grain depots, port terminals and so on.

Model	Capacity	Scraper Chain Distance
OSPC16	15~20 t/h	66.75 mm
OSPC20	20~40 t/h	66.75 mm
OSPC25	40~70 t/h	66.75 mm
OSPC32	70~140 t/h	66.75 mm
OSPC40	140~210 t/h	125 mm

TYPE: OSRC SERIES

BEST FOR FARM INDUSTRIES

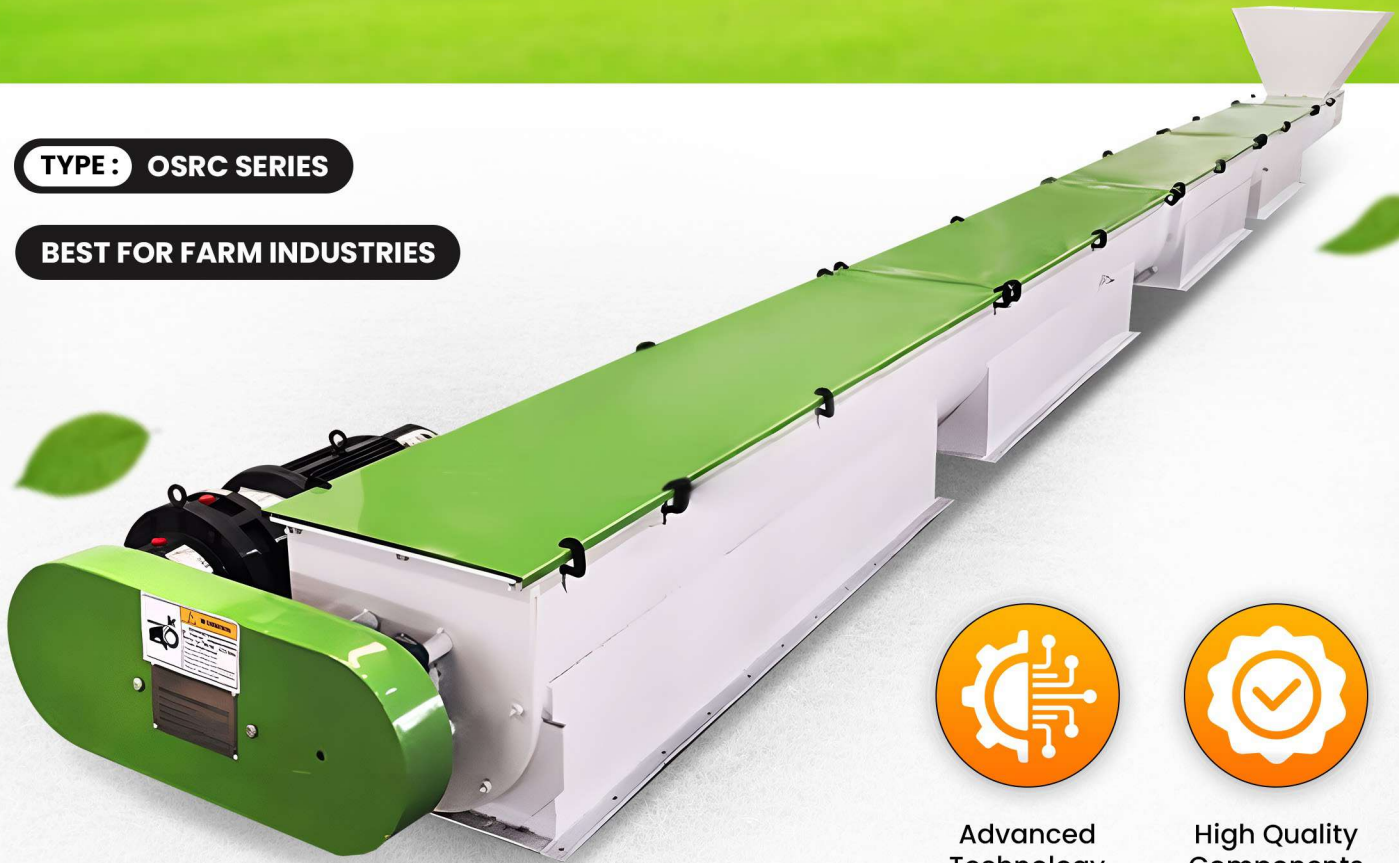

Advanced
Technology



High Quality
Components

SCREW CONVEYOR

ORISON Screw Conveyor is suitable for grain, feed and other granular or powdery horizontal transport. Mainly used for short distance transport. with high quality component & advanced technology, so the ORISON Screw Conveyor has high durability, is stable and easy to operate & maintenance.

Model	Capacity	Screw Diameter
OSRC16	5~15 t/h	160 mm
OSRC20	15~25 t/h	200 mm
OSRC25	30~50 t/h	250 mm
OSRC32	50~80 t/h	320 mm
OSRC40	80~120 t/h	400 mm

PNEUMATIC GATE VALVE

TYPE: OPGV SERIES

BEST FOR FARM INDUSTRIES

1. Adopt cylinder moving, convenient operation, high sensitivity.
2. Adopt high strength nylon roller, small resistance.
3. New type sealing device, ensure no leakage material.

 **STABLE & HIGH DURABILITY**



PNEUMATIC THREE WAY

TYPE: OPTW SERIES

BEST FOR FARM INDUSTRIES

1. Applicable to the feed, flour, food, chemical, mining, metallurgy, cement and other industries control material flow.
2. Adopt cylinder or manual push, clean, clean.
3. Good in sealing, is not easy to leak.
4. Simple structure, convenient installation.

 **STABLE & HIGH DURABILITY**



BEST FOR FARM INDUSTRIES

AIR LOCK

is mainly used for unloading materials, and the packing and unloading place is tightly airtight to ensure the normal discharge of the unloader. Closed rotor, close wind, flexible action, ORISON specially designed, with good airproof performance.



 LOW POWER CONSUMPTION

 STABLE & HIGH DURABILITY



BEST FOR FARM INDUSTRIES

DRAUGHT FAN



ORISON Draught Fan has a good pneumatic type, and the impeller and the pulley are corrected by strict static and dynamic balance, so the operation is stable, the vibration is small, the efficiency is high, and the life is long.

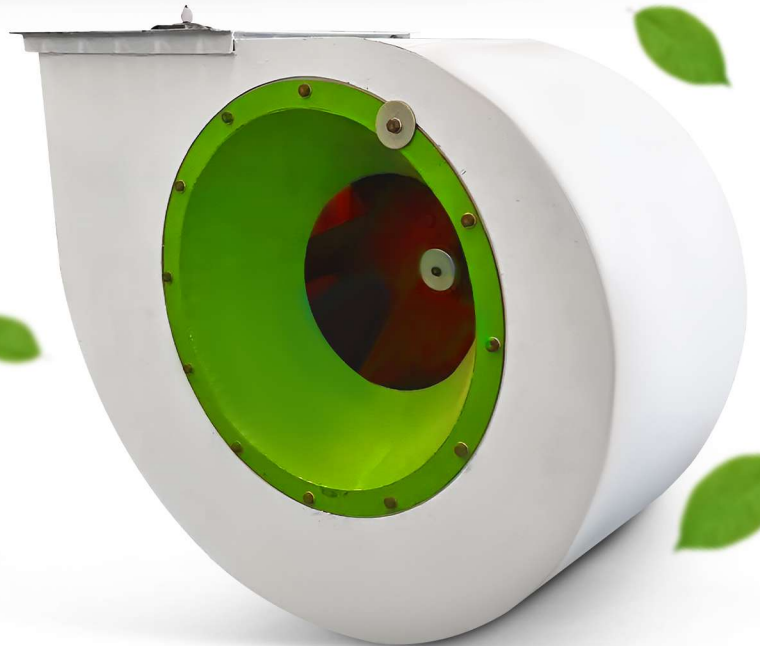

 LOW POWER CONSUMPTION

 STABLE & HIGH DURABILITY





TYPE: OBPM SERIES

BEST FOR FARM INDUSTRIES

BIOMAS PELLETER

is mainly suitable for various crop wastes, economic crop wastes and raw wood materials such as wood chips, straw, rice husks, peanut shells, coconut shells, palm shells, etc.



LOW POWER CONSUMPTION

1. The main transmission adopts high-precision gear rotation, and the efficiency is increased by about 15% compared with the belt transmission type, and the ring mold adopts the quick-release type hoop type.
2. High-quality imported bearings and oil seals are used in the transmission part of the whole machine to ensure efficient, stable and low noise
3. The international advanced level compensation serpentine spring coupling has the characteristics of novel structure, compact, safe, low failure and so on.



STABLE & HIGH DURABILITY

4. Strengthen the working strength of the main working parts from the materials, heat treatment and other processes to meet the granulation requirements of biomass particles.
5. There are a number of innovative designs on the ring die, mainly to improve the problems of the ring die to prevent cracking, increase in output and increase in total output.
6. Configured with overload protection device to increase the service life of equipment.
7. Door is made by stainless steel material, durable use.

TECHNICAL DRAWING

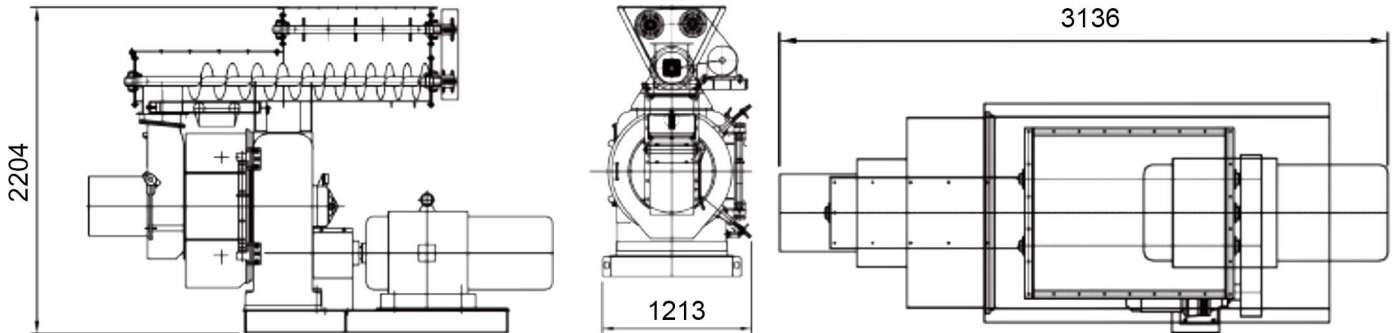

Detail Product :

- **Ring Die Material** : Stainless Steel
- **Feeder** : Anti-caking Function
- **Door of Pelleting Room** : 6mm / SUS304
- **Forced Feeding** : Worm Gear Reducer
- **Gear Box** : HT250
- **Gear** : 42CrMo
- **Gear Shaft** : 42CrMo
- **Spindle** : 42CrMo
- **Empty Shaft** : 42CrMo
- **Bearing** : SKF



Product Specification

Model	Capacity	Main Motor Power	Main Motor Series	Ring Die Diameter	Finished Pellet Diameter
OBMP320	0.3~0.5 t/h	22 Kw	6/8P	320 mm	6~12 mm
OBMP350	0.5~0.7 t/h	37 Kw	6/8P	350 mm	6~12 mm
OBMP420	0.8~1.5 t/h	90 Kw	6/8P	420 mm	6~12 mm
OBMP520	2~2.5 t/h	132 Kw	6/8P	520 mm	6~12 mm
OBMP768	2.5~4 t/h	250 Kw	6/8P	762 mm	6~12 mm
OBMP858	4~5 t/h	280 Kw	6/8P	858 mm	6~12 mm



TYPE: OOFM SERIES

BEST FOR FARM INDUSTRIES

ORGANIC FERTILIZER PELLET MACHINE



LOW POWER CONSUMPTION

1. The main transmission adopts high-precision gear rotation, and the efficiency is increased by about 15% compared with the belt transmission type, and the ring mold adopts the quickrelease type hoop type.

2. High-quality imported bearings and oil seals are used in the transmission part of the whole machine to ensure efficient, stable and low noise.

3. The international advanced level compensation serpentine spring coupling has the characteristics of novel structure, compact, safe, low failure and so on.



STABLE & HIGH DURABILITY

4. Strengthen the working strength of the main working parts from the materials, heat treatment and other processes to meet the granulation requirements of biomass particles.

5. There are a number of innovative designs on the ring die, mainly to improve the problems of the ring die to prevent cracking, increase in output and increase in total output.

6. Configured with overload protection device to increase the service life of equipment.

7. Door is made by stainless steel material, durable use.

TECHNICAL DRAWING

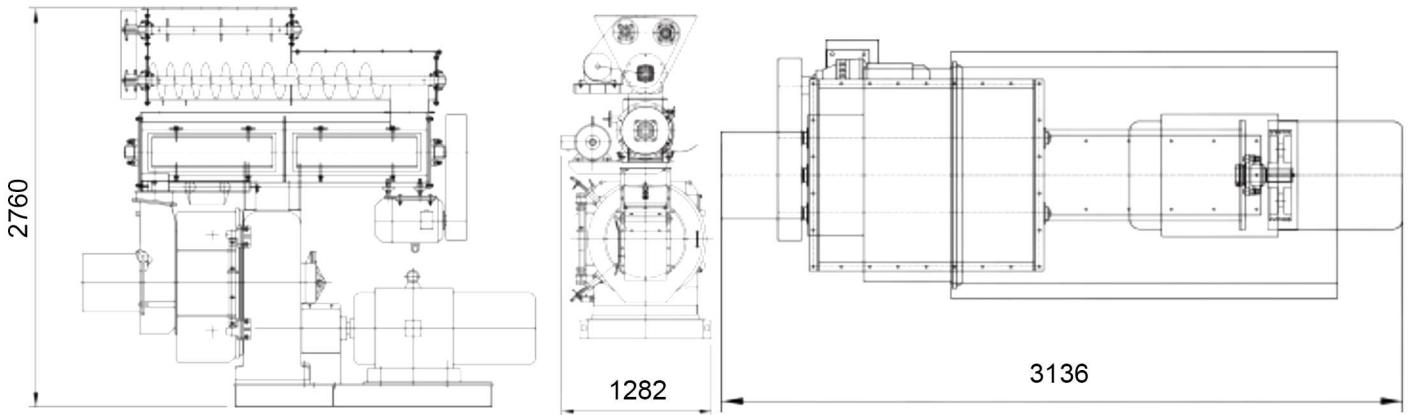

Detail Product :

- **Ring Die Material** : Stainless Steel
- **Feeder** : Anti-caking Function
- **Door of Pelleting Room** : 6mm / SUS304
- **Forced Feeding** : Worm Gear Reducer
- **Gear Box** : HT250
- **Gear** : 42CrMo
- **Gear Shaft** : 42CrMo
- **Spindle** : 42CrMo
- **Empty Shaft** : 42CrMo
- **Bearing** : SKF



Product Specification

Model	Capacity	Main Motor Power	Main Motor Series	Ring Die Diameter	Finished Pellet Diameter
OOFM320	1~2 t/h	22 Kw	6/8P	320 mm	6~12 mm
OOFM350	3~4 t/h	37 Kw	6/8P	350 mm	6~12 mm
OOFM420	5~6 t/h	90 Kw	6/8P	420 mm	6~12 mm
OOFM520	7~8 t/h	132 Kw	6/8P	520 mm	6~12 mm
OOFM768	9~10 t/h	250 Kw	6/8P	762 mm	6~12 mm
OOFM858	11~12 t/h	280 Kw	6/8P	858 mm	6~12 mm

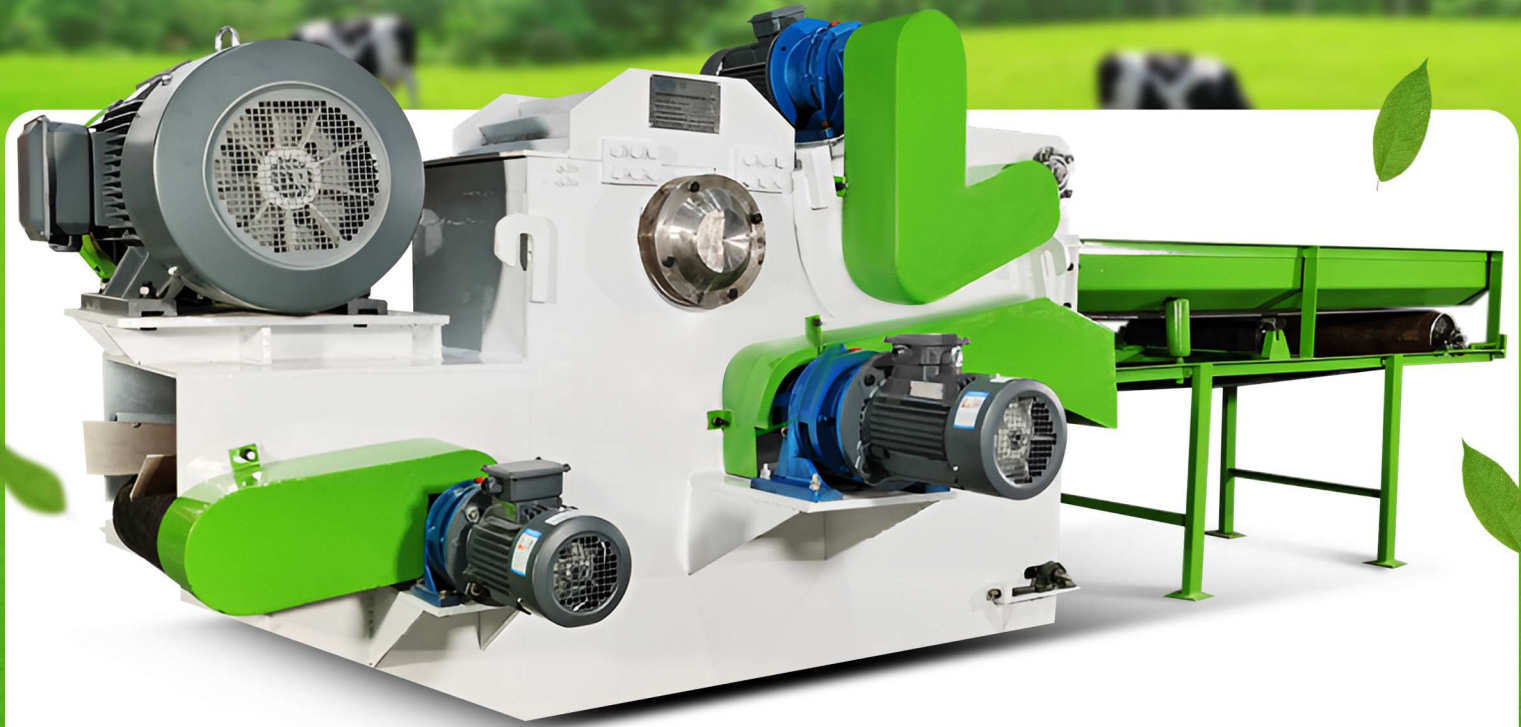

TYPE: ODC SERIES

BEST FOR FARM INDUSTRIES

DRUM CHIPPER

ORISON Drum Chipper is a kind of cutting large diameter wood, wood harvesting residues (twigs, branches, etc.) and wood processing residues (skin, slats, log core, waste veneer, etc.) into small Fragmented equipment. ORISON drum chipper has compact and reasonable structure, easy operation, high production capacity, wide adaptability of raw materials, high quality of cutting wood chips; safe and reliable, and easy maintenance.



**Advanced
Technology**



**High Quality
Components**



**Stable &
High Durability**



**High Precision
Gear Rotation**

1. The chipper is composed of machine base, knife roller, upper and lower feeding mechanism, feeding device, hydraulic buffer system and electrical control system.

2. The blade is made of special material with high strength and strong wear resistance.

3. The knife roller is processed as a whole, after dynamic balancing check, the accuracy is improved and the operation is stable.

4. The press system is automatically controlled by hydraulic system, and the feeding system is controlled by frequency conversion.

5. Patented knife roller structure, the cutting efficiency is increased by 30%-50%, and the main power is reduced by 30%-50%, the use cost is greatly reduced.

TECHNICAL DRAWING

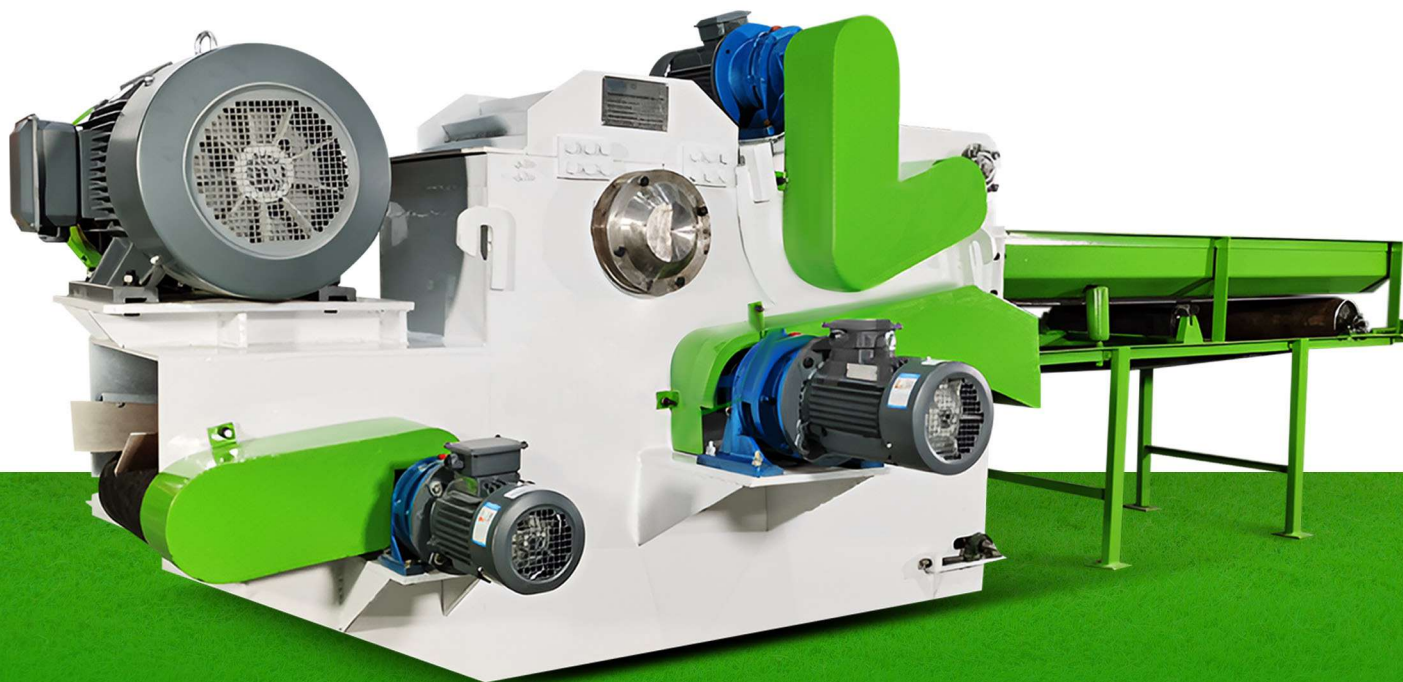
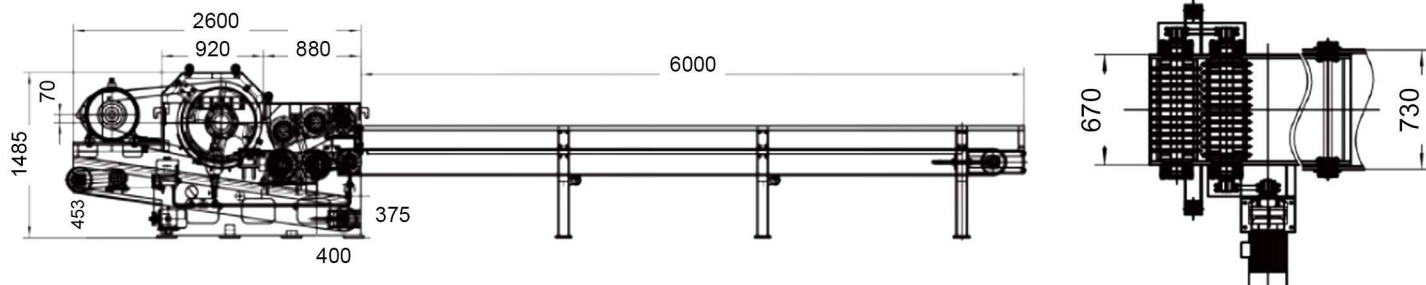

Product Specification

Model	Capacity	Dia. Of Knife Roll	Speed of Knife Roll	Size of Feed Inlet	Feeding Speed	Main Power
ODC215	3~5 t/h	730 mm	2 Rpm	400*160	38 m/min	45 Kw
ODC216	8~10 t/h	600 mm	2 Rpm	500*230	38 m/min	55 Kw
ODC218	14~18 t/h	650 mm	2 Rpm	680*300	38 m/min	75 Kw



BEST FOR FARM INDUSTRIES

TYPE: OHM-FB SERIES

ALFALFA/STRAW/HUSK GRASS HAMMER

ORISON Alfalfa/Straw/Husk/Grass Crusher which is equipped with force feeder. It is mainly suitable for crushing light materials such as straw, husk and alfalfa, etc.



LOW POWER CONSUMPTION



STABLE & HIGH DURABILITY

1. Specially design for light materials such as crushed grass, straw, shell, husk, etc.
2. With force feeder and the crushing chamber is large.
3. Siemens motor, SKF bearing.
4. The series is a fine-grade hammer mill with a screen hole of 2.0-6.0mm.
5. Hard paving material on the surface of the hammer head to extend the service life.
6. The motor and rotor are installed on the same heavy-duty base, driven by a belt, and the rotors are detected by a dynamic balancer.



TECHNICAL DRAWING

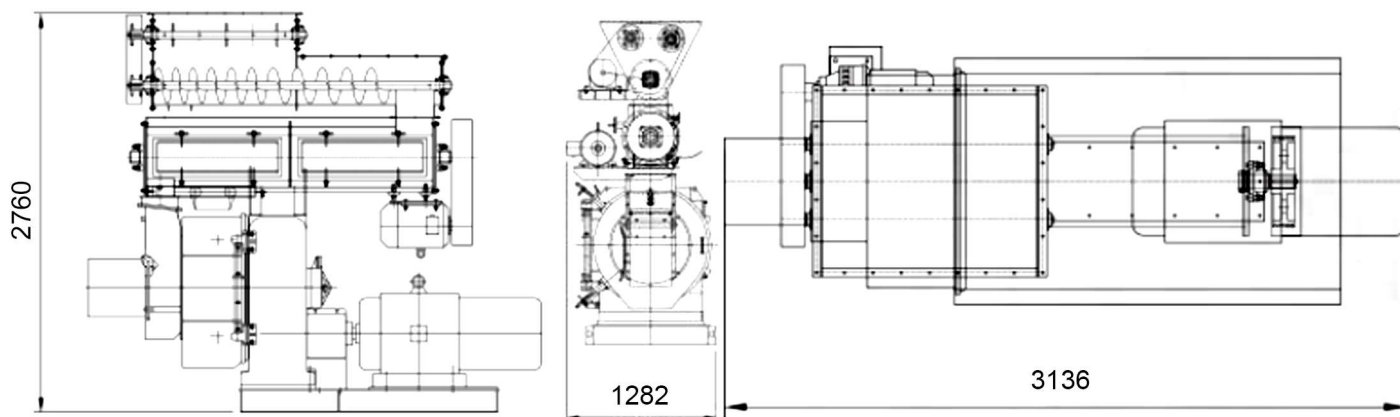

Detail Product :

- **Shell** : Stainless Steel
- **Hammer Plate** : 6mm /SUS304
- **Hammers** : 3mm /SUS304
- **Bearing** : HT250
- **Motor** : 42CrMo



Product Specification

Model	Power	Feeder Power	Speed of Crusher	Capacity
OHM56*40-FB	22 Kw	3 Kw	2900 Rpm	0.5~1 t/h
OHM56*60-FB	30/37 Kw	3 Kw	2900 Rpm	0.75~1.5 t/h
OHM56*80-FB	58 Kw	3 Kw	2900 Rpm	1~2 t/h
OHM56*100-FB	78 Kw	3 Kw	2900 Rpm	1.5~3 t/h
OHM56*120-FB	93 Kw	3 Kw	2900 Rpm	2~4 t/h



TYPE: ORDD SERIES

BEST FOR FARM INDUSTRIES

ROTARY DRUM DRYING MACHINE

ORISON Alfalfa/Straw/Husk/Grass Crusher which is equipped with force feeder. It is mainly suitable for crushing light materials such as straw, husk and alfalfa, etc.



LOW POWER CONSUMPTION



STABLE & HIGH DURABILITY

1. Wide range of application: suitable for the drying of fibrous, lump and agglomerated powdery biomass materials, such as wood chips, wood chips, wood sawdust, grass, etc.
2. Roller ring and retaining wheel support adopt cast steel integral structure, high strength, stable operation, strong wear resistance and long service life.
3. According to different materials, the feeding section adopts middle screw conveying feeding or top feeding, which is convenient for feeding.
4. The inlet and outlet ends of the tube sports are sealed with elastic and wear-resistant steel sheets, which have a long service life and are biased towards installation.
5. The special design of the lifting plate in the drum, the layout is reasonable, can make the material and hot air fully mixed, and the material residue is less, and the drying effect is good.



TECHNICAL DRAWING

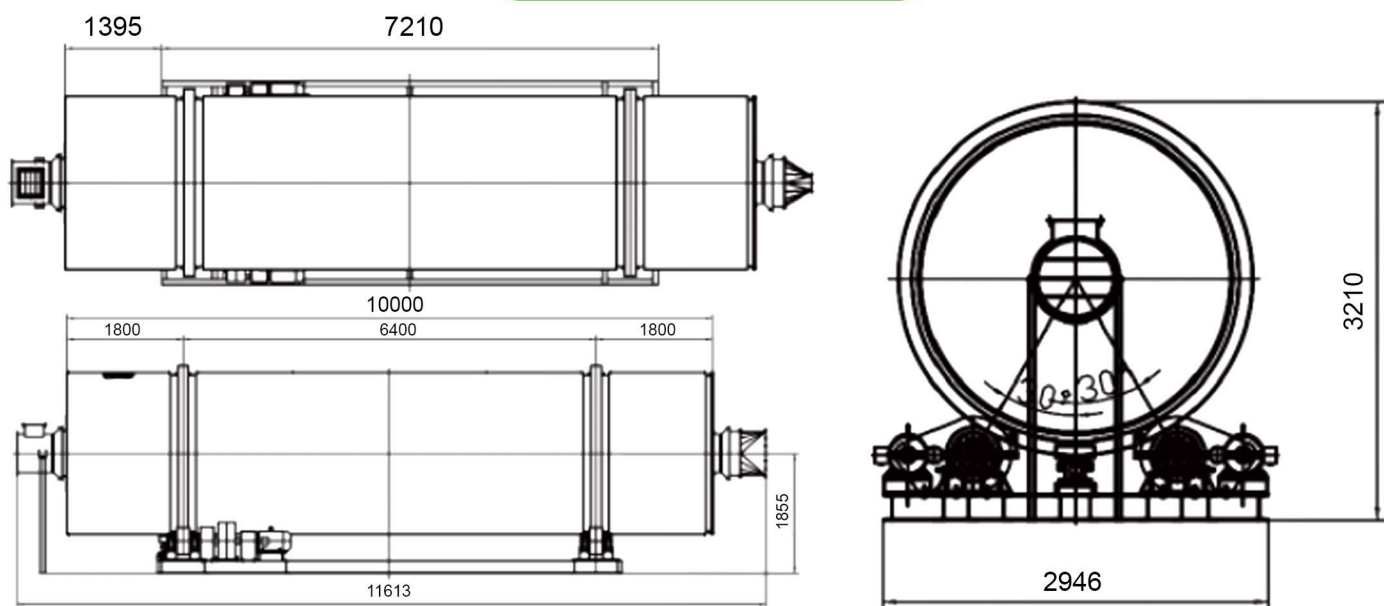

Product Specification

Model	Diameter	Length	Rotating Speed of Drum	Capacity	Inlet Air Temperature	Discharge Temperature
ORDD-600*6000	600 mm	6000 mm	3~8 Rpm	0.3~0.5 t/h	≤ 700 °C	80 °C
ORDD-800*8000	800 mm	8000 mm	3~8 Rpm	0.5~0.7 t/h	≤ 700 °C	80 °C
ORDD-1200*12000	1200 mm	12000 mm	3~8 Rpm	1.0~1.2 t/h	≤ 700 °C	80 °C
ORDD-1500*15000	1500 mm	15000 mm	3~8 Rpm	2.0~2.5 t/h	≤ 700 °C	80 °C
ORDD-1800*18000	1800 mm	18000 mm	3~8 Rpm	3.0~3.5 t/h	≤ 700 °C	80 °C
ORDD-2400*10000*3	2400 mm	10000 mm	3~8 Rpm	5 t/h	≤ 700 °C	80 °C

BIOMASS PELLETE TURN-KEY PROJECT

As a professional biomass machinery manufacturer, ORISON is committed to providing customers with turnkey project solutions for biomass pellet production project . Provide customers with professional and convenient turnkey engineering services from customer consultation, proposal design, equipment production, product testing, equipment delivery, civil installation, training guidance, technical services, etc.



3D or 2D design is available as customer's demand, Provide you with a more intuitive three-dimensional experience. Highly skilled engineers coupled with the application of the latest technology ensures product quality, efficiency, flexibility, compatibility and reliability.

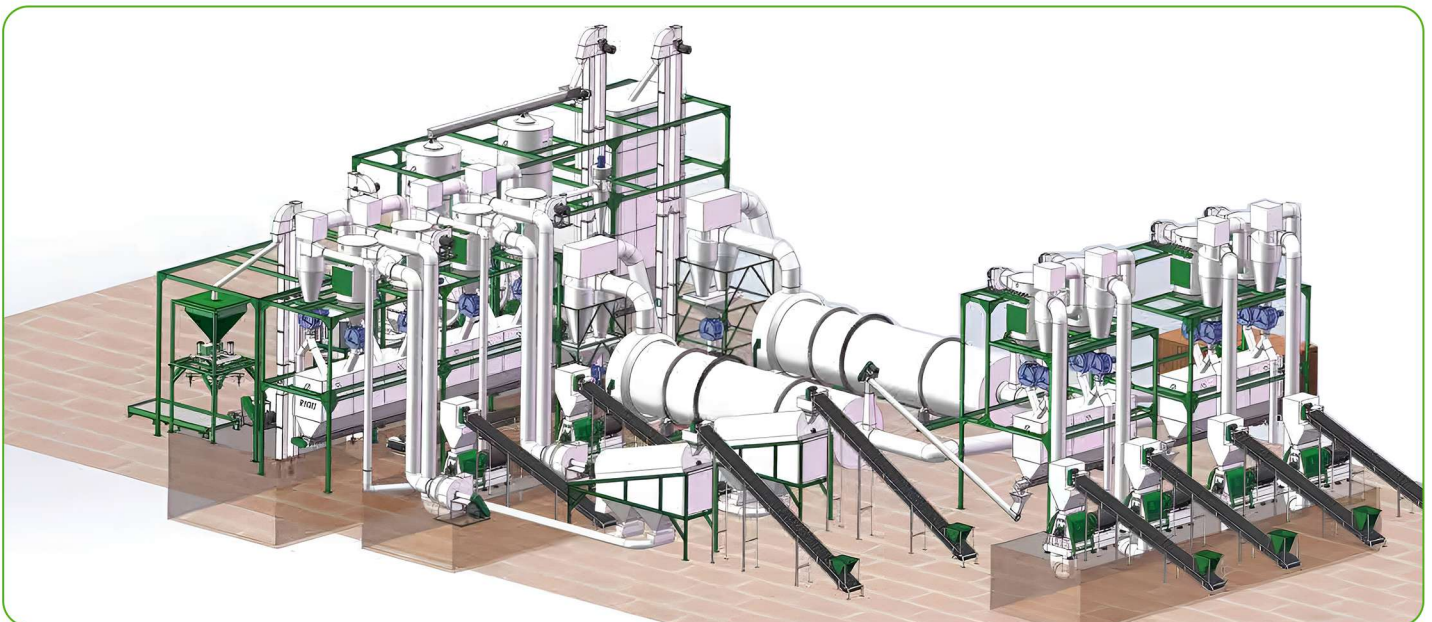

ORISON